

APPENDIX

Site Plan

Borehole Records

Trial Pit Records

Geotechnical Test Results

Contamination Test Results

Generic Risk-based Soil Screening Values

Envirocheck Extracts

Historical Maps

Preliminary UXO Risk Assessment



GEA

Geotechnical & Environmental Associates
www.gea-ltd.co.uk

Site Plan

Site 17 Acacia Road, London NW6 6AN

Client Mr Barry Townsley

Engineer Engineers HRW Ltd

Job Number
J19229

Sheet
1 / 1

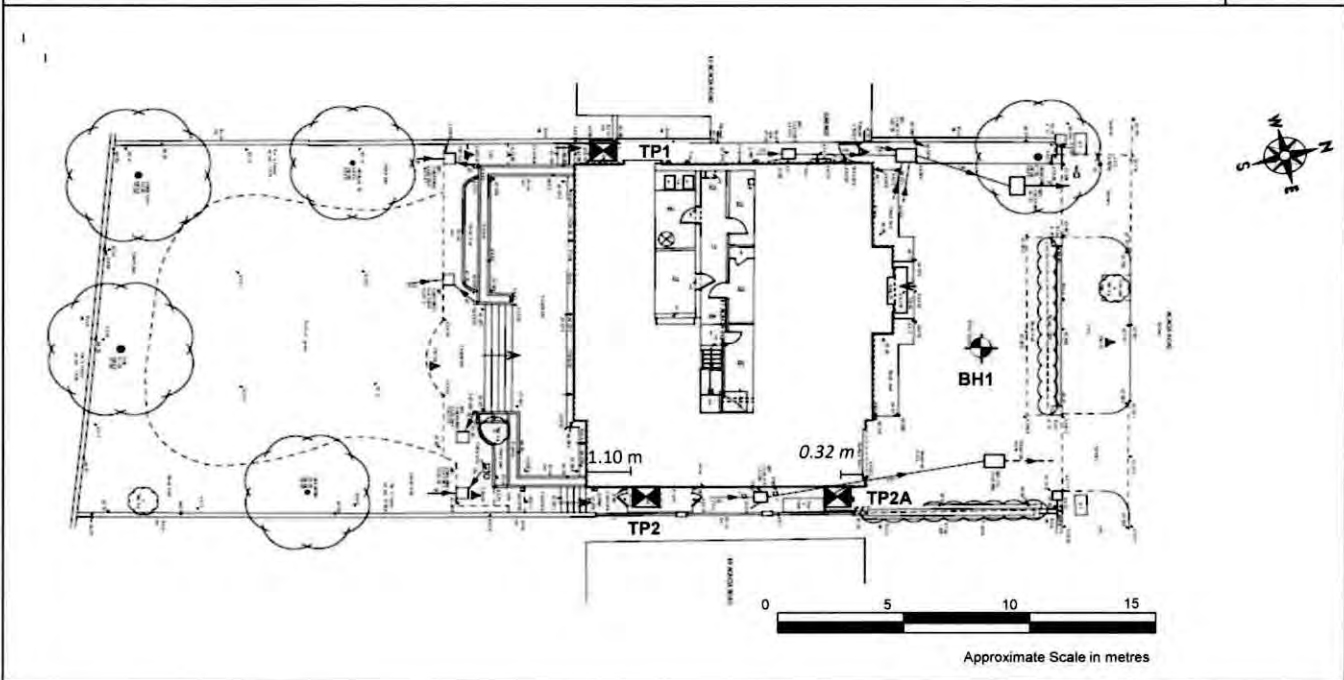



GEA

Geotechnical & Environmental Associates
Widbury Barn | Widbury Hill | Ware | SG12 7QE

Site

17 Acacia Road, London NW6 8LA

Number
BH1

Excavation Method

Opendrive percussive sampler

Dimensions

Ground Level (mOD)

43.90

Client

Mr Barry Townsley

Job Number

J19229

Location

Dates

09/09/2019

Engineer

Engineers HRW Ltd

Sheet

1/1

Depth (m)	Sample / Tests	Water Depth (m)	Field Records	Level (mOD)	Depth (Thickness) (m)	Description	Legend	Water
0.40	D1			43.60	(0.30) 0.30	Paving slab to 90 mm over sand subbase		
					(0.70)	MADE GROUND (dark reddish brown clayey silty sandy gravel with frequent clinker, flint gravel, occasional brick, concrete and rare roots and whole bricks)		
1.00-1.45	SPT N60=6		1,1/1,1,1,2	42.90	1.00 (0.30)	MADE GROUND (light orange-brown silty sandy gravelly clay with occasional brick, concrete, clinker, flint gravel and rare rootlets)		
				42.60	1.30			
1.50	D2					Soft becoming firm light orange-brown extremely mottled grey silty slightly sandy slightly gravelly CLAY with occasional fine to medium subrounded to subangular flint gravel, carbonaceous material and frequent fine lenses of silt. Sand is fine to medium.		
2.00-2.45	SPT N60=14		2,2/3,3,3,3					
2.00	D3				(2.40)			
2.50	D4							
3.00-3.45	SPT N60=22		3,3/4,4,5,6					
3.00	D5							
3.50	D6			40.20	3.70	Light yellow-brown silty sandy very gravelly CLAY. Gravel is fine to medium angular to rounded. Sand is fine to coarse. ... becoming more gravelly from 3.40 m to 3.70 m.		∇1
4.00-4.45	SPT N60=17		3,3/3,4,4,4	39.80	(0.40)	Firm light brown occasionally mottled grey silty CLAY with occasional carbonaceous material observed to 5.00 m		
4.00	D7							
4.50	D8		Water strike(1) at 3.70m.					
5.00-5.45	SPT N60=22		4,4/4,5,5,5					
5.00	D9							
5.50	D10							
6.00-6.45	SPT N60=26		4,4/5,6,6,6		(3.90)	... becoming light brown only		
6.00	D11					... silt pocket observed		
6.50	D12							
7.00-7.45	SPT N60=25		6,6/6,5,5,6					
7.00	D13							
7.50	D14							
8.00-8.45	SPT N60=29		5,5/6,6,7,7	35.90	8.00	Complete at 8.00m		
8.00	D15							

Remarks
 Inspection pit hand excavated to 1.20 m
 Groundwater monitoring standpipe installed to 6.00 m with a response zone from 1.00 m.
 Groundwater measured at depths of 1.20 m and 1.30 m on 27/09/2019 and 15/10/2019.

Scale (approx)	Logged By
1:50	LS
Figure No. J19229.BH1	



GEA

Widbury Barn
Widbury Hill
Ware
Herts SG12 7QE

Site 17 Acacia Road, London, NW8 6AN

Trial Pit Number
TP1

Excavation Method Manual	Dimensions 300 x 360 x 1400 mm	Ground Level (mOD) 41.87 mOD	Client Mr Barry Townsley	Job Number J19229
	Location As per attached plan	Date 09/09/2019	Engineer	Sheet Number 1 of 1

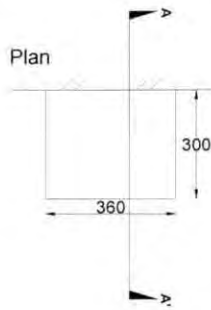

Section A - A'

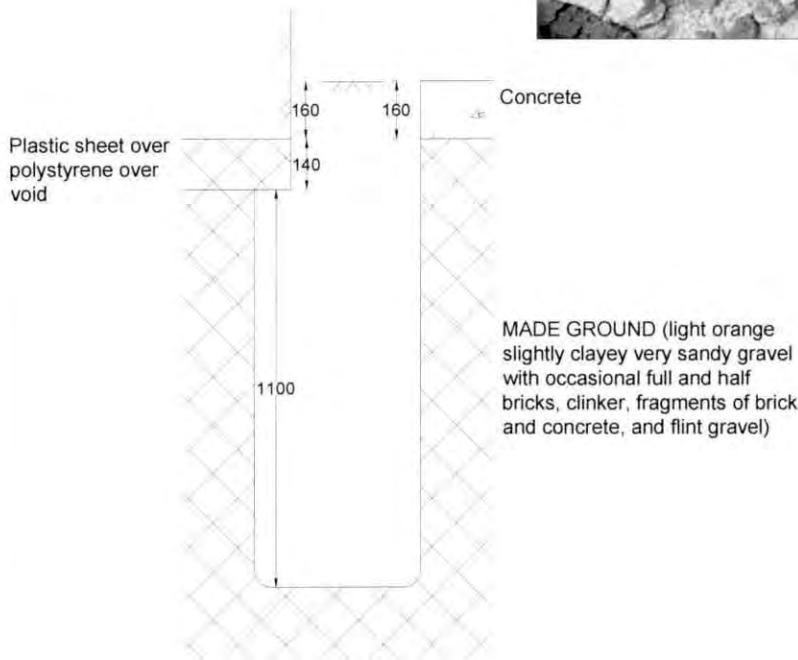

1 : 20

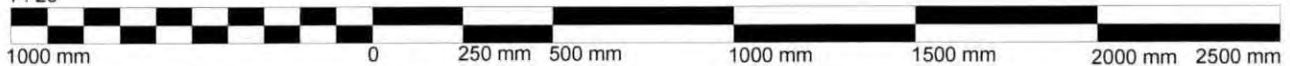

Notes:
All dimensions in millimetres
Groundwater not encountered; trial pit dry on completion

Scale
1 : 20

Logged By
LS

Excavation Method Manual	Dimensions 250 x 300 x 1600 mm	Ground Level (mOD) 44.08 mOD	Client Mr Barry Townsley	Trial Pit Number TP2
	Location As per attached plan	Date 09/09/2019	Engineer	Job Number J19229
				Sheet Number 1 of 1

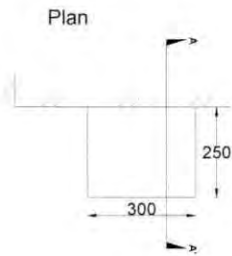

Section A - A'

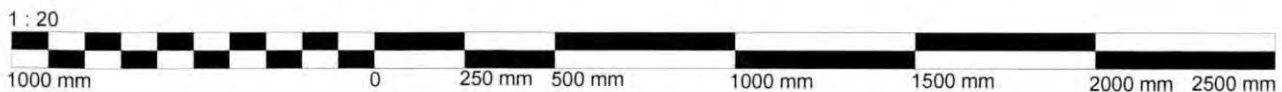
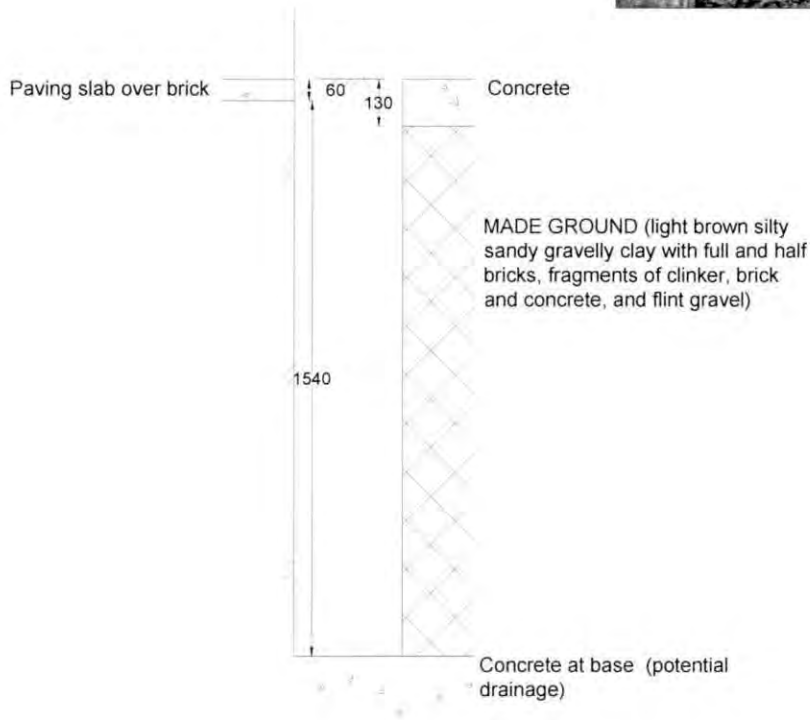

Notes:
All dimensions in millimetres
Groundwater not encountered; trial pit dry on completion
Trial pit terminated when suspected services encountered

Scale
1 : 20

Logged By
LS

Excavation Method Manual	Dimensions 300 x 310 x 240 mm	Ground Level (mOD) 44.01 mOD	Client Mr Barry Townsley	Trial Pit Number TP2A
	Location As per attached plan	Date 09/09/2019	Engineer	Job Number J19229
				Sheet Number 1 of 1

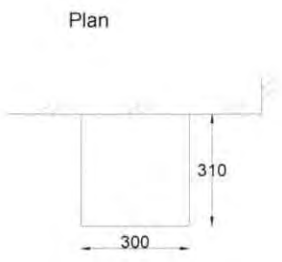

Section A - A'

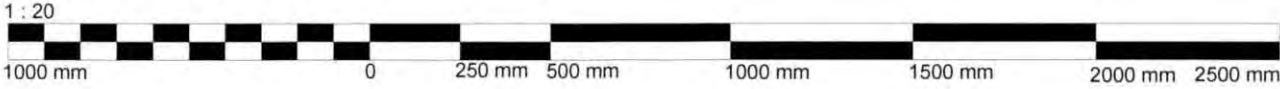
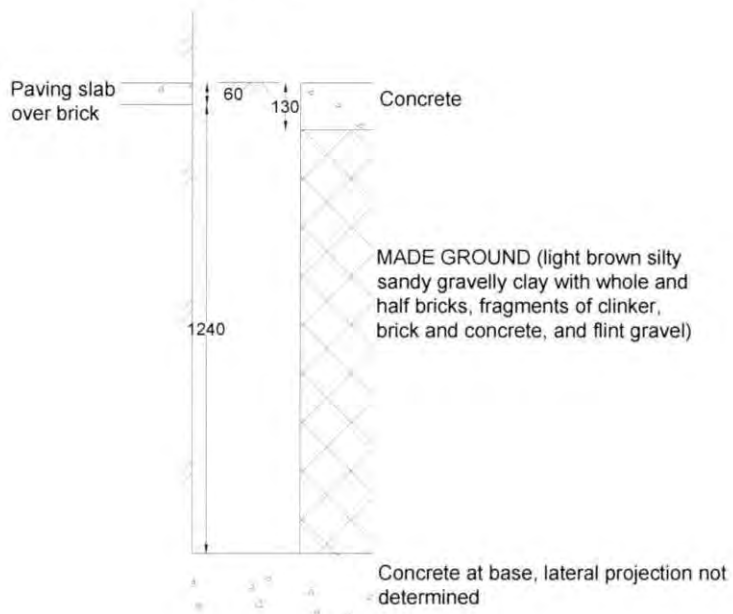



Notes: All dimensions in millimetres Groundwater not encountered; trial pit dry on completion Trial pit terminated when concrete encountered at the base of the pit	Scale 1 : 20
	Logged By LS

SUMMARY OF GEOTECHNICAL TESTING

Sample details					Classification Tests					Density Tests		Undrained Triaxial Compression			Chemical Tests			Other tests and comments	
Borehole / Trial Pit	Depth (m)	Sample Ref	Type	Description	WC (%)	LL (%)	PL (%)	PI (%)	<425 µm (%)	Bulk Mg/m³	Dry Mg/m³	Condition	Cell Pressure kPa	Deviator Stress kPa	Shear Stress kPa	pH	2:1 W/S SO4 (g/L)		W/S Mg (mg/L)
BH1	1.50		D	Brown and light grey slightly fine sandy silty CLAY with rare gravel	27.9	64	24	40	97								7.9	< 0.010	
BH1	2.00		D	Brown mottled light grey slightly fine sandy silty CLAY with dark brown pocket and rare fine to medium gravel	16.2	45	19	26	98								8.2	< 0.010	
BH1	3.00		D	Brown mottled light grey and dark brown slightly fine sandy silty CLAY with rare fine gravel	20.6	47	19	28	99										
BH1	3.50		D														8.0	< 0.010	
BH1	4.20		D	Brown mottled dark brown slightly fine sandy silty CLAY with rare fine gravel	27.3	80	29	51	99										
BH1	5.00		D	Brown mottled dark brown slightly fine sandy silty CLAY with rare fine to medium gravel	26.4	72	25	47	98										

Sample type: B (Bulk disturb.) BLK (Block) C (Core) D (Disturbed) LB (Large Bulk dist.) U (Undisturbed)

Checked and Approved by  S Burke - Senior Technician 30/09/2019	Project Number: Project Name:	GEO / 29929 ACACIA ROAD J19229	
--	--------------------------------------	---	---



Lina Seoudi
Geotechnical & Environmental Associates
Widbury Barn
Widbury Hill
Ware
Hertfordshire
SG127QE

i2 Analytical Ltd.
7 Woodshots Meadow,
Croxley Green
Business Park,
Watford,
Herts,
WD18 8YS

e: lina@gea-ltd.co.uk

t: 01923 225404
f: 01923 237404
e: reception@i2analytical.com

Analytical Report Number : 19-59557

Project / Site name:	Acacia Road	Samples received on:	12/09/2019
Your job number:	J19229	Samples instructed on:	13/09/2019
Your order number:	J19229	Analysis completed by:	20/09/2019
Report Issue Number:	1	Report issued on:	20/09/2019
Samples Analysed:	3 soil samples		

Signed: Karolina Marek

Karolina Marek
Technical Reviewer (Reporting Team)
For & on behalf of i2 Analytical Ltd.

Standard Geotechnical, Asbestos and Chemical Testing Laboratory located at: ul. Pionierów 39, 41 -711 Ruda Śląska, Poland.

Accredited tests are defined within the report, opinions and interpretations expressed herein are outside the scope of accreditation.

Standard sample disposal times, unless otherwise agreed with the laboratory, are :

soils	- 4 weeks from reporting
leachates	- 2 weeks from reporting
waters	- 2 weeks from reporting
asbestos	- 6 months from reporting

Excel copies of reports are only valid when accompanied by this PDF certificate.

Any assessments of compliance with specifications are based on actual analytical results with no contribution from uncertainty of measurement. Application of uncertainty of measurement would provide a range within which the true result lies. An estimate of measurement uncertainty can be provided on request.

Iss No 19-59557-1 Acacia Road J19229

This certificate should not be reproduced, except in full, without the express permission of the laboratory.
The results included within the report are representative of the samples submitted for analysis.

Page 1 of 6



4041



Environmental Science

Analytical Report Number: 19-59557

Project / Site name: Acacia Road

Your Order No: J19229

Lab Sample Number	1315714			1315715			1315716		
Sample Reference	TP2A			TP1			BH1		
Sample Number	None Supplied			None Supplied			None Supplied		
Depth (m)	1.00			0.30			0.40		
Date Sampled	09/09/2019			09/09/2019			09/09/2019		
Time Taken	None Supplied			None Supplied			None Supplied		
Analytical Parameter (Soil Analysis)	Units	Limit of detection	Accreditation Status						
Stone Content	%	0.1	NONE	< 0.1	< 0.1	< 0.1			
Moisture Content	%	N/A	NONE	15	12	11			
Total mass of sample received	kg	0.001	NONE	1.3	1.2	1.1			

Asbestos in Soil	Type	N/A	ISO 17025	Not-detected	Not-detected	Not-detected

General Inorganics

pH - Automated	pH Units	N/A	MCERTS	7.8	11.1	9.2
Total Cyanide	mg/kg	1	MCERTS	< 1	< 1	< 1
Total Sulphate as SO ₄	mg/kg	50	MCERTS	1400	1700	650
Water Soluble SO ₄ 16hr extraction (2:1 Leachate Equivalent)	g/l	0.00125	MCERTS	0.25	0.098	0.056
Sulphide	mg/kg	1	MCERTS	< 1.0	< 1.0	4.7
Water Soluble Chloride (2:1)	mg/kg	1	MCERTS	15	36	14
Total Organic Carbon (TOC)	%	0.1	MCERTS	0.6	0.3	1.4

Total Phenols

Total Phenols (monohydric)	mg/kg	1	MCERTS	< 1.0	< 1.0	< 1.0

Speciated PAHs

Naphthalene	mg/kg	0.05	MCERTS	< 0.05	< 0.05	0.25
Acenaphthylene	mg/kg	0.05	MCERTS	< 0.05	< 0.05	< 0.05
Acenaphthene	mg/kg	0.05	MCERTS	< 0.05	< 0.05	0.86
Fluorene	mg/kg	0.05	MCERTS	< 0.05	< 0.05	0.85
Phenanthrene	mg/kg	0.05	MCERTS	0.55	0.36	7.6
Anthracene	mg/kg	0.05	MCERTS	< 0.05	< 0.05	2.3
Fluoranthene	mg/kg	0.05	MCERTS	0.51	0.64	11
Pyrene	mg/kg	0.05	MCERTS	0.41	0.57	9.2
Benzo(a)anthracene	mg/kg	0.05	MCERTS	< 0.05	0.32	4.1
Chrysene	mg/kg	0.05	MCERTS	< 0.05	0.31	3.8
Benzo(b)fluoranthene	mg/kg	0.05	MCERTS	< 0.05	0.27	4.4
Benzo(k)fluoranthene	mg/kg	0.05	MCERTS	< 0.05	0.20	1.7
Benzo(a)pyrene	mg/kg	0.05	MCERTS	< 0.05	0.26	3.8
Indeno(1,2,3-cd)pyrene	mg/kg	0.05	MCERTS	< 0.05	< 0.05	1.9
Dibenz(a,h)anthracene	mg/kg	0.05	MCERTS	< 0.05	< 0.05	0.53
Benzo(ghi)perylene	mg/kg	0.05	MCERTS	< 0.05	< 0.05	2.4

Total PAH

Speciated Total EPA-16 PAHs	mg/kg	0.8	MCERTS	1.47	2.93	54.2

Heavy Metals / Metalloids

Arsenic (aqua regia extractable)	mg/kg	1	MCERTS	12	11	6.3
Cadmium (aqua regia extractable)	mg/kg	0.2	MCERTS	< 0.2	< 0.2	< 0.2
Chromium (hexavalent)	mg/kg	4	MCERTS	< 4.0	< 4.0	< 4.0
Chromium (aqua regia extractable)	mg/kg	1	MCERTS	30	24	19
Copper (aqua regia extractable)	mg/kg	1	MCERTS	32	19	29
Lead (aqua regia extractable)	mg/kg	1	MCERTS	840	220	140
Mercury (aqua regia extractable)	mg/kg	0.3	MCERTS	< 0.3	< 0.3	< 0.3
Nickel (aqua regia extractable)	mg/kg	1	MCERTS	20	16	13
Selenium (aqua regia extractable)	mg/kg	1	MCERTS	< 1.0	< 1.0	< 1.0
Zinc (aqua regia extractable)	mg/kg	1	MCERTS	92	83	47

Iss No 19-59557-1 Acacia Road J19229

This certificate should not be reproduced, except in full, without the express permission of the laboratory. The results included within the report are representative of the samples submitted for analysis.



4041



Environmental Science

Analytical Report Number: 19-59557

Project / Site name: Acacia Road

Your Order No: J19229

Lab Sample Number	1315714			1315715			1315716		
Sample Reference	TP2A			TP1			BH1		
Sample Number	None Supplied			None Supplied			None Supplied		
Depth (m)	1.00			0.30			0.40		
Date Sampled	09/09/2019			09/09/2019			09/09/2019		
Time Taken	None Supplied			None Supplied			None Supplied		
Analytical Parameter (Soil Analysis)	Units	Limit of detection	Accreditation Status						

Petroleum Hydrocarbons

TPH C10 - C40	mg/kg	10	MCERTS	< 10	< 10	350		
TPH (C8 - C10)	mg/kg	0.1	MCERTS	< 0.1	< 0.1	< 0.1		
TPH (C10 - C12)	mg/kg	2	MCERTS	< 2.0	< 2.0	< 2.0		
TPH (C12 - C16)	mg/kg	4	MCERTS	< 4.0	< 4.0	21		
TPH (C16 - C21)	mg/kg	1	MCERTS	< 1.0	< 1.0	110		
TPH (C21 - C35)	mg/kg	1	MCERTS	< 1.0	< 1.0	170		

Iss No 19-59557-1 Acacia Road J19229

This certificate should not be reproduced, except in full, without the express permission of the laboratory.
The results included within the report are representative of the samples submitted for analysis.



4041



Environmental Science

Analytical Report Number : 19-59557

Project / Site name: Acacia Road

* These descriptions are only intended to act as a cross check if sample identities are questioned. The major constituent of the sample is intended to act with respect to MCERTS validation. The laboratory is accredited for sand, clay and loam (MCERTS) soil types. Data for unaccredited types of solid should be interpreted with care.

Stone content of a sample is calculated as the % weight of the stones not passing a 10 mm sieve. Results are not corrected for stone content.

Lab Sample Number	Sample Reference	Sample Number	Depth (m)	Sample Description *
1315714	TP2A	None Supplied	1.00	Brown clay and loam with gravel.
1315715	TP1	None Supplied	0.30	Brown sandy loam with gravel.
1315716	BH1	None Supplied	0.40	Brown loam and sand with gravel.

Iss No 19-59557-1 Acacia Road J19229

This certificate should not be reproduced, except in full, without the express permission of the laboratory. The results included within the report are representative of the samples submitted for analysis.



4041



Environmental Science

Analytical Report Number : 19-59557

Project / Site name: Acacia Road

Water matrix abbreviations: Surface Water (SW) Potable Water (PW) Ground Water (GW) Process Water (PrW)

Analytical Test Name	Analytical Method Description	Analytical Method Reference	Method number	Wet / Dry Analysis	Accreditation Status
Asbestos identification in soil	Asbestos Identification with the use of polarised light microscopy in conjunction with dispersion staining techniques.	In house method based on HSG 248	A001-PL	D	ISO 17025
Chloride, water soluble, in soil	Determination of Chloride colorimetrically by discrete analyser.	In-house method based on BS1377 Part 3, 1990, Chemical and Electrochemical Tests. 2:1 extraction.	L082-PL	D	MCERTS
D.O. for Gravimetric Quant if Screen/ID positive	Dependent option for Gravimetric Quant if Screen/ID positive scheduled.	In house asbestos methods A001 & A006.	A006-PL	D	NONE
hexavalent chromium in soil	Determination of hexavalent chromium in soil by extraction in water then by acidification, addition of 1,5 diphenylcarbazide followed by colorimetry.	In-house method	L080-PL	W	MCERTS
Metals in soil by ICP-OES	Determination of metals in soil by aqua-regia digestion followed by ICP-OES.	In-house method based on MEWAM 2006 Methods for the Determination of Metals in Soil.	L038-PL	D	MCERTS
Moisture Content	Moisture content, determined gravimetrically.	In-house method based on BS1377 Part 2, 1990, Chemical and Electrochemical Tests	L019-UK/PL	W	NONE
Monohydric phenols in soil	Determination of phenols in soil by extraction with sodium hydroxide followed by distillation followed by colorimetry.	In-house method based on Examination of Water and Wastewater 20th Edition: Clesceri, Greenberg & Eaton (skalar)	L080-PL	W	MCERTS
pH in soil (automated)	Determination of pH in soil by addition of water followed by automated electrometric measurement.	In-house method based on BS1377 Part 3, 1990, Chemical and Electrochemical Tests	L099-PL	D	MCERTS
Speciated EPA-16 PAHs in soil	Determination of PAH compounds in soil by extraction in dichloromethane and hexane followed by GC-MS with the use of surrogate and internal standards.	In-house method based on USEPA 8270	L064-PL	D	MCERTS
Stones content of soil	Standard preparation for all samples unless otherwise detailed. Gravimetric determination of stone > 10 mm as % dry weight.	In-house method based on British Standard Methods and MCERTS requirements.	L019-UK/PL	D	NONE
Sulphate, water soluble, in soil (16hr extraction)	Determination of water soluble sulphate by ICP-OES. Results reported directly (leachate equivalent) and corrected for extraction ratio (soil equivalent).	In-house method based on BS1377 Part 3, 1990, Chemical and Electrochemical Tests, 2:1 water:soil extraction, analysis by ICP-OES.	L038-PL	D	MCERTS
Sulphide in soil	Determination of sulphide in soil by acidification and heating to liberate hydrogen sulphide, trapped in an alkaline solution then assayed by ion selective electrode.	In-house method	L010-PL	D	MCERTS
Total cyanide in soil	Determination of total cyanide by distillation followed by colorimetry.	In-house method based on Examination of Water and Wastewater 20th Edition: Clesceri, Greenberg & Eaton (Skalar)	L080-PL	W	MCERTS
Total organic carbon (Automated) in soil	Determination of organic matter in soil by oxidising with potassium dichromate followed by titration with iron (II) sulphate.	In-house method based on BS1377 Part 3, 1990, Chemical and Electrochemical Tests"	L009-PL	D	MCERTS
Total sulphate (as SO4 in soil)	Determination of total sulphate in soil by extraction with 10% HCl followed by ICP-OES.	In-house method based on BS1377 Part 3, 1990, Chemical and Electrochemical Tests	L038-PL	D	MCERTS
TPH Banding in Soil by FID	Determination of hexane extractable hydrocarbons in soil by GC-FID.	In-house method, TPH with carbon banding and silica gel split/cleanup.	L076-PL	W	MCERTS
TPH in (Soil)	Determination of TPH bands by HS-GC-MS/GC-FID	In-house method, TPH with carbon banding and silica gel split/cleanup.	L076-PL	D	MCERTS

Iss No 19-59557-1 Acacia Road J19229

This certificate should not be reproduced, except in full, without the express permission of the laboratory.

The results included within the report are representative of the samples submitted for analysis.

Page 5 of 6



4041



Environmental Science

Analytical Report Number : 19-59557

Project / Site name: Acacia Road

Water matrix abbreviations: Surface Water (SW) Potable Water (PW) Ground Water (GW) Process Water (PrW)

Analytical Test Name	Analytical Method Description	Analytical Method Reference	Method number	Wet / Dry Analysis	Accreditation Status
----------------------	-------------------------------	-----------------------------	---------------	--------------------	----------------------

For method numbers ending in 'UK' analysis have been carried out in our laboratory in the United Kingdom.

For method numbers ending in 'PL' analysis have been carried out in our laboratory in Poland.

Soil analytical results are expressed on a dry weight basis. Where analysis is carried out on as-received the results obtained are multiplied by a moisture correction factor that is determined gravimetrically using the moisture content which is carried out at a maximum of 30oC.



GEA

Widbury Barn
Widbury Hill
Ware
SG12 7QE

Generic Risk-Based Soil Screening Values

Site	17 Acacia Road, London NW8 6AN	Job Number	J19229
Client	Mr Barry Townsley	Sheet	1 / 2
Engineer	Engineers HRW		

Proposed End Use Residential with plant uptake

Soil Organic Matter content % 2.5

Contaminant	Screening Value mg/kg	Data Source
Metals		
Arsenic	37	C4SL
Cadmium	22	C4SL
Chromium (III)	910	S4UL
Chromium (VI)	21	C4SL
Copper	2,400	S4UL
Lead	200	C4SL
Elemental Mercury	1.2	S4UL
Inorganic Mercury	40	S4UL
Nickel	130	S4UL
Selenium	350	SGV
Zinc	3,700	S4UL
Anions		
Soluble Sulphate	500 mg/l	Structures
Sulphide	50	Structures
Chloride	400	Structures
Others		
Organic Carbon (%)	6	Methanogenic potential
Total Cyanide	140	WRAS
Total Mono Phenols	290	SGV
PAH		
Naphthalene	5.60	S4UL
Acenaphthylene	420	S4UL
Acenaphthene	510	S4UL
Fluorene	400	S4UL
Phenanthrene	220	S4UL
Anthracene	5,400	S4UL
Fluoranthene	560	S4UL
Pyrene	1,200	S4UL
Benzo(a)anthracene	11.0	S4UL
Chrysene	22	S4UL
Benzo(b)fluoranthene	3.3	S4UL
Benzo(k)fluoranthene	93.0	S4UL
Benzo(a)pyrene	4.40	C4SL
Indeno(1 2 3 cd)pyrene	36.0	S4UL
Dibenz(a h)anthracene	0.28	S4UL
Benzo (g h i)perylene	340	S4UL
Total PAH Screen	62.9	B(a)P / 0.15

Contaminant	Screening Value mg/kg	Data Source
Hydrocarbons		
Banded TPH (8-10)	128	Calc1
Banded TPH (10-12)	277	Calc1
Banded TPH (12-16)	508	Calc1
Banded TPH (16-21)	831	Calc1
Banded TPH (21-35)	2308	Calc1
Benzene	0.34	C4SL
Toluene	320	SGV
Ethyl Benzene	180	SGV
Xylene	120	SGV
Aliphatic C5-C6	78	S4UL
Aliphatic C6-C8	230	S4UL
Aliphatic C8-C10	65	S4UL
Aliphatic C10-C12	330	S4UL
Aliphatic C12-C16	2400	S4UL
Aliphatic C16-C35	92,000	S4UL
Aromatic C6-C7	See Benzene	S4UL
Aromatic C7-C8	See Toluene	S4UL
Aromatic C8-C10	83	S4UL
Aromatic C10-C12	180	S4UL
Aromatic C12-C16	330	S4UL
Aromatic C16-C21	540	S4UL
Aromatic C21-C35	1500	S4UL
PRO (C ₅ -C ₁₀)	776	Calc2
DRO (C ₁₂ -C ₂₈)	95,270	Calc2
Lube Oil (C ₂₈ -C ₄₄)	93,500	Calc2
TPH	750	Trigger to consider speciated testing
Chlorinated Solvents		
1,1,1 trichloroethane (TCA)	18	S4UL
tetrachloroethane (PCA)	2.8	S4UL
tetrachloroethene (PCE)	0.39	S4UL
trichloroethene (TCE)	0.034	S4UL
1,2-dichloroethane (DCA)	0.011	S4UL
vinyl chloride (Chloroethene)	0.00087	S4UL
tetrachloromethane (Carbon tetra)	0.056	S4UL
trichloromethane (Chloroform)	1.7	S4UL

Notes

Concentrations measured below these screening values may be considered to represent 'uncontaminated conditions' which pose a 'LOW' risk to human health. Concentrations measured in excess of these values indicate a potential risk which require further, site specific risk assessment.

C4SL - Defra Category 4 Screening value based on Low Level of Toxicological Risk

SGV - Soil Guideline Value, derived from the CLEA model and published by Environment Agency 2009 - where not superseded by C4SL

S4UL - LQM/CIEH Suitable for use Level (2015) based on 'minimal' level of risk

Calc1 - sum of thresholds for Ali & Aro fractions - assuming a 35% Aro:65% Ali ratio as is commonly encountered in the soil

Calc2 - sum of nearest available carbon range specified including BTEX for PRO fraction

Total PAH based on B(a)P / 0.15 - GEA experience indicates that Benzo(a) pyrene rarely exceeds 15% of the total PAH concentration

Envirocheck[®] Report: Datasheet

Order Details:

Order Number:

215248178_1_1

Customer Reference:

J19229

National Grid Reference:

527010, 183500

Slice:

A

Site Area (Ha):

0.1

Search Buffer (m):

1000

Site Details:

17, Acacia Road

LONDON

NW8 6AN

Client Details:

Mr S Branch

GEA Ltd

Widbury Barn

Widbury Hill

Ware

Herts

SG12 7QE



Report Section	Page Number
Summary	-
Agency & Hydrological	1
Waste	16
Hazardous Substances	-
Geological	17
Industrial Land Use	21
Sensitive Land Use	51
Data Currency	52
Data Suppliers	60
Useful Contacts	61

Introduction

The Environment Act 1995 has made site sensitivity a key issue, as the legislation pays as much attention to the pathways by which contamination could spread, and to the vulnerable targets of contamination, as it does the potential sources of contamination. For this reason, Landmark's Site Sensitivity maps and Datasheet(s) place great emphasis on statutory data provided by the Environment Agency/Natural Resources Wales and the Scottish Environment Protection Agency; it also incorporates data from Natural England (and the Scottish and Welsh equivalents) and Local Authorities; and highlights hydrogeological features required by environmental and geotechnical consultants. It does not include any information concerning past uses of land. The datasheet is produced by querying the Landmark database to a distance defined by the client from a site boundary provided by the client. In this datasheet the National Grid References (NGRs) are rounded to the nearest 10m in accordance with Landmark's agreements with a number of Data Suppliers.

Copyright Notice

© Landmark Information Group Limited 2019. The Copyright on the information and data and its format as contained in this Envirocheck® Report ("Report") is the property of Landmark Information Group Limited ("Landmark") and several other Data Providers, including (but not limited to) Ordnance Survey, British Geological Survey, the Environment Agency/Natural Resources Wales and Natural England, and must not be reproduced in whole or in part by photocopying or any other method. The Report is supplied under Landmark's Terms and Conditions accepted by the Customer.

A copy of Landmark's Terms and Conditions can be found with the Index Map for this report. Additional copies of the Report may be obtained from Landmark, subject to Landmark's charges in force from time to time. The Copyright, design rights and any other intellectual rights shall remain the exclusive property of Landmark and /or other Data providers, whose Copyright material has been included in this Report.

© Environment Agency & United Kingdom Research and Innovation 2019. © Natural Resources Wales & United Kingdom Research and Innovation 2019.

Natural England Copyright Notice

Site of Special Scientific Interest, National Nature Reserve, Ramsar, Special Protection Area, Special Conservation Area, Marine Nature Reserve data (derived from Ordnance Survey 1:10000 raster) is provided by, and used with the permission of, Natural England who retain the copyright and Intellectual Property Rights for the data.

Scottish Natural Heritage Copyright

Contains SNH information licensed under the Open Government Licence v3.0.

Ove Arup Copyright Notice

The Mining Instability data was obtained on licence from Ove Arup & Partners Limited (for further information, contact mining.review@arup.com). No reproduction or further use of such Data is to be made without the prior written consent of Ove Arup & Partners Limited. The supplied Mining Instability data is derived from publicly available records and other third party sources and neither Ove Arup & Partners nor Landmark warrant the accuracy or completeness of such information or data.

Peter Brett Associates Copyright Notice

The cavity data presented has been extracted from the PBA enhanced version of the original DEFRA national cavity databases. PBA/DEFRA retain the copyright & intellectual property rights in the data. Whilst all reasonable efforts are made to check that the information contained in the cavity databases is accurate we do not warrant that the data is complete or error free. The information is based upon our own researches and those collated from a number of external sources and is continually being augmented and updated by PBA. In no event shall PBA/DEFRA or Landmark be liable for any loss or damage including, without limitation, indirect or consequential loss or damage arising from the use of this data.

Radon Potential dataset Copyright Notice

Information supplied from a joint dataset compiled by The British Geological Survey and Public Health England.

Natural Resources Wales Copyright Notice

Contains Natural Resources Wales information © Natural Resources Wales and Database Right. All rights Reserved. Contains Ordnance Survey Data. Ordnance Survey Licence number 100019741, Crown Copyright and Database Right. Contains Natural Resources Wales information © Natural Resources Wales and Database Right. All rights Reserved. Some features of this information are based on digital spatial data licensed from the Centre for Ecology & Hydrology © NERC (CEH), Defra, Met Office and DARD Rivers Agency © Crown copyright. © Cranfield University. © James Hutton Institute. Contains OS data © Crown copyright and database right 2019. Land & Property Services © Crown copyright and database right.

Report Version v53.0

Data Type	Page Number	On Site	0 to 250m	251 to 500m	501 to 1000m (*up to 2000m)
Agency & Hydrological					
BGS Groundwater Flooding Susceptibility					n/a
Contaminated Land Register Entries and Notices					
Discharge Consents	pg 1				3
Prosecutions Relating to Controlled Waters			n/a	n/a	n/a
Enforcement and Prohibition Notices					
Integrated Pollution Controls					
Integrated Pollution Prevention And Control					
Local Authority Integrated Pollution Prevention And Control					
Local Authority Pollution Prevention and Controls	pg 1		1	6	11
Local Authority Pollution Prevention and Control Enforcements					
Nearest Surface Water Feature	pg 4			Yes	
Pollution Incidents to Controlled Waters	pg 4			2	4
Prosecutions Relating to Authorised Processes					
Registered Radioactive Substances	pg 5			6	7
River Quality	pg 7			1	
River Quality Biology Sampling Points					
River Quality Chemistry Sampling Points					
Substantiated Pollution Incident Register					
Water Abstractions	pg 7				11 (*14)
Water Industry Act Referrals					
Groundwater Vulnerability Map	pg 14	Yes	n/a	n/a	n/a
Groundwater Vulnerability - Soluble Rock Risk			n/a	n/a	n/a
Groundwater Vulnerability - Local Information			n/a	n/a	n/a
Bedrock Aquifer Designations	pg 14	Yes	n/a	n/a	n/a
Superficial Aquifer Designations			n/a	n/a	n/a
Source Protection Zones	pg 14		1	1	
Extreme Flooding from Rivers or Sea without Defences				n/a	n/a
Flooding from Rivers or Sea without Defences				n/a	n/a
Areas Benefiting from Flood Defences				n/a	n/a
Flood Water Storage Areas				n/a	n/a
Flood Defences				n/a	n/a
OS Water Network Lines	pg 14		1	1	7

Data Type	Page Number	On Site	0 to 250m	251 to 500m	501 to 1000m (*up to 2000m)
Waste					
BGS Recorded Landfill Sites					
Historical Landfill Sites					
Integrated Pollution Control Registered Waste Sites					
Licensed Waste Management Facilities (Landfill Boundaries)					
Licensed Waste Management Facilities (Locations)	pg 16				1
Local Authority Landfill Coverage	pg 16	1	n/a	n/a	n/a
Local Authority Recorded Landfill Sites					
Potentially Infilled Land (Non-Water)	pg 16				1
Potentially Infilled Land (Water)					
Registered Landfill Sites					
Registered Waste Transfer Sites					
Registered Waste Treatment or Disposal Sites					
Hazardous Substances					
Control of Major Accident Hazards Sites (COMAH)					
Explosive Sites					
Notification of Installations Handling Hazardous Substances (NIHHS)					
Planning Hazardous Substance Consents					
Planning Hazardous Substance Enforcements					

Data Type	Page Number	On Site	0 to 250m	251 to 500m	501 to 1000m (*up to 2000m)
Geological					
BGS 1:625,000 Solid Geology	pg 17	Yes	n/a	n/a	n/a
BGS Estimated Soil Chemistry					
BGS Recorded Mineral Sites					
BGS Urban Soil Chemistry	pg 17			Yes	Yes
BGS Urban Soil Chemistry Averages	pg 19	Yes			
CBSCB Compensation District			n/a	n/a	n/a
Coal Mining Affected Areas			n/a	n/a	n/a
Mining Instability			n/a	n/a	n/a
Man-Made Mining Cavities					
Natural Cavities					
Non Coal Mining Areas of Great Britain				n/a	n/a
Potential for Collapsible Ground Stability Hazards	pg 20	Yes		n/a	n/a
Potential for Compressible Ground Stability Hazards				n/a	n/a
Potential for Ground Dissolution Stability Hazards				n/a	n/a
Potential for Landslide Ground Stability Hazards	pg 20	Yes		n/a	n/a
Potential for Running Sand Ground Stability Hazards	pg 20	Yes		n/a	n/a
Potential for Shrinking or Swelling Clay Ground Stability Hazards	pg 20	Yes		n/a	n/a
Radon Potential - Radon Affected Areas			n/a	n/a	n/a
Radon Potential - Radon Protection Measures			n/a	n/a	n/a
Industrial Land Use					
Contemporary Trade Directory Entries	pg 21		7	34	97
Fuel Station Entries	pg 32			1	3
Points of Interest - Commercial Services	pg 32		1	5	11
Points of Interest - Education and Health	pg 34			7	2
Points of Interest - Manufacturing and Production	pg 35			3	2
Points of Interest - Public Infrastructure	pg 35			10	2
Points of Interest - Recreational and Environmental	pg 36		4		25
Gas Pipelines					
Underground Electrical Cables	pg 39		6	18	87

Data Type	Page Number	On Site	0 to 250m	251 to 500m	501 to 1000m (*up to 2000m)
Sensitive Land Use					
Ancient Woodland					
Areas of Adopted Green Belt					
Areas of Unadopted Green Belt					
Areas of Outstanding Natural Beauty					
Environmentally Sensitive Areas					
Forest Parks					
Local Nature Reserves	pg 51			1	1
Marine Nature Reserves					
National Nature Reserves					
National Parks					
Nitrate Sensitive Areas					
Nitrate Vulnerable Zones					
Ramsar Sites					
Sites of Special Scientific Interest					
Special Areas of Conservation					
Special Protection Areas					
World Heritage Sites					

Map ID	Details	Quadrant Reference (Compass Direction)	Estimated Distance From Site	Contact	NGR
1	Discharge Consents Operator: Thames Water Utilities Ltd Property Type: WTW/WATER COLLECTION/TREATMENT/SUPPLY Location: Barrow Hill Authority: Environment Agency, Thames Region Catchment Area: Not Supplied Reference: Temp.0018 Permit Version: 1 Effective Date: 15th September 1989 Issued Date: 15th September 1989 Revocation Date: 5th October 2000 Discharge Type: Trade Effluent Discharge: Freshwater Stream/River Environment: Receiving Water: River Thames Status: Authorisation revoked Positional Accuracy: Located by supplier to within 100m	A14NW (E)	579	2	527600 183600
2	Discharge Consents Operator: Marylebone Cricket Club Property Type: SPORT, AMUSEMENT+RECREATION/GOLF CLUB/GYM/THEME PK/SPA Location: Marylebone Cricket Club Lord'S Cricket Ground Marylebone Cricket Club St John'S Wood London Nw8 8qn Authority: Environment Agency, Thames Region Catchment Area: Not Supplied Reference: Eprkb3091es Permit Version: 1 Effective Date: 22nd June 2018 Issued Date: 22nd June 2018 Revocation Date: Not Supplied Discharge Type: Trade Discharge - Process Water Discharge: Land/Soakaway Environment: Receiving Water: Groundwater Status: New issued under EPR 2010 Positional Accuracy: Located by supplier to within 10m	A8SW (S)	746	2	526747 182782
3	Discharge Consents Operator: National Grid Company Plc. Property Type: SUB-STATION/ELECTRICITY/GAS/AIR CONDITIONING SUPPLY Location: St.Johns Wood Outlet, St.Johns Wood, Camden, London Authority: Environment Agency, Thames Region Catchment Area: Not Given Reference: CTMR.0388 Permit Version: 1 Effective Date: 28th March 1980 Issued Date: 28th March 1980 Revocation Date: Not Supplied Discharge Type: Trade Discharges - Cooling Water Discharge: Canal Environment: Receiving Water: Grand Unioncanal Status: Transferred from Rivers (Prevention of Pollution) Act 1951-1961 Positional Accuracy: Located by supplier to within 100m	A8SE (S)	946	2	527150 182540
4	Local Authority Pollution Prevention and Controls Name: St John'S Wood Dry Cleaners Location: 47 Charlbert Street, London, NW8 6JN Authority: Westminster City Council, Environmental Health Department Permit Reference: 09/53345/EE1EP Dated: 10th November 2009 Process Type: Local Authority Pollution Prevention and Control Description: PG6/46 Dry cleaning Status: Permitted Positional Accuracy: Manually positioned to the address or location	A13SE (SE)	178	3	527114 183327
5	Local Authority Pollution Prevention and Controls Name: Johnsons Cleaners Location: 69 St Johns Wood High Street, London, Nw8 7nl Authority: Westminster City Council, Environmental Health Department Permit Reference: 06/40583/EE1EP Dated: 7th September 2007 Process Type: Local Authority Pollution Prevention and Control Description: PG6/46 Dry cleaning Status: Site Closed Positional Accuracy: Manually positioned to the address or location	A13SW (S)	260	3	526938 183230



Map ID	Details	Quadrant Reference (Compass Direction)	Estimated Distance From Site	Contact	NGR
5	<p>Local Authority Pollution Prevention and Controls</p> <p>Name: Madame George Location: 9 Circus Road, London, Nw8 6nx Authority: Westminster City Council, Environmental Health Department Permit Reference: 06/39117/EE1EP Dated: 7th September 2007 Process Type: Local Authority Pollution Prevention and Control Description: PG6/46 Dry cleaning Status: Permitted Positional Accuracy: Manually positioned to the address or location</p>	A13SW (S)	276	3	526902 183227
6	<p>Local Authority Pollution Prevention and Controls</p> <p>Name: Tempo Dry Cleaners Location: 98 St Johns Wood High Street, London, Nw8 7sh Authority: Westminster City Council, Environmental Health Department Permit Reference: 06/38279/EE1EP Dated: 7th September 2007 Process Type: Local Authority Pollution Prevention and Control Description: PG6/46 Dry cleaning Status: Site Closed Positional Accuracy: Manually positioned to the address or location</p>	A13SE (S)	293	3	527019 183184
7	<p>Local Authority Pollution Prevention and Controls</p> <p>Name: Ivy Dry Cleaner Location: 4 Queens Terrace, London, Nw8 6dx Authority: Westminster City Council, Environmental Health Department Permit Reference: 06/40583/EE1EP Dated: 14th September 2007 Process Type: Local Authority Pollution Prevention and Control Description: PG6/46 Dry cleaning Status: Permitted Positional Accuracy: Manually positioned to the address or location</p>	A13NW (W)	312	3	526672 183539
8	<p>Local Authority Pollution Prevention and Controls</p> <p>Name: Elias Dry Cleaners Location: 68 St Johns Wood High Street, London, Nw8 7sh Authority: Westminster City Council, Environmental Health Department Permit Reference: 08/15232/EE1EP Dated: 6th March 2008 Process Type: Local Authority Pollution Prevention and Control Description: PG6/46 Dry cleaning Status: Permitted Positional Accuracy: Manually positioned to the address or location</p>	A8NE (S)	371	3	527077 183110
9	<p>Local Authority Pollution Prevention and Controls</p> <p>Name: Bp Filling Station Location: 21-41 Wellington Road, St John's Wood, LONDON, NW8 9SP Authority: Westminster City Council, Environmental Health Department Permit Reference: VR 8 Dated: 7th May 1999 Process Type: Local Authority Air Pollution Control Description: PG1/14 Petrol filling station Status: Authorised Positional Accuracy: Manually positioned to the address or location</p>	A8NW (S)	426	3	526864 183080
10	<p>Local Authority Pollution Prevention and Controls</p> <p>Name: Abbey Dry Cleaners Location: 11 Blenheim Terrace, London, Nw8 0eh Authority: Westminster City Council, Environmental Health Department Permit Reference: 07/71922/EE1EP Dated: 25th September 2007 Process Type: Local Authority Pollution Prevention and Control Description: PG6/46 Dry cleaning Status: Site Closed Positional Accuracy: Manually positioned to the address or location</p>	A12SW (W)	696	3	526303 183355
11	<p>Local Authority Pollution Prevention and Controls</p> <p>Name: Lords Dry Cleaners Location: 4 Lodge Road, London, Nw8 7ja Authority: Westminster City Council, Environmental Health Department Permit Reference: 06/40566/EE1EP Dated: 7th September 2007 Process Type: Local Authority Pollution Prevention and Control Description: PG6/46 Dry cleaning Status: Permitted Positional Accuracy: Manually positioned to the address or location</p>	A8SE (S)	721	3	527192 182777



Map ID	Details	Quadrant Reference (Compass Direction)	Estimated Distance From Site	Contact	NGR
12	<p>Local Authority Pollution Prevention and Controls</p> <p>Name: Siciliana Location: 6 Blenheim Terrace, London, Nw8 0eb Authority: Westminster City Council, Environmental Health Department Permit Reference: 06/48997/EE1EP Dated: 25th September 2007 Process Type: Local Authority Pollution Prevention and Control Description: PG6/46 Dry cleaning Status: Permitted Positional Accuracy: Manually positioned to the address or location</p>	A12SW (W)	792	3	526198 183395
13	<p>Local Authority Pollution Prevention and Controls</p> <p>Name: Masterclean Dry Cleaners Location: 6 Langtry Walk, London, Nw8 0du Authority: London Borough of Camden, Pollution Projects Team Permit Reference: PPC/DC38 Dated: 12th January 2007 Process Type: Local Authority Pollution Prevention and Control Description: PG6/46 Dry cleaning Status: Permitted Positional Accuracy: Located by supplier to within 10m</p>	A17SE (NW)	804	4	526352 184004
14	<p>Local Authority Pollution Prevention and Controls</p> <p>Name: Kings Dry Cleaners Location: 25 Winchester Road, London, E4 Authority: London Borough of Waltham Forest, Environmental Health Department Permit Reference: DC05 Dated: 6th July 2007 Process Type: Local Authority Pollution Prevention and Control Description: PG6/46 Dry cleaning Status: Permitted Positional Accuracy: Manually positioned to the address or location</p>	A18NW (N)	810	5	526812 184310
15	<p>Local Authority Pollution Prevention and Controls</p> <p>Name: Swiss Cottage Dry Cleaners Location: 121 Finchley Road, London, Nw3 6hy Authority: London Borough of Camden, Pollution Projects Team Permit Reference: PPC/DC10 Dated: 12th January 2007 Process Type: Local Authority Pollution Prevention and Control Description: PG6/46 Dry cleaning Status: Permitted Positional Accuracy: Located by supplier to within 10m</p>	A17NE (NW)	835	4	526626 184270
16	<p>Local Authority Pollution Prevention and Controls</p> <p>Name: Star Service Station Location: 129 Park Road, LONDON, NW8 7JB Authority: Westminster City Council, Environmental Health Department Permit Reference: NOT GIVEN Dated: 1st March 1999 Process Type: Local Authority Air Pollution Control Description: PG1/14 Petrol filling station Status: Not Supplied Positional Accuracy: Automatically positioned to the address</p>	A8SE (S)	847	3	527274 182669
17	<p>Local Authority Pollution Prevention and Controls</p> <p>Name: Perfect Dry Cleaners Location: 55 Abbey Road, London, NW8 0AD Authority: Westminster City Council, Environmental Health Department Permit Reference: 09/74394/EE1EP Dated: 23rd March 2010 Process Type: Local Authority Pollution Prevention and Control Description: PG6/46 Dry cleaning Status: Permitted Positional Accuracy: Manually positioned to the address or location</p>	A12NW (W)	917	3	526069 183582
18	<p>Local Authority Pollution Prevention and Controls</p> <p>Name: Connoisseur Dry Cleaners Location: 3-5 Fairhazel Gardens, London, Nw6 3qe Authority: London Borough of Camden, Pollution Projects Team Permit Reference: PPC/DC11 Dated: 12th January 2007 Process Type: Local Authority Pollution Prevention and Control Description: PG6/46 Dry cleaning Status: Permitted Positional Accuracy: Located by supplier to within 10m</p>	A17SW (NW)	946	4	526262 184119

Map ID	Details	Quadrant Reference (Compass Direction)	Estimated Distance From Site	Contact	NGR
18	Local Authority Pollution Prevention and Controls Name: Sqweaky Clean Professional Dry Cleaners Location: 13 Fairhazel Gardens, London, Nw6 3qe Authority: London Borough of Camden, Pollution Projects Team Permit Reference: PPC/DC37 Dated: 12th January 2007 Process Type: Local Authority Pollution Prevention and Control Description: PG6/46 Dry cleaning Status: Permitted Positional Accuracy: Located by supplier to within 10m	A17SW (NW)	975	4	526237 184134
19	Local Authority Pollution Prevention and Controls Name: London Zoo Location: Regents Park, LONDON, NW1 4RY Authority: Westminster City Council, Environmental Health Department Permit Reference: Not Given Dated: 1st November 1992 Process Type: Local Authority Air Pollution Control Description: PG5/1Clinical waste incineration processes under 1 tonne an hour Status: Authorisation has expired Positional Accuracy: Automatically positioned to the address	A14SE (E)	985	3	528016 183480
	Nearest Surface Water Feature	A14SW (SE)	444	-	527410 183257
20	Pollution Incidents to Controlled Waters Property Type: Not Given Location: LONDON, NW8 Authority: Environment Agency, Thames Region Pollutant: Oils - Unknown Note: Not Supplied Incident Date: 2nd February 1996 Incident Reference: SE960054 Catchment Area: Not Given Receiving Water: Not Given Cause of Incident: Not Given Incident Severity: Category 3 - Minor Incident Positional Accuracy: Located by supplier to within 100m	A13SW (SW)	353	2	526800 183200
21	Pollution Incidents to Controlled Waters Property Type: Not Given Location: LONDON, NW8 Authority: Environment Agency, Thames Region Pollutant: Miscellaneous - Natural Note: Not Supplied Incident Date: 10th September 1996 Incident Reference: SE960481 Catchment Area: Not Given Receiving Water: Not Given Cause of Incident: Not Given Incident Severity: Category 3 - Minor Incident Positional Accuracy: Located by supplier to within 100m	A13SE (SE)	395	2	527300 183200
22	Pollution Incidents to Controlled Waters Property Type: Not Given Location: St Johns Wood, LONDON, NW8 Authority: Environment Agency, Thames Region Pollutant: Oils - Unknown Note: Not Supplied Incident Date: Not Supplied Incident Reference: SE960382 Catchment Area: Not Given Receiving Water: Not Given Cause of Incident: Not Given Incident Severity: Category 3 - Minor Incident Positional Accuracy: Located by supplier to within 100m	A8SE (SE)	733	2	527300 182800
23	Pollution Incidents to Controlled Waters Property Type: Not Given Location: North Bank, Lisson Grove Authority: Environment Agency, Thames Region Pollutant: Oils - Unknown Note: Not Supplied Incident Date: 20th November 1997 Incident Reference: THN11997035912 Catchment Area: Not Given Receiving Water: Not Given Cause of Incident: Not Given Incident Severity: Category 3 - Minor Incident Positional Accuracy: Located by supplier to within 100m	A8SW (S)	977	2	527000 182500



Map ID	Details	Quadrant Reference (Compass Direction)	Estimated Distance From Site	Contact	NGR
23	<p>Pollution Incidents to Controlled Waters</p> <p>Property Type: Not Given Location: Lisson Grove, ST JOHNS WOOD Authority: Environment Agency, Thames Region Pollutant: Oils - Unknown Note: Confirmed incident Incident Date: 9th June 1999 Incident Reference: THNE1999043428 Catchment Area: Not Given Receiving Water: Not Given Cause of Incident: Not Given Incident Severity: Category 3 - Minor Incident Positional Accuracy: Located by supplier to within 10m</p>	A8SW (S)	982	2	527005 182495
23	<p>Pollution Incidents to Controlled Waters</p> <p>Property Type: Not Given Location: Romany Rise, PETTS WOOD Authority: Environment Agency, Thames Region Pollutant: Oils - Unknown Note: Not Supplied Incident Date: 15th November 1997 Incident Reference: THN11997030929 Catchment Area: Not Given Receiving Water: Not Given Cause of Incident: Not Given Incident Severity: Category 3 - Minor Incident Positional Accuracy: Located by supplier to within 100m</p>	A8SW (S)	982	2	527000 182495
24	<p>Registered Radioactive Substances</p> <p>Name: Wellington Hospital Location: 8a Wellington Place, LONDON, NW8 9LE Authority: Environment Agency, Thames Region Permit Reference: Bw7716 Dated: 1st December 2003 Process Type: Authorisation under S13 RSA for the disposal of Radioactive waste (was RSA60 S7) Description: Minor variation to authorisation under RSA Status: Application has been authorised and any conditions apply to the operator Positional Accuracy: Automatically positioned to the address</p>	A8NW (SW)	405	2	526814 183127
24	<p>Registered Radioactive Substances</p> <p>Name: Wellington Hospital Location: 8a Wellington Place, LONDON, NW8 9LE Authority: Environment Agency, Thames Region Permit Reference: Br5558 Dated: 28th March 2002 Process Type: Registration under S7 RSA for the keeping and use of Radioactive materials (was RSA60 S1) Description: Registration under the Act of an open source which is also the subject of an authorisation Status: Application has been authorised and any conditions apply to the operator Positional Accuracy: Automatically positioned to the address</p>	A8NW (SW)	405	2	526814 183127
24	<p>Registered Radioactive Substances</p> <p>Name: Wellington Hospital Location: 8a Wellington Place, LONDON, NW8 9LE Authority: Environment Agency, Thames Region Permit Reference: Br5531 Dated: 28th March 2002 Process Type: Authorisation under S13 RSA for the disposal of Radioactive waste (was RSA60 S7) Description: Authorisation under RSA Status: Authorisation superseded by a substantial or non substantial variation Positional Accuracy: Automatically positioned to the address</p>	A8NW (SW)	405	2	526814 183127
24	<p>Registered Radioactive Substances</p> <p>Name: Humana Hospital Wellington Location: 27 Circus Road, LONDON, Greater London, NW8 9JG Authority: Environment Agency, Thames Region Permit Reference: AB8520 Dated: 31st March 1991 Process Type: Authorisation under S13 RSA for the disposal of Radioactive waste (was RSA60 S7) Description: Authorisation under RSA in respect of a registration under S7 when Technetium 99M is used being =< 10 gigabecquerels Status: Authorisation either revoked or cancelled Positional Accuracy: Unknown</p>	A8NW (SW)	411	2	526794 183133

Map ID	Details	Quadrant Reference (Compass Direction)	Estimated Distance From Site	Contact	NGR
25	<p>Registered Radioactive Substances</p> <p>Name: Wynn Institute For Metabolic Research Location: Flat 21, Cavendish House, 21 Wellington Road, LONDON, Greater London, NW8 9SQ Authority: Environment Agency, Thames Region Permit Reference: AC0591 Dated: 31st March 1991 Process Type: Authorisation under S13 RSA for the disposal of Radioactive waste (was RSA60 S7) Description: Authorisation under RSA Status: Authorisation either revoked or cancelled Positional Accuracy: Automatically positioned to the address</p>	A8NW (S)	468	2	526898 183025
26	<p>Registered Radioactive Substances</p> <p>Name: Hca International Limited Location: The Wellington Hospital, Wellington Place, St Johns Wood, Nw8 9le Authority: Environment Agency, Thames Region Permit Reference: ZB3233DA Dated: Not Supplied Process Type: Not Supplied Description: Not Supplied Status: Application has been determined by the EA Positional Accuracy: Automatically positioned to the address</p>	A8NW (S)	496	2	526931 182989
26	<p>Registered Radioactive Substances</p> <p>Name: Humana Hospital Wellington Location: 8A Wellington Place, LONDON, Greater London, NW8 9LE Authority: Environment Agency, Thames Region Permit Reference: AB8511 Dated: 31st March 1991 Process Type: Authorisation under S13 RSA for the disposal of Radioactive waste (was RSA60 S7) Description: Authorisation under RSA Status: Authorisation either revoked or cancelled Positional Accuracy: Unknown</p>	A8NW (S)	526	2	526918 182961
27	<p>Registered Radioactive Substances</p> <p>Name: Hca International Limited Location: The Platinum Medical Centre, Lodge Road, London, Nw8 7ja Authority: Environment Agency, Thames Region Permit Reference: PP3290SL Dated: Not Supplied Process Type: Not Supplied Description: Not Supplied Status: Application has been determined by the EA Positional Accuracy: Automatically positioned to the address</p>	A8SE (S)	815	2	527135 182670
28	<p>Registered Radioactive Substances</p> <p>Name: Institute Of Zoology Location: Regents Park, London, NW1 4RY Authority: Environment Agency, Thames Region Permit Reference: Bw7007 Dated: 1st December 2003 Process Type: Authorisation under S13 RSA for the disposal of Radioactive waste (was RSA60 S7) Description: Minor variation to authorisation under RSA Status: Application has been authorised and any conditions apply to the operator Positional Accuracy: Automatically positioned to the address</p>	A14SE (E)	980	2	528011 183480
28	<p>Registered Radioactive Substances</p> <p>Name: Institute Of Zoology Location: Zoological Society Of London, Regents Park, LONDON, Greater London, NW1 4RY Authority: Environment Agency, Thames Region Permit Reference: AC7596 Dated: 31st March 1991 Process Type: Registration under S7 RSA for the keeping and use of Radioactive materials (was RSA60 S1) Description: Registration under the Act of an open source which is also the subject of an authorisation Status: Authorisation superseded by a substantial or non substantial variation Positional Accuracy: Unknown</p>	A14SE (E)	980	2	528011 183480

Map ID	Details	Quadrant Reference (Compass Direction)	Estimated Distance From Site	Contact	NGR
28	<p>Registered Radioactive Substances</p> <p>Name: Institute Of Zoology Location: Zoological Society Of London, Regents Park, LONDON, Greater London, NW1 4RY Authority: Environment Agency, Thames Region Permit Reference: AC7588 Dated: 31st March 1991 Process Type: Authorisation under S13 RSA for the disposal of Radioactive waste (was RSA60 S7) Description: Authorisation under RSA Status: Authorisation superseded by a substantial or non substantial variation Positional Accuracy: Unknown</p>	A14SE (E)	980	2	528011 183475
28	<p>Registered Radioactive Substances</p> <p>Name: Institute Of Zoology Location: Zoological Society Of London, Regents Park, LONDON, Greater London, NW1 4RY Authority: Environment Agency, Thames Region Permit Reference: AQ9405 Dated: 30th August 1995 Process Type: Authorisation under S13 RSA for the disposal of Radioactive waste (was RSA60 S7) Description: Minor variation to authorisation under RSA Status: Authorisation superseded by a substantial or non substantial variation Positional Accuracy: Unknown</p>	A14SE (E)	984	2	528016 183485
28	<p>Registered Radioactive Substances</p> <p>Name: Institute Of Zoology Location: London Zoo, Regents Park, LONDON, Greater London, NW1 4RY Authority: Environment Agency, Thames Region Permit Reference: AS7515 Dated: 21st December 1995 Process Type: Registration under S7 RSA for the keeping and use of Radioactive materials (was RSA60 S1) Description: Substantial variation to a registration under the Act of an open source which is also the subject of an authorisation Status: Application has been authorised and any conditions apply to the operator Positional Accuracy: Unknown</p>	A14SE (E)	985	2	528016 183475
	<p>River Quality</p> <p>Name: Guc (Paddington Arm) GQA Grade: River Quality E Reach: Canal Feeder - Camden Road Estimated Distance (km): 10.5 Flow Rate: Flow greater than 80 cumecs Flow Type: Canal Year: 2000</p>	A14SW (SE)	424	2	527377 183244
29	<p>Water Abstractions</p> <p>Operator: Marylebone Cricket Club Licence Number: Th/039/0039/116 Permit Version: 1 Location: Lords Cricket Ground, London. Authority: Environment Agency, Thames Region Abstraction: Other Industrial/Commercial/Public Services: Heat Pump Abstraction Type: Water may be abstracted from a single point Source: Groundwater Daily Rate (m3): Not Supplied Yearly Rate (m3): Not Supplied Details: Not Supplied Authorised Start: 01 April Authorised End: 31 March Permit Start Date: 17th May 2017 Permit End Date: Not Supplied Positional Accuracy: Located by supplier to within 10m</p>	A8NW (S)	616	2	526902 182872



Map ID	Details	Quadrant Reference (Compass Direction)	Estimated Distance From Site	Contact	NGR
30	<p>Water Abstractions</p> <p>Operator: Thames Water Utilities Ltd Licence Number: Th/039/0039/058 Permit Version: 1 Location: Borehole At Barrow Hill Authority: Environment Agency, Thames Region Abstraction: Public Water Supply: Potable Water Supply - Direct Abstraction Type: Water may be abstracted from a single point Source: Groundwater Daily Rate (m3): Not Supplied Yearly Rate (m3): Not Supplied Details: Not Supplied Authorised Start: 01 April Authorised End: 31 March Permit Start Date: 1st April 2013 Permit End Date: Not Supplied Positional Accuracy: Located by supplier to within 10m</p>	A14NW (E)	639	2	527636 183697
30	<p>Water Abstractions</p> <p>Operator: Thames Water Utilities Ltd Licence Number: 28/39/39/0231 Permit Version: 1 Location: Barrow Hill Pumping Station - Borehole Authority: Environment Agency, Thames Region Abstraction: Public Water Supply: Potable Water Supply - Direct Abstraction Type: Water may be abstracted from a single point Source: Groundwater Daily Rate (m3): Not Supplied Yearly Rate (m3): Not Supplied Details: Barrow Hill Pumping Station Authorised Start: 01 January Authorised End: 31 December Permit Start Date: 1st April 2007 Permit End Date: Not Supplied Positional Accuracy: Located by supplier to within 10m</p>	A14NW (E)	641	2	527640 183690
30	<p>Water Abstractions</p> <p>Operator: Thames Water Utilities Ltd Licence Number: 28/39/39/0202 Permit Version: 1 Location: Barrow Hill Pumping Station - Borehole Authority: Environment Agency, Thames Region Abstraction: Public Water Supply: Potable Water Supply - Direct Abstraction Type: Water may be abstracted from a single point Source: Groundwater Daily Rate (m3): Not Supplied Yearly Rate (m3): Not Supplied Details: Barrow Hill Pumping Station Authorised Start: 01 January Authorised End: 31 December Permit Start Date: 26th September 2002 Permit End Date: Not Supplied Positional Accuracy: Located by supplier to within 10m</p>	A14NW (E)	641	2	527640 183690
31	<p>Water Abstractions</p> <p>Operator: London Borough Of Camden Licence Number: Th/039/0039/087 Permit Version: 1 Location: Swiss Cottage Open Space- Borehole Authority: Environment Agency, Thames Region Abstraction: Municipal Grounds: Spray Irrigation - Direct Abstraction Type: Water may be abstracted from a single point Source: Groundwater Daily Rate (m3): Not Supplied Yearly Rate (m3): Not Supplied Details: Swiss Cottage Open Space, Winchester Road, London Authorised Start: 01 April Authorised End: 31 March Permit Start Date: 5th December 2013 Permit End Date: Not Supplied Positional Accuracy: Located by supplier to within 10m</p>	A18NW (N)	780	2	526750 184261

Map ID	Details	Quadrant Reference (Compass Direction)	Estimated Distance From Site	Contact	NGR
31	Water Abstractions Operator: London Borough Of Camden Licence Number: Th/039/0039/087 Permit Version: 1 Location: Swiss Cottage Open Space- Borehole Authority: Environment Agency, Thames Region Abstraction: Municipal Grounds: General Washing/Process Washing Abstraction Type: Water may be abstracted from a single point Source: Groundwater Daily Rate (m3): Not Supplied Yearly Rate (m3): Not Supplied Details: Swiss Cottage Open Space, Winchester Road, London Authorised Start: 01 April Authorised End: 31 March Permit Start Date: 5th December 2013 Permit End Date: Not Supplied Positional Accuracy: Located by supplier to within 10m	A18NW (N)	780	2	526750 184261
31	Water Abstractions Operator: London Borough Of Camden Licence Number: Th/039/0039/087 Permit Version: 1 Location: Swiss Cottage Open Space- Borehole Authority: Environment Agency, Thames Region Abstraction: Municipal Grounds: Lake And Pond Throughflow Abstraction Type: Water may be abstracted from a single point Source: Groundwater Daily Rate (m3): Not Supplied Yearly Rate (m3): Not Supplied Details: Swiss Cottage Open Space, Winchester Road, London Authorised Start: 01 April Authorised End: 31 March Permit Start Date: 5th December 2013 Permit End Date: Not Supplied Positional Accuracy: Located by supplier to within 10m	A18NW (N)	780	2	526750 184261
32	Water Abstractions Operator: London Borough Of Camden Licence Number: 28/39/39/0219 Permit Version: 1 Location: Swiss Cottage Open Space- Borehole Authority: Environment Agency, Thames Region Abstraction: Municipal Grounds: Spray Irrigation - Direct Abstraction Type: Water may be abstracted from a single point Source: Groundwater Daily Rate (m3): Not Supplied Yearly Rate (m3): Not Supplied Details: Swiss Cottage Open Space, Winchester Road, London. Authorised Start: 01 January Authorised End: 31 December Permit Start Date: 1st April 2008 Permit End Date: Not Supplied Positional Accuracy: Located by supplier to within 10m	A18NW (N)	784	2	526800 184280
33	Water Abstractions Operator: Abbey Lodge Rtm Company Limited Licence Number: 28/39/39/0115 Permit Version: 101 Location: Abbey Lodge, Park Road, London Nw8-Two Boreholes Authority: Environment Agency, Thames Region Abstraction: Household Water Supply: Drinking; Cooking; Sanitary; Washing; (Small Garden) Abstraction Type: Water may be abstracted from a single point Source: Groundwater Daily Rate (m3): Not Supplied Yearly Rate (m3): Not Supplied Details: Abbey Lodge, Park Road, London Nw8 Authorised Start: 01 January Authorised End: 31 December Permit Start Date: 1st June 2006 Permit End Date: Not Supplied Positional Accuracy: Located by supplier to within 10m	A9SW (SE)	946	2	527420 182620



Map ID	Details	Quadrant Reference (Compass Direction)	Estimated Distance From Site	Contact	NGR
33	<p>Water Abstractions</p> <p>Operator: Wood Management Trustees Ltd Licence Number: 28/39/39/0115 Permit Version: 100 Location: Two Boreholes At Abbey Lodge, Park Road, London Nw8 Authority: Environment Agency, Thames Region Abstraction: Household Water Supply: Drinking; Cooking; Sanitary; Washing; (Small Garden) Abstraction Type: Water may be abstracted from a single point Source: Groundwater Daily Rate (m3): 100 Yearly Rate (m3): 28640 Details: Abbey Lodge, Park Road, London Nw8 Authorised Start: 01 January Authorised End: 31 December Permit Start Date: 28th November 1991 Permit End Date: Not Supplied Positional Accuracy: Located by supplier to within 100m</p>	A9SW (SE)	946	2	527420 182620
34	<p>Water Abstractions</p> <p>Operator: Zoological Society Of London Licence Number: 28/39/39/0035 Permit Version: 100 Location: Borehole At Regent'S Park, London Nw1 Authority: Environment Agency, Thames Region Abstraction: Zoos/Kennels/Stables: Animal Watering & General Use (Non Agricultural) Abstraction Type: Water may be abstracted from a single point Source: Groundwater Daily Rate (m3): 59 Yearly Rate (m3): 681 Details: Regent'S Park, London Nw1 Authorised Start: 01 January Authorised End: 31 December Permit Start Date: 4th April 1966 Permit End Date: Not Supplied Positional Accuracy: Located by supplier to within 100m</p>	A14SE (E)	973	2	528000 183400
	<p>Water Abstractions</p> <p>Operator: Canal And River Trust Licence Number: 28/39/39/0164 Permit Version: 101 Location: St John'S Wood, London - Regents Canal Authority: Environment Agency, Thames Region Abstraction: Amenity: Spray Irrigation - Direct Abstraction Type: Water may be abstracted from a single point Source: Surface Daily Rate (m3): Not Supplied Yearly Rate (m3): Not Supplied Details: Pipeline Alongside The Regents Canal, London Authorised Start: 01 January Authorised End: 31 December Permit Start Date: 17th December 2007 Permit End Date: Not Supplied Positional Accuracy: Located by supplier to within 10m</p>	A3NE (S)	1017	2	527050 182460
	<p>Water Abstractions</p> <p>Operator: British Waterways Board Licence Number: 28/39/39/0164 Permit Version: 100 Location: St John'S Wood, London - Regents Canal Authority: Environment Agency, Thames Region Abstraction: Amenity: Spray Irrigation - Direct Abstraction Type: Water may be abstracted from a single point Source: Surface Daily Rate (m3): 3840 Yearly Rate (m3): 1 Details: Pipeline Alongside The Regents Canal, London Authorised Start: 01 January Authorised End: 31 December Permit Start Date: 25th April 1983 Permit End Date: Not Supplied Positional Accuracy: Located by supplier to within 10m</p>	A3NE (S)	1017	2	527050 182460