

PROPOSED REPLANTING PLAN FOR
6 ST PETERS CLOSE

The existing silver birch (to be felled) is situated in a flower bed (this was created when the properties were built)

The new tree will have to be situated adjacent to the silver birch, due to tree stump remainder, as well as needing space for tree growth. Therefore ideal planting will be centrally in the flower bed. This is the only location that will give enough space for branches as the tree matures.

It is still rather close to the garage wall and door plus boundary fences but is the only option in our small garden.

I spoke with an advisor @ Ruxley Manor Garden Centre who recommended a tree from the Sorbus (rowan) family (as recommended).

I will plant the available sapling size (ranges available 1.5 - 2 metres) this is the standard and readily available size. Ruxley Manor can confirm this if required.

I will plant between October 2021 and February 2022, depending on availability but the soonest possible. Please see plan overleaf.

2 of 2

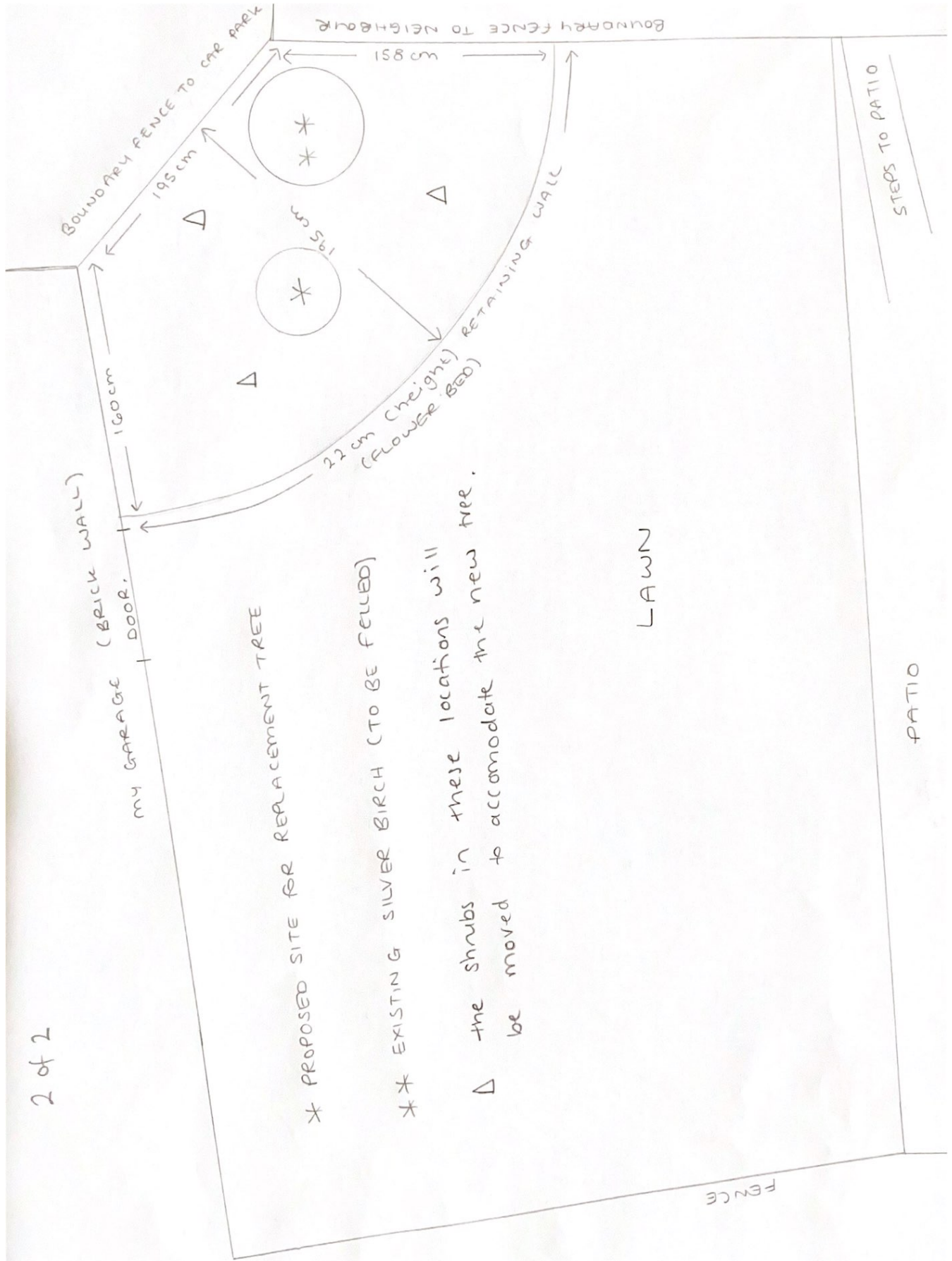

- * PROPOSED SITE FOR REPLACEMENT TREE
- ** EXISTING SILVER BIRCH (TO BE FELLED)
- Δ the shrubs in these locations will be moved to accommodate the new tree.

LAWN

PATIO

STEPS TO PATIO