

LIGHT COLUMN 1:100

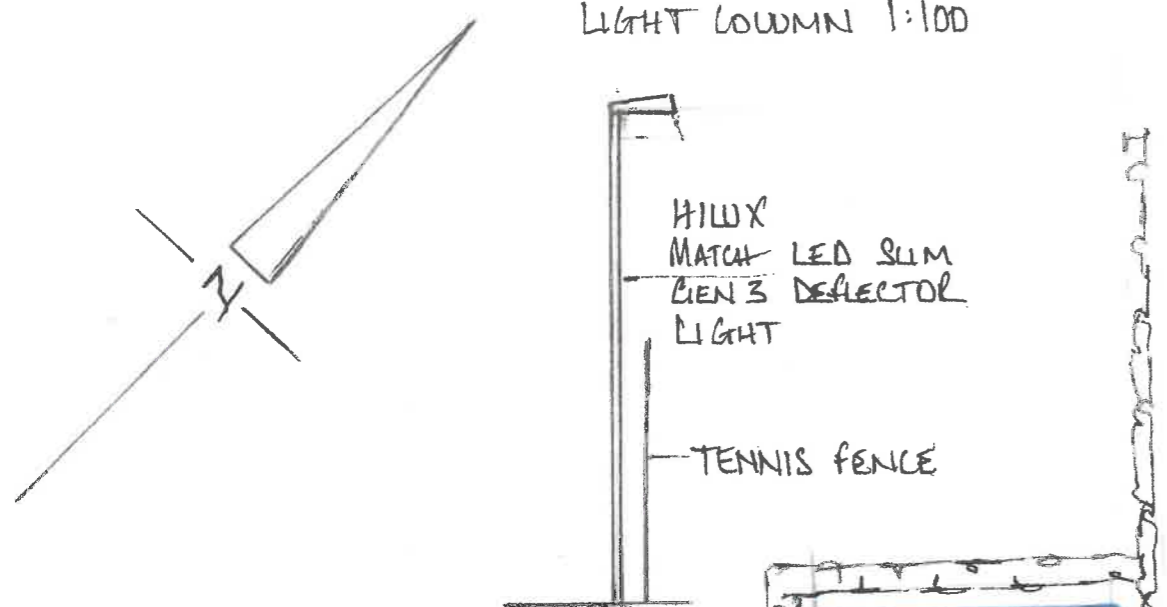

LOCATION PLAN 1:2500

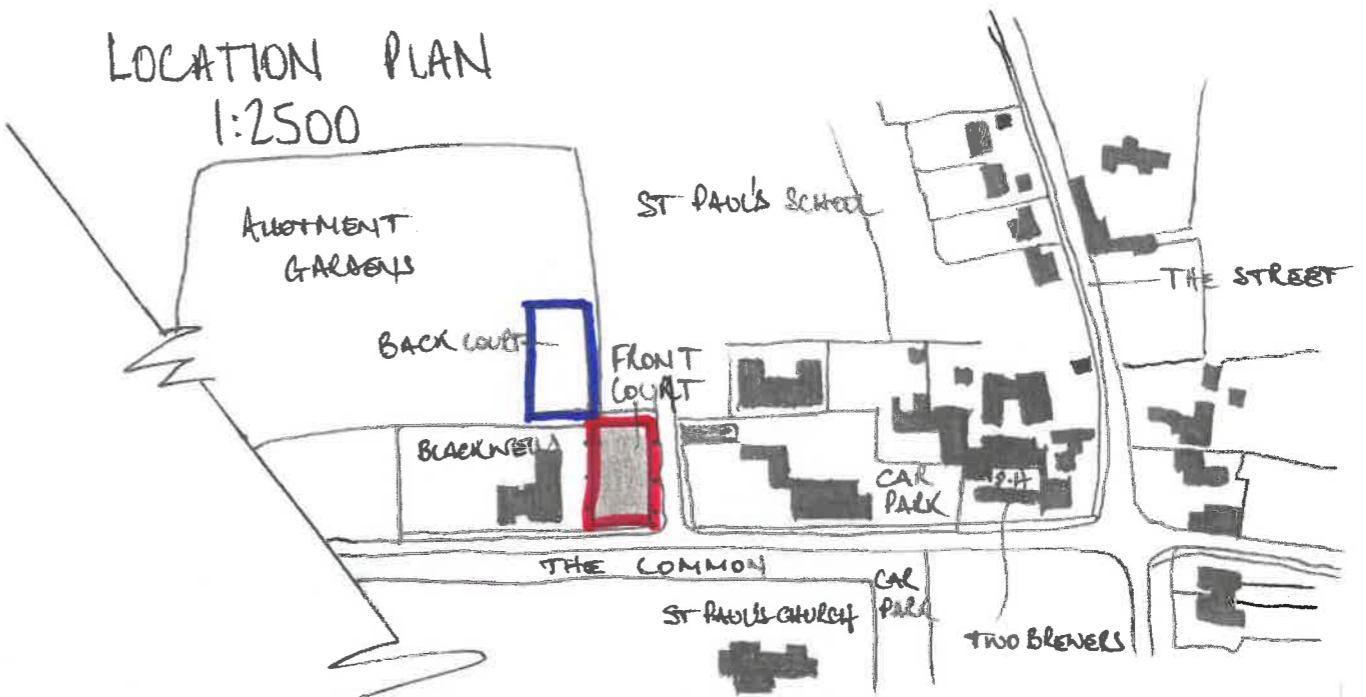

ALLOTMENTS

CHIPPERFIELD TENNIS CLUB BACK COURT

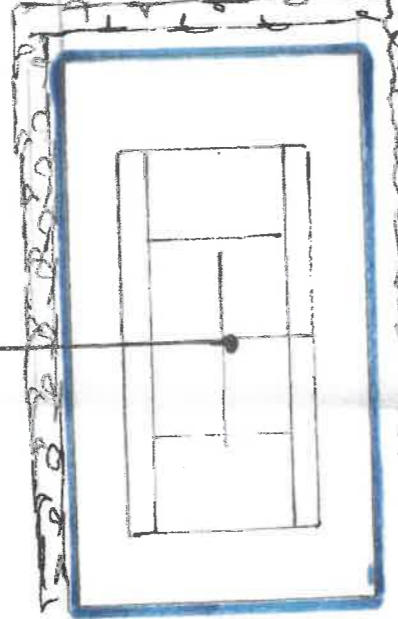

ST PAUL'S SCHOOL



PROPOSED POSITION OF 6 NEW LIGHT COLUMNS

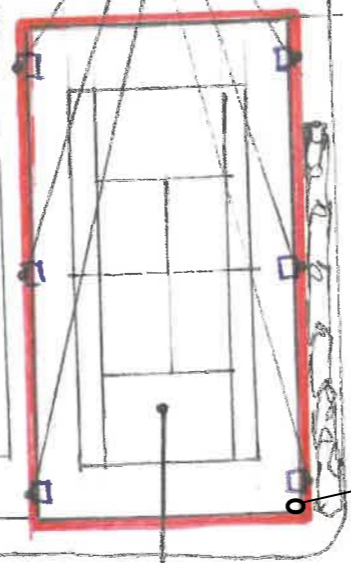

SMALL HALL

OLD SCHOOL HOUSE

Retractable vinyl net 3m height

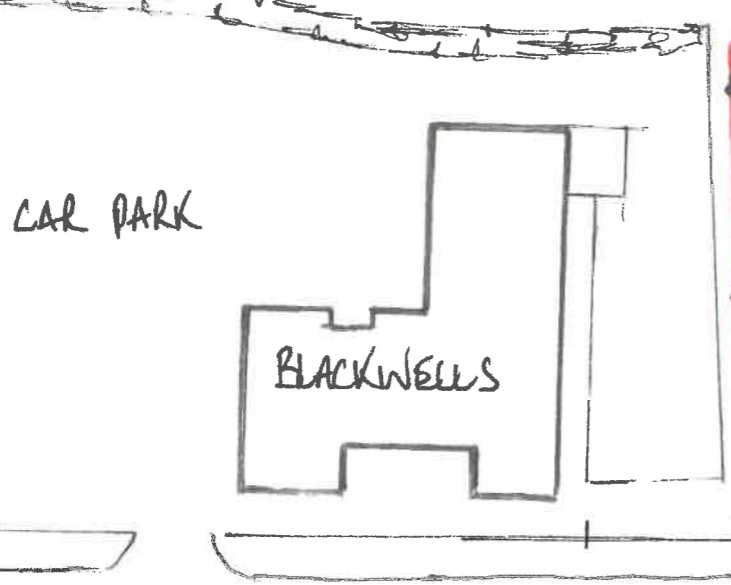

THE COMMON

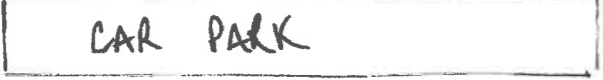

CHIPPERFIELD TENNIS CLUB FRONT COURT

CLIENT	CHIPPERFIELD TENNIS CLUB
PROJECT	PROPOSED LIGHTING SCHEME FOR THE FRONT COURT
DRAWING TITLE	LOCATION AND SITE PLAN
SCALE	1:500 + 1:2500
DATE	JANUARY 2021
DRAWN BY	A JACKSON
DRG NO.	GTC/LP/11

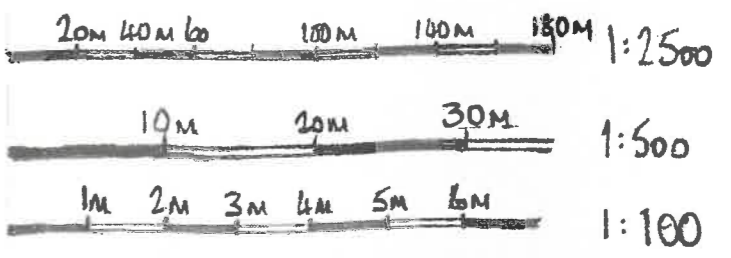

SITE PLAN 1:500

ST PAUL'S CHURCH