

Drawing Number
174056-ARC-1700-LHO01-DRG-ECV-001032 P01.1

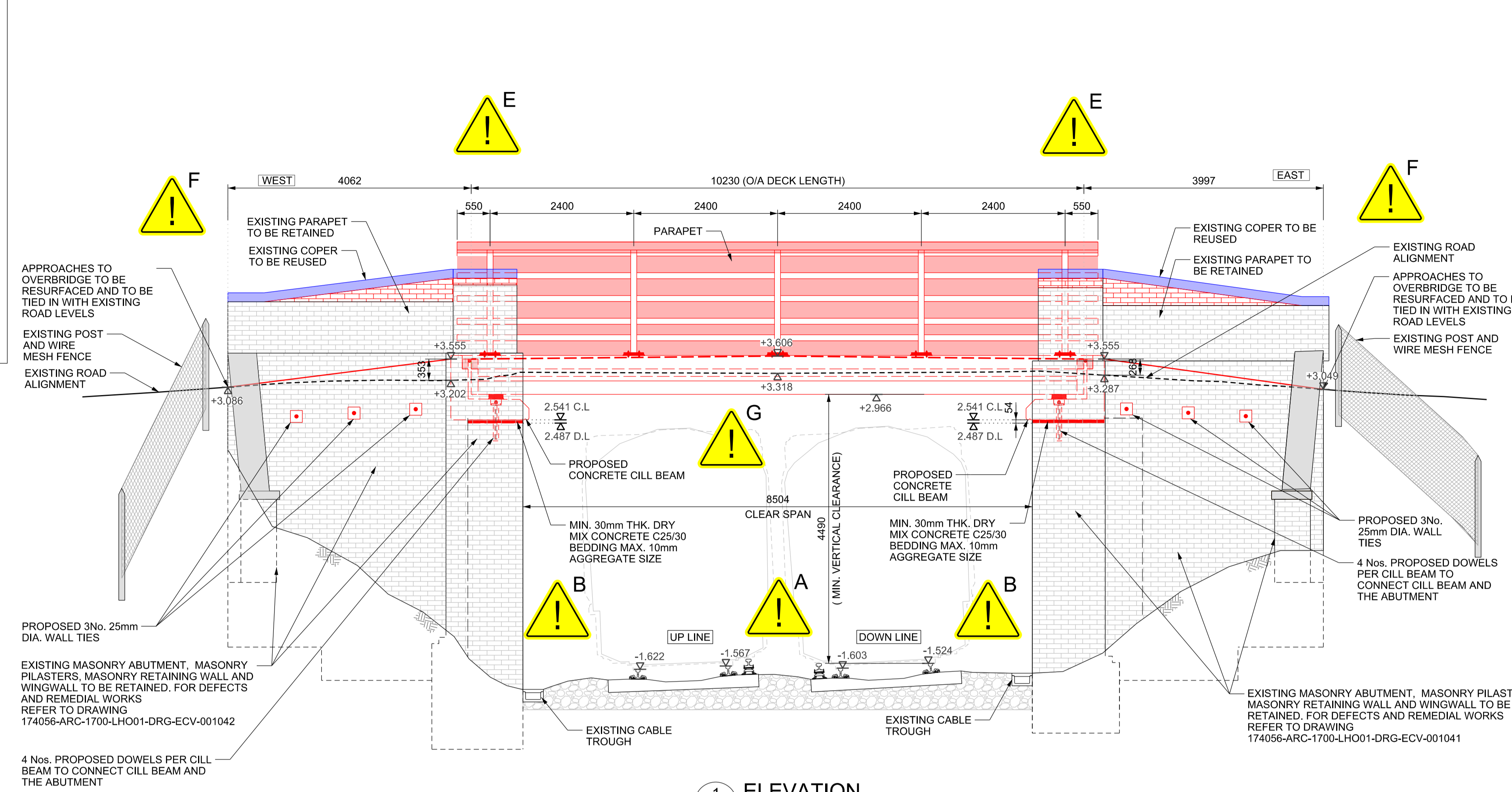

HAZARD SUMMARY TABLE		
SIGNIFICANT DESIGNER'S IDENTIFIED HAZARDS		LIFE SAVING RULES
SAFETY, HEALTH AND ENVIRONMENTAL INFORMATION		
THE FOLLOWING NOTES HIGHLIGHT SIGNIFICANT RESIDUAL HAZARD IDENTIFIED BY THE DESIGNER. TYPICAL HAZARDS THAT SHOULD BE IDENTIFIED BY A COMPETENT CONTRACTOR ARE NOT INCLUDED. THE CONTRACTOR SHALL CARRY OUT THE WORKS USING AN APPROVED SAFE SYSTEM OF WORK		
SHOULD ANY ADDITIONAL HAZARDS BE IDENTIFIED DURING THE COURSE OF THE WORKS, THE CONTRACTOR SHALL NOTIFY ALL RELEVANT MEMBERS OF THE PROJECT TEAM		
A	WORKING NEAR DC CONDUCTOR RAILS	
B	WORKING IN CLOSE PROXIMITY TO EXISTING CABLE TROUGH WITH POTENTIAL SAT CABLES OR FEEDER CABLES LOCATED INSIDE	
E	WORKING AT HEIGHT	
F	LIMITED ACCESS FOR CONSTRUCTION PLANT DUE TO NARROW APPROACH ROADS	
G	LIFTING MATERIALS, CONSTRUCTION AND ERECTION OF HEAVY COMPONENTS	
J	POOR INTER-VISIBILITY BETWEEN VEHICLES TRAVELLING IN THE OPPOSITE DIRECTION	
• FOR MORE DETAILED INFORMATION PLEASE REFER TO THE DESIGNER'S H&S RISK ASSESSMENT REF.: 174056-ARC-1700-LHO01-DRA-ECV-001001.		

- Legend/Notes
- ALL DIMENSIONS ARE IN MILLIMETRES AND ALL LEVELS ARE IN METRES ABOVE ORDNANCE DATUM UNLESS NOTED OTHERWISE.
 - INDICATED SCALES ONLY APPLY TO THE ORIGINAL DRAWING FILE OR WHEN PRINTED AT THE SHEET SIZE SHOWN.
 - THIS DRAWING PRODUCED BASED ON TOPOGRAPHICAL SURVEY CONDUCTED BY NETWORK RAIL ON 19th MAY 2020. THE SURVEY IS NOT COMPLIANT WITH NRL/2/TRK/3100.
 - CONCRETE STRENGTH OF PRECAST PRESTRESSED BEAMS TO BE C50/60 & FOR IN-SITU CONCRETE SLAB TO BE C40/50.
 - SPRAYED APPLIED WATERPROOFING LAYER TO HAVE 3mm MAXIMUM THICKNESS.
 - APL SHALL NOT BE USED UNLESS IT IS A SPECIFIC REQUIREMENT OF THE WATERPROOFING SYSTEM, IN ACCORDANCE WITH CD358 - cl.7.7
 - THIS DRAWING TO BE READ IN CONJUNCTION WITH THE FORM 003 DOCUMENT, THE DESIGNER'S HAZARD RECORD AND ALL FORM 003 DRAWINGS LISTED ON GENERAL NOTES DRAWING 174056-ARC-1700-LHO01-DRG-ECV-001001.

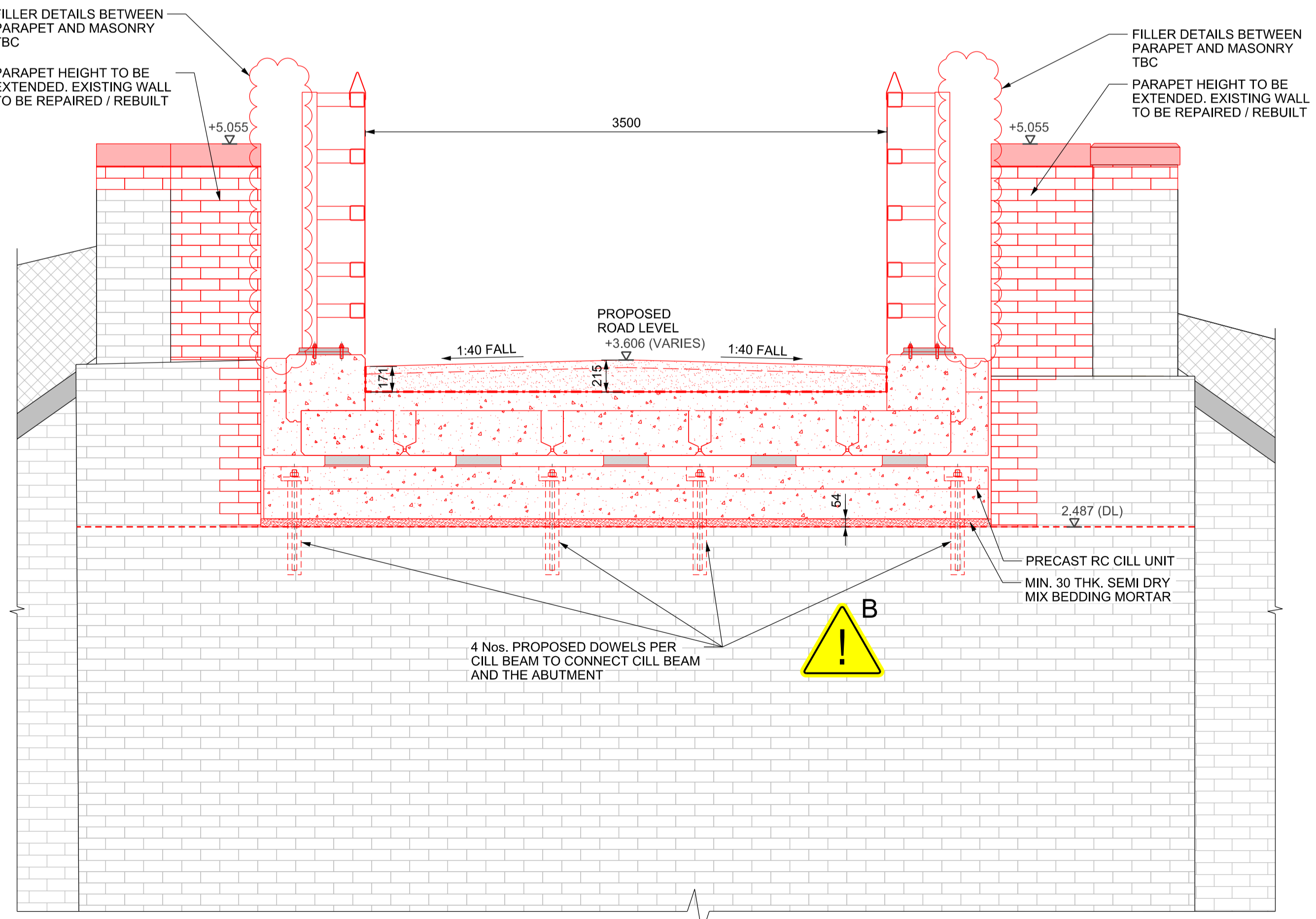
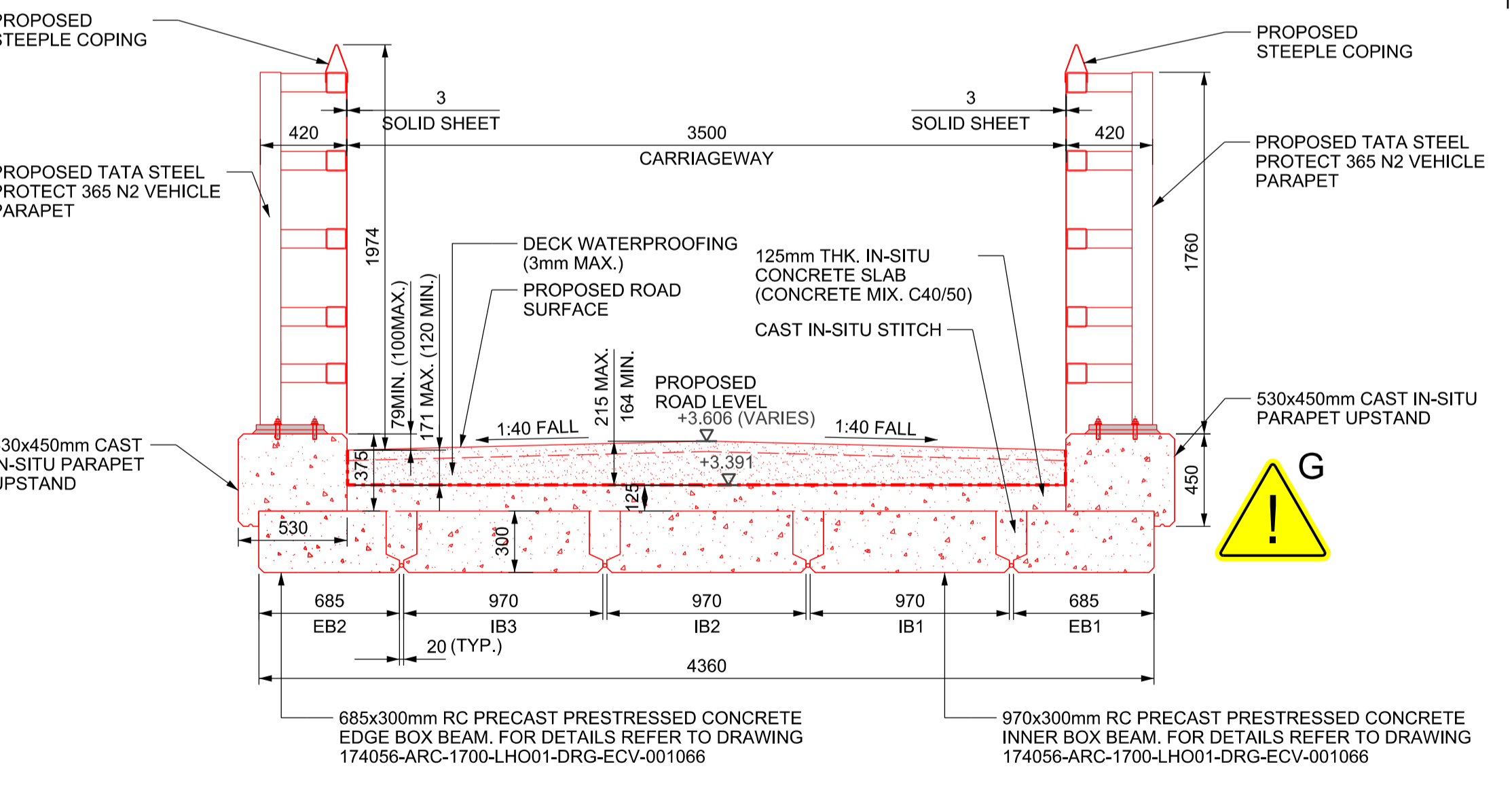
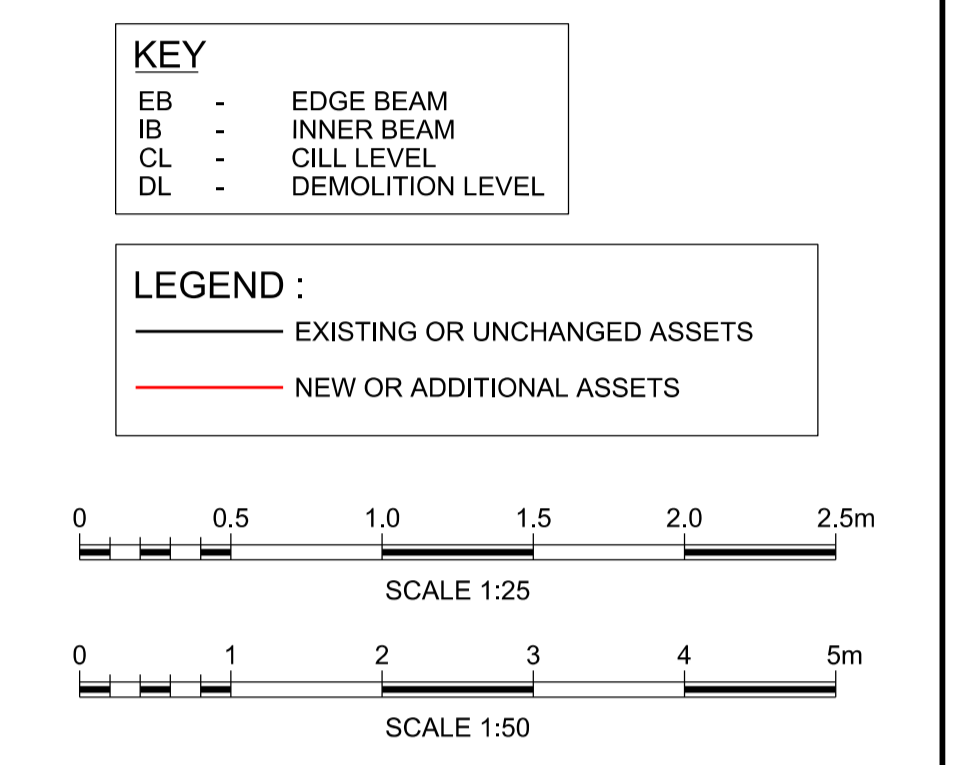

P01.1	08/09/21	Form 003 for Approval	---	---	---
Rev	Date	Description of Revisions	Drawn	Chkd	Appr
Status					
Initial Status or WIP					S0

NetworkRail

OSBORNE

ONE TEAM WESSEX

Authorised: --- Signed: Digitally Signed Date: ---

Contractor(s): **ARCADIS**

Registered office: Arcadis Consulting UK Ltd, 80 Fenchurch Street, London E3CM 4BY
Coordinating office: Bernard Weatherill House, 8 Mint Walk, Croydon, CR0 1EA, Tel: 44 (0) 2030 149 000

www.arcadis.com

Location/Level	LHO01	
Type	Drawing	Sub-type General Arrangement
Role	Engineering - Civils	Discipline ECV
Volume/System		
Phasing	Proposed	Grip Stage GRIP 5
Region	Wessex SMDf	
Contract No.	174056	
Contract Title	Lovely Hill Overbridge Stage 2	
Drawing Title	PROPOSED BRIDGE GENERAL ARRANGEMENT ELEVATION AND SECTION	
Designed	I.Polatoglou	Signed Digitally Signed Date 08/09/21
Drawn	---	Signed Date ---
Checked	---	Signed Digitally Signed Date ---
Approved	---	Signed Digitally Signed Date ---
Scales(s)	AS SHOWN	ELR & Mileage BML2 88m0929yds
Alternative Reference	168922-ORL-MOD-ECV-000050	Sheet of
Drawing Number	174056-ARC-1700-LHO01-DRG-ECV-001032	Revision P01.1