

'LINK BUILDING' CROSS SECTION - AS PROPOSED  
PLAY ROOM - SECTION BB  
1:100 @ A3

Notes  
This drawing is the copyright of Giles Quarme Architects and cannot be printed or reproduced without prior permission.  
This drawing has been based on survey information provided by others.  
All dimensions and setting out must be verified on site before commencement of the work, and any discrepancies notified to the architect.  
All windows and doors are to fit into existing openings unless stated otherwise.  
All dimensions are in millimetres unless stated otherwise.

Drawing Notes:

- Surveyed and drawn by James Brennan Associates Chartered Surveyors for Arrol Architects Ltd & GQA - Issue date December 2020 & July 2021.
- Survey grid is OS GPS & levels are related to ordnance survey GPS datum.
- Units are meters.
- Survey accuracy with a scale of 1:100.
- To be read in conjunction with all PLBC drawings and information.

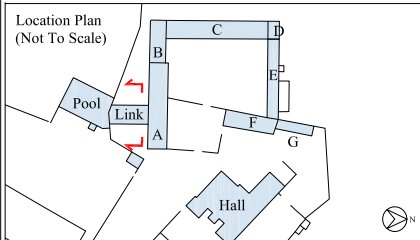

PLANNING ISSUE

Rev	By	Date	Description

Drawing Number	Rev
9801 PLBC (0) 401	A

Project
Aston Hall Barns
Job No. 9801

Title
Proposed Link Building: Cross Section

Drawn	GB	Checked	GQ
-------	----	---------	----

Date	08 2021	Scale	1:100 @ A3
------	---------	-------	------------

Giles Quarme Architects  
*Historic Building Architects & Consultants*

7 Bishops Terrace  
London  
SE11 4UE  
020 7582 0748  
www.quarme.com  
mail@quarme.com