

TYPICAL FLOOR BUILD-UP - BARN 'A'
1:10 @ A3

Notes
This drawing is the copyright of Giles Quarme Architects and cannot be printed or reproduced without prior permission.
This drawing has been based on survey information provided by others.
All dimensions and setting out must be verified on site before commencement of the work, and any discrepancies notified to the architect.
All windows and doors are to fit into existing openings unless stated otherwise.
All dimensions are in millimetres unless stated otherwise.

- Drawing Notes:
- Surveyed and drawn by James Brennan Associates Chartered Surveyors for Arrol Architects Ltd & GQA - Issue date December 2020 & July 2021.
 - Survey grid is OS GPS & levels are related to ordonance survey GPS datum.
 - Units are meters.
 - Survey accuracy with a scale of 1:100.
 - To be read in conjunction with all PLBC drawings and information.

KEY

 Proposed layer of insulation are highlighted in blue.

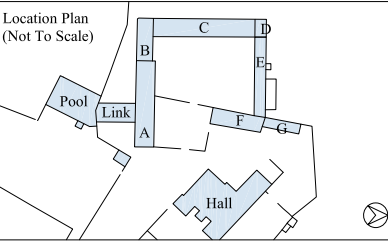

PLANNING ISSUE			
Rev	By	Date	Description
Drawing Number 9801 PLBC (2) 601			Rev ~
Project Aston Hall Barns Job No. 9801			
Title Proposals to Existing Barns: Typical Floor Build-up			
Drawn	GB	Checked	GQ
Date	08 2021	Scale	1:10 @ A3
Giles Quarme Architects Historic Building Architects & Consultants			
7 Bishops Terrace London SE11 4UE		020 7582 0748 www.quarme.com mail@quarme.com	