

**Notes**  
 This drawing is the copyright of Giles Quarme Architects and cannot be printed or reproduced without prior permission.  
 This drawing has been based on survey information provided by others.  
 All dimensions and setting out must be verified on site before commencement of the work, and any discrepancies notified to the architect.  
 All windows and doors are to fit into existing openings unless stated otherwise.  
 All dimensions are in millimetres unless stated otherwise.

- Drawing Notes:**
- Surveyed and drawn by James Brennan Associates Chartered Surveyors for Arrol Architects Ltd & GQA - Issue date December 2020 & July 2021.
  - Survey grid is OS GPS & levels are related to ordnance survey GPS datum.
  - Units are meters.
  - Survey accuracy with a scale of 1:100.

**SURVEY KEY**

AL	Arch height
BL	Beam level
CL	Ceiling level
EGS	Electrical Switch Gear
H	Floor to window head
RWP	Rain Water Pipe
SH	Arch spring height
S	Floor to window sill
sh	Sill to window head height

- SURVEY LEGEND**
- ← Stair/ slope arrows point up
  - Direction of floor boards
  - ↗ Direction of roof slope (up)
  - (2.06) Floor to Ceiling Height

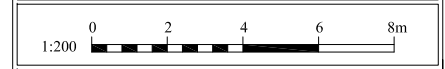
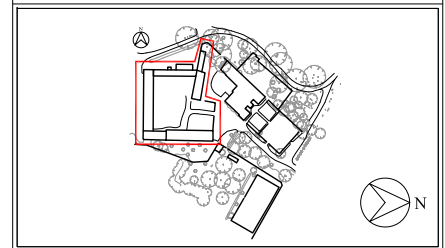

**PLANNING ISSUE**

Rev	By	Date	Description

Drawing Number	Rev
9801 S (0) 012	~

Project  
**Aston Hall Barns**  
 Job No. 9801

Title  
**General Arrangement Existing Survey:  
 Outbuildings - Second Floor Plan**

Drawn	GB	Checked	GQ
Date	02 2021	Scale	1:200 @ A3

**Giles Quarme Architects**  
*Historic Building Architects & Consultants*  
 7 Bishops Terrace London SE11 4UE  
 020 7582 0748  
 www.quarme.com  
 mail@quarme.com