



Notes
 This drawing is the copyright of Giles Quarme Architects and cannot be printed or reproduced without prior permission.
 This drawing has been based on survey information provided by others.
 All dimensions and setting out must be verified on site before commencement of the work, and any discrepancies notified to the architect.
 All windows and doors are to fit into existing openings unless stated otherwise.
 All dimensions are in millimetres unless stated otherwise.

KEY

- Property Boundary
- Current proposals' area

Location Plan (Not To Scale)

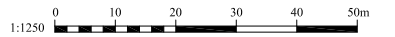
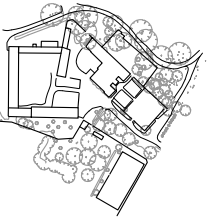

PLANNING ISSUE

Rev	By	Date	Description
A	DL	10.2021	OS Map Revised
B	DL	10.2021	OS Map Reference Number Added

Drawing Number 9801 L (0) 002	Rev B
----------------------------------	----------

Project
Aston Hall Barns
 Job No. 9801

Title
 Location Plan:
 Ordnance Survey 1:1250

Drawn GB	Checked GQ
Date 02 2021	Scale 1:1250 @ A3

Giles Quarme Architects
Historic Building Architects & Consultants

7 Bishops Terrace
 London
 SE11 4UE

020 7582 0748
 www.quarme.com
 mail@quarme.com



© Crown copyright and database rights 2021 OS 100035409
 Reference: O11501372
 Centre coordinates: 350966 286580