



23 Proposed new openings to 1st floor.



24 Rebuild modern timber floor.



25 Remove modern timber boarding.



26 Remove modern timber boarding to reinstate woven panels within the existing timber framing.



27 Remove modern lining to rediscover main truss & reinstate woven panels within the existing timber framing.



28 Remove modern false ceiling to rediscover double height and visible main trusses.

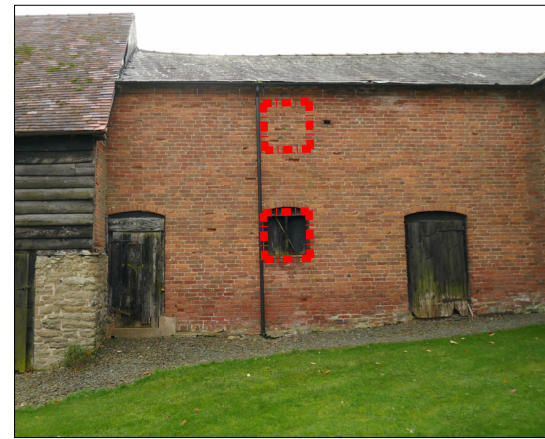

29 Proposed new opening matching GF.



30 Rediscover existing window.



31 Remove modern lining to rediscover existing opening to be provided with new glazed joinery.



32 Remove section of existing floor to install new staircase to access loft.



33 Remove timber partitioning.



34 Remove timber partitioning.



35 Proposed new opening matching adjacent to increase natural lighting.



36 Remove staircase to 1st floor and reconfigure partitions to install kitchen & bathroom.



37 New opening to connect Coach House & proposed new Media Room.



38 Remove existing garage roof to build new double pitched roof to accommodate Media Room.

Notes
This drawing is the copyright of Giles Quarme Architects and cannot be printed or reproduced without prior permission.
This drawing has been based on survey information provided by others.
All dimensions and setting out must be verified on site before commencement of the work, and any discrepancies notified to the architect.
All windows and doors are to fit into existing openings unless stated otherwise.
All dimensions are in millimetres unless stated otherwise.

- Drawing Notes:
- Surveyed and drawn by James Brennan Associates Chartered Surveyors for Arrol Architects Ltd & GQA - Issue date December 2020 & July 2021.
 - Survey grid is OS GPS & levels are related to ordnance survey GPS datum.
 - Units are meters.
 - Survey accuracy with a scale of 1:100.
 - To be read in conjunction with all PLBC drawings and information.

TO BE READ IN CONJUNCTION WITH DEMOLITIONS IF PLAN PLBC (0) 353:

- KEY
- Demolition / Removal
 - Reopening / alteration of existing opening
 - Property boundary
 - Corresponding photograph

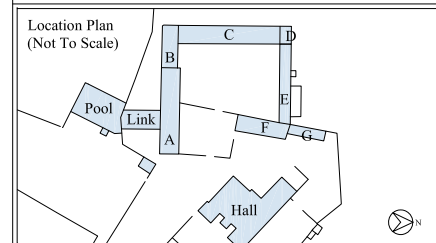

PLANNING ISSUE

Rev	By	Date	Description

Drawing Number
9801 PLBC (0) 354

Project
Aston Hall Barns
Job No. 9801

Title
Proposed Demolitions:
First Floor Plan - Photographs

Drawn GB Checked GQ
Date 08 2021 Scale NA

Giles Quarme Architects
Historic Building Architects & Consultants

7 Bishops Terrace London SE11 4UE
020 7582 0748
www.quarme.com
mail@quarme.com