



16 Remove traces of Dutch barn & re-landscape courtyard.



17 Reconfigure openings to create accessible accommodation at GF.



18 Remove staircase to 1st floor to create accessible accommodation at GF.



18 Remove internal partition and strip out kitchen to create accessible accommodation at GF.



19 Create new opening through blockwork diving Coach House & garage.



20 Rebuild stone & blockwork elevation to form Media Room.



20 Rebuild stone & blockwork elevation to form Media Room.

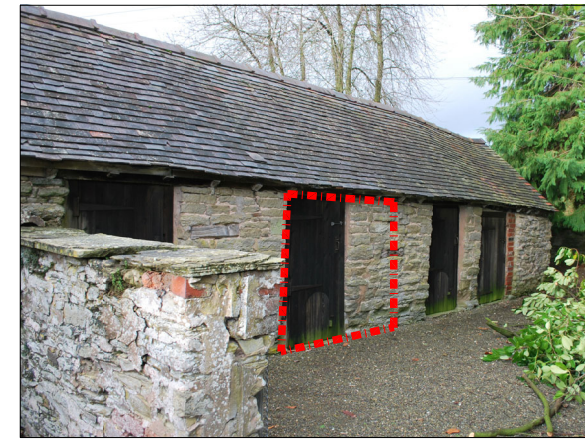

21 Widen opening & room to allow parking of gardening vehicles.



22 Re-landscape area next to modern kitchen extension to improve circulation & parking.

Notes
 This drawing is the copyright of Giles Quarme Architects and cannot be printed or reproduced without prior permission.
 This drawing has been based on survey information provided by others.
 All dimensions and setting out must be verified on site before commencement of the work, and any discrepancies notified to the architect.
 All windows and doors are to fit into existing openings unless stated otherwise.
 All dimensions are in millimetres unless stated otherwise.

- Drawing Notes:**
- Surveyed and drawn by James Brennan Associates Chartered Surveyors for Arrol Architects Ltd & GQA - Issue date December 2020 & July 2021.
 - Survey grid is OS GPS & levels are related to ordnance survey GPS datum.
 - Units are meters.
 - Survey accuracy with a scale of 1:100.
 - To be read in conjunction with all PLBC drawings and information.

TO BE READ IN CONJUNCTION WITH DEMOLITIONS GF PLAN PLBC (0) 350:

- KEY**
- Demolition / Removal
 - Reopening / alteration of existing opening
 - - - Property boundary
 - 07 Corresponding photograph

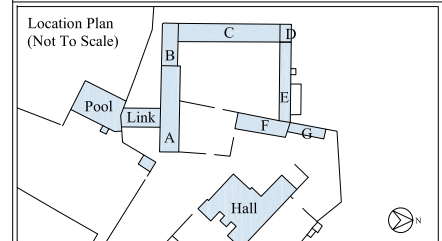

PLANNING ISSUE

Rev	By	Date	Description

Drawing Number	Rev
9801 PLBC (0) 352	~

Project
Aston Hall Barns
 Job No. 9801

Title
 Proposed Demolitions:
 Ground Floor Plan - Photographs

Drawn GB	Checked GQ
Date 08 2021	Scale NA

Giles Quarme Architects
 Historic Building Architects & Consultants

7 Bishops Terrace
 London
 SE11 4UE

020 7582 0748
 www.quarme.com
 mail@quarme.com