

Notes
 This drawing is the copyright of Giles Quarme Architects and cannot be printed or reproduced without prior permission.
 This drawing has been based on survey information provided by others.
 All dimensions and setting out must be verified on site before commencement of the work, and any discrepancies notified to the architect.
 All windows and doors are to fit into existing openings unless stated otherwise.
 All dimensions are in millimetres unless stated otherwise.

- Drawing Notes:**
- Surveyed and drawn by James Brennan Associates Chartered Surveyors for Arrol Architects Ltd & GQA - Issue date December 2020 & July 2021.
 - Survey grid is OS GPS & levels are related to ordnance survey GPS datum.
 - Units are meters.
 - Survey accuracy with a scale of 1:100.
 - To be read in conjunction with all PLBC drawings and information.

KEY

- Existing construction
- Proposed new opening within existing masonry
- Proposed new construction
- Proposed new internal insulation build-up
- Existing aperture opens to the elements to be provided with glazed joinery to improve natural lighting (J1)
- Existing opening with existing door/shutter to be made good/replaced & provided with glazed joinery behind to improve natural lighting (J2)
- Existing joinery to be made good/replaced matching existing (J3)
- New opening to be provided with glazed joinery to improve natural lighting (J4)

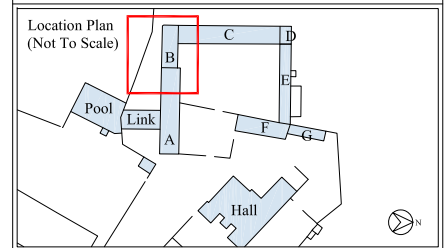

PLANNING ISSUE

| Rev | By | Date | Description |
|-----|----|------|-------------|
| | | | |

Drawing Number
9801 PLBC (0) 308

Project
Aston Hall Barns
 Job No. 9801

Title
**Proposed Barn A, B & C:
 First Floor Plan**

Drawn **GB** Checked **GQ**

Date **08 2021** Scale **1:100 @ A3**

Giles Quarme Architects
Historic Building Architects & Consultants

7 Bishops Terrace London SE11 4UE
 020 7582 0748
 www.quarme.com
 mail@quarme.com

