

- NOTE
- The information on this drawing has been derived in part from OS maps, and has been reproduced under OS License 100054890.
 - Tree positions and canopies are approximate.
 - The alignment of the public footpath on the north side of the church as shown is based on evidence on the ground, and varies slightly from that shown on the footpath map of the County Council.
 - The proposed footpath diversion is indicated by hatching.
 - Only the trees in immediate proximity to the church have been shown.

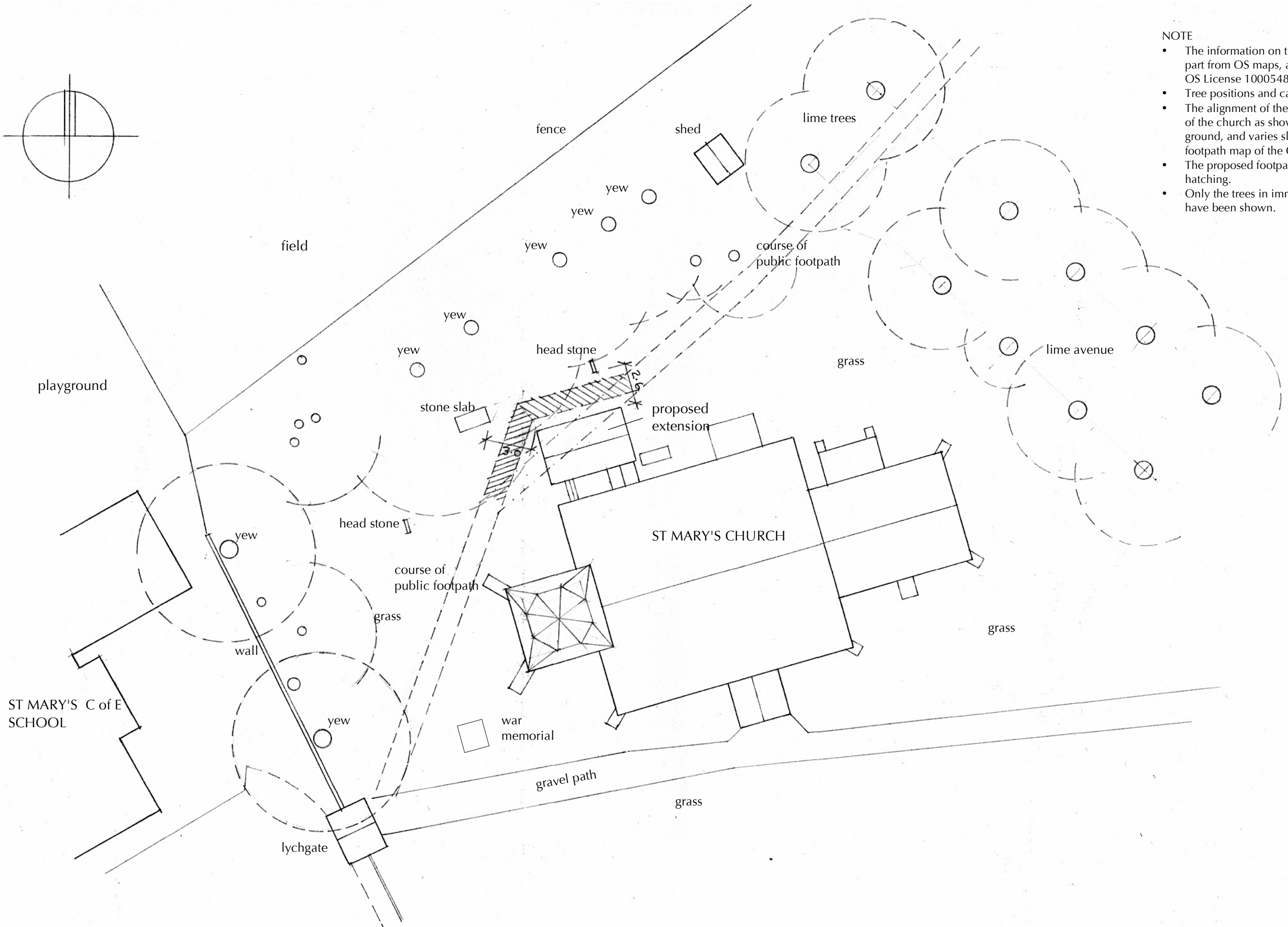

ST MARY'S C of E SCHOOL

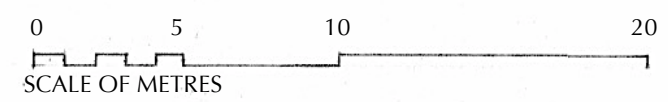

CHURCH OF ST MARY, BENTWORTH 218
New Facilities 218.1
Site Plan
1:250 @ A3
Drwg No 218.1 D01
September 2021