

Existing Ground Floor Plan 1:100

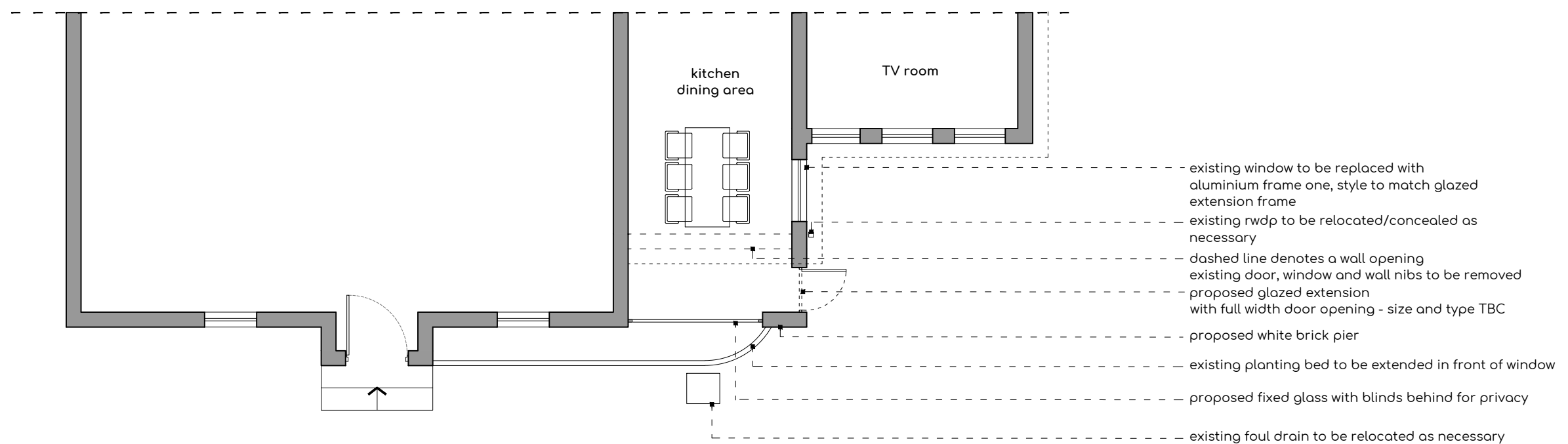

Proposed Ground Floor Plan 1:100



project	Pilgrims Way	
address	Brislands Lane Four Marks, Alton GU34 5AD	drawing Existing & Proposed Plans D-03
client	Mr & Mrs Batten	scale 1:100 @ A3
status	planning	date 15.09.2021

BLUNN. ARCHITECTS

NOTE: This drawing is to be scaled for planning purposes only