

LOCATION PLAN
SCALE DIAGRAMMATIC

| | | | | | |
|--|--|--|---------------------|-------------------|-------------|
|  | David Symonds Associates 3 Imperial Court, 12 Sovereign Road Kings Norton Business Centre, Birmingham B30 3ES Tel: 0121 444 1313 Email: eng@dsace.co.uk Website: www.dsace.co.uk | | Job No. 220902-S | | A3 |
| | | | Dwg No. 75 | Rev | P |
| | | | Date Oct 21 | Design | JDS |
| | | | Chkd | Drawn | SW |
| Contract | Bridgnorth Station Shop Refurbishment | | Scale AS SHOWN @ A3 | | |
| Title | Detail D6 - Pitched Roof Side / Existing Detail | | | | |
| DO NOT SCALE - ONLY FIGURED DIMENSIONS ARE TO BE USED.LEVELS TO BE CONFIRMED ON SITE | | | P | PLANNING APPROVAL | 12.10.21 SW |

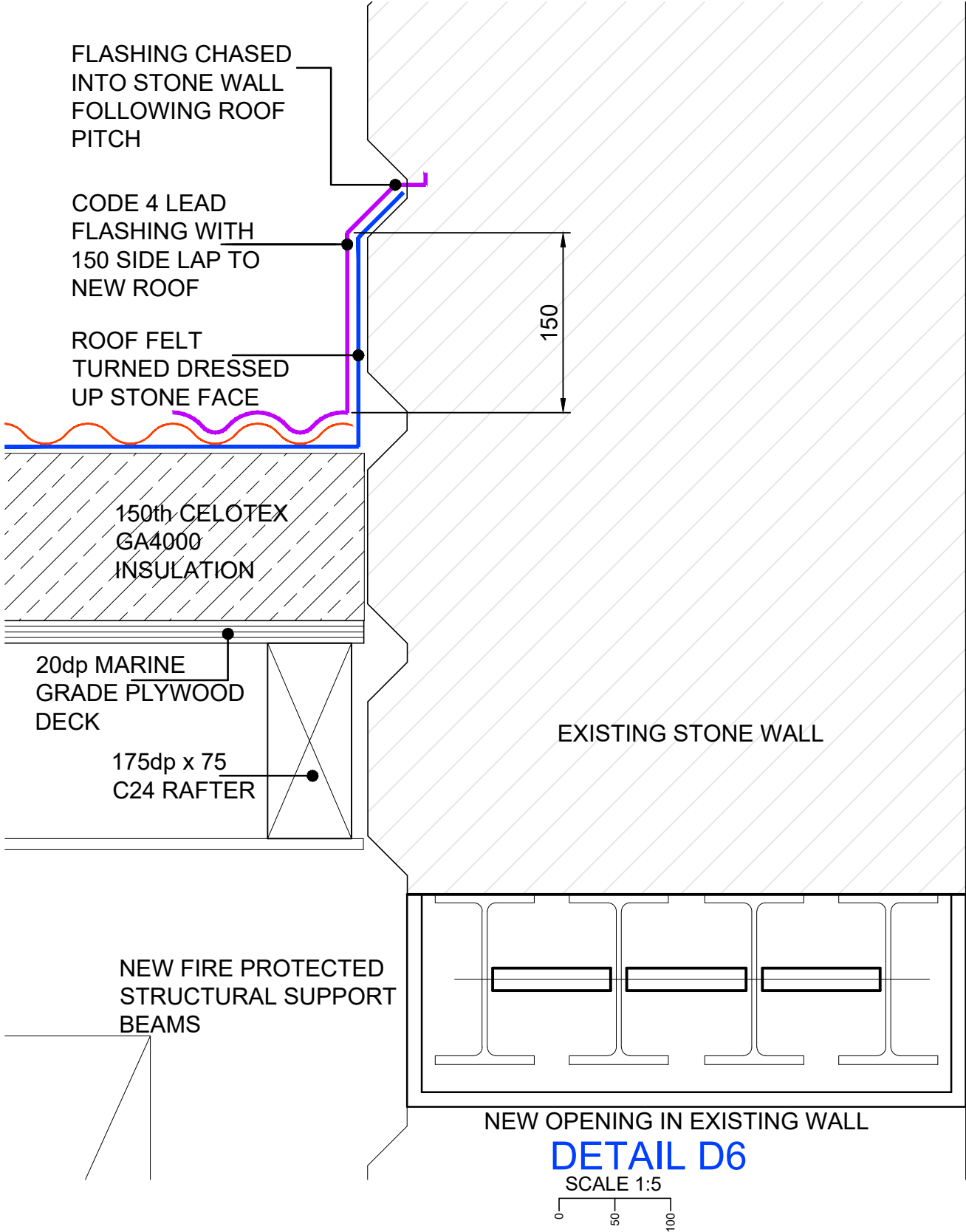

DETAIL D6

SCALE 1:5

ALL LEAD FIXED IN ACCORDANCE WITH LEAD DEVELOPMENT ASSOCIATION DETAILS

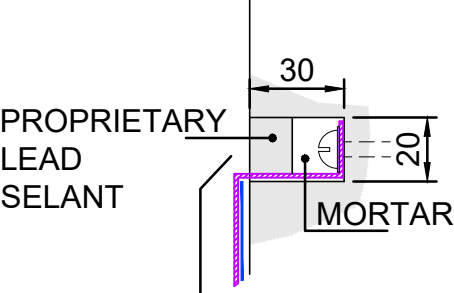

SAW CUT CHASE FORMED IN STONEWALL

ROOF FLASHING
DETAIL SECTION

SCALE 1:2

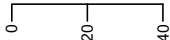

EXISTING SIDE FLASHING IMAGE