

Statement to support Certificate of Lawfulness Certificate application

Name – Ross Baker

General Manager Fountain Timber Products Ltd

I joined Fountain Timber Products Ltd in June 2000 when I was employed as a weekend yard server. I can confirm the following buildings on site were fully operational in their existing format at that time

- Joinery workshop (part of 9)
- Offices (17)
- Stake processing workshop (2)
- Engineering workshop (8)
- Retail/Trade counter (17)
- Treatment plants (6 & 17)

(Buildings identified on the building identification plans and numbered 1 to 24)

Plus various displays and wooden covered areas for stock.

Over my time here, these buildings have needed continuous repair and improvements. And through my 21 years' service on site I have witnessed a few developments to the site, namely;

- 1) Extensions to workshops including storage unit (9)
- 2) Expansion and tarmacing of car park area for staff and customers
- 3) Woodchip storage bunker for biomass (3)
- 4) Firewood / Timber chip storage extended for firewood drying to meet BSL requirements (1).
- 5) Adjustments completed to the sawmill to incorporate the biomass wood chipping line and drier identified as 'Building 4' on the building identification plans. This was complete in September 2017. This includes the final installation of the roof, all doors, and all windows necessary to continuously operate both the mill and chipping line.

(Buildings numbers 1-24 shown on the building identification plans enclosed)

Having worked on site for over 20 years, I have progressed from the yard to being involved with stock management and then worked as the buyer for the company. I now manage the site as General Manager and was involved in the planning and organising materials for developments numbered 3, 4 and 5 above,

I confirm the detail above is accurate.

Signed

Name

Date – 19th September 2021

Location Plan #1351601



Fountain Timber
Brockley Combe
Backwell
Bristol
BS48 3DF

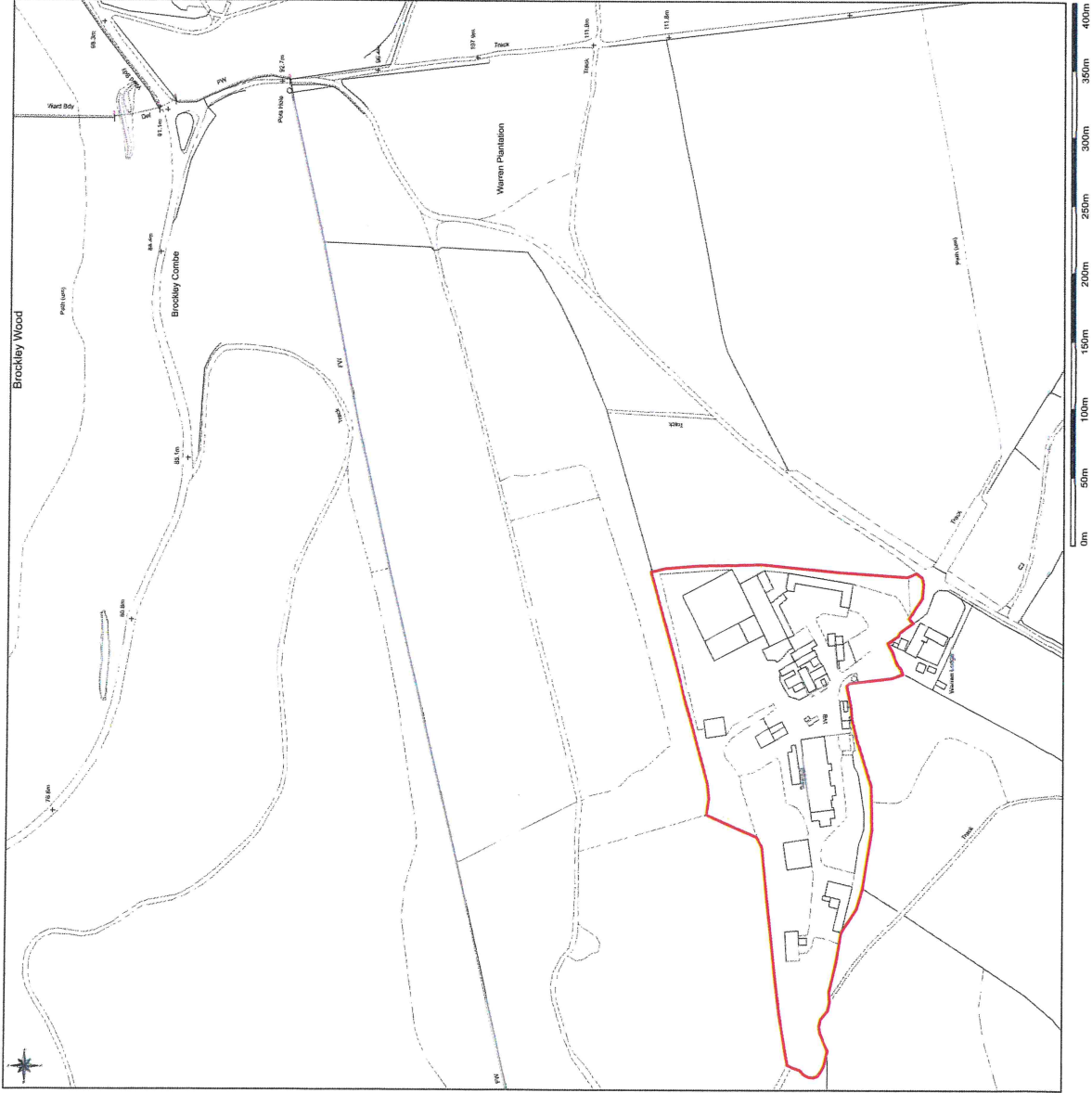

This data has been extracted from Ordnance Survey's 1:25,000 scale map (OS 100) and is not a substitute for a full scale of the map. It is not intended for use in navigation. The map is published under the Ordnance Survey Act 2003. The map is not intended for use in navigation. The map is published under the Ordnance Survey Act 2003. The map is not intended for use in navigation. The map is published under the Ordnance Survey Act 2003.

Scale: 1:2500, paper size, A2

Building Identification Plan

Fountain Timber Products Ltd
 Brockley Combe Road, Backwell BS48 3DF



Building Number/Current use(s) at Fountain Timber

- 1 Firewood /Timber Chip Storage
- 2 Round Timber Processing/Bark & Mulch Storage and Bagging Plant
- 3 Biomass Dry Timber Chip Storage
- 4 Sawmill/ Chipper/Biomass boiler/drier and Bunker
- 5 Drying Shed
- 6 Treatment Plant 1
- 7 Storage Containers x 3
- 8 Engineers workshop and stores
- 9 Warehouse + 2 x Workshops
- 10 Stock Store and Display Building
- 11 Stock Store and Display Building
- 12 Stock Store and Display Building
- 13 Mess hut/Toilets and open fronted Stock Store and display building

Building Number/Current use(s) at Fountain Timber

- 14 Stock Store and Display Building
- 15 Wiegbridge Office
- 16 Water Storage Tank
- 17 Main Offices/Trade Counter/Shop/Store and Timber treatment plant 2
- 18 Meeting Room
- 19 Meeter/Greeter Hut
- 20 Garage Canopy
- 21 Stock Store and Display Building
- 22 Garage Display/Store
- 23 Stock Store and Display Building
- 24 Stock Store and Display Building

Building number identification plan (page 2 of 3)



165800 N

165800 N

347900 E

348000 E

Notes

THIS PLAN IS THE PROPERTY OF SOHAM SURVEYING LTD. IT IS TO BE USED ONLY FOR THE PURPOSES SPECIFIED IN THE TITLE AND IS NOT TO BE REPRODUCED, COPIED, EITHER WHOLLY OR IN PART, OR TRANSMITTED IN ANY FORM OR BY ANY MEANS, ELECTRONIC OR MECHANICAL, INCLUDING PHOTOCOPYING, RECORDING, OR BY ANY INFORMATION STORAGE AND RETRIEVAL SYSTEM, WITHOUT THE WRITTEN PERMISSION OF SOHAM SURVEYING LTD. THE USER OF THIS PLAN ACCEPTS THAT SOHAM SURVEYING LTD. IS NOT RESPONSIBLE FOR ANY LOSS OR DAMAGE OF ANY KIND, INCLUDING NEGLIGENCE, ARISING FROM THE USE OF THIS PLAN.

KEY

A 5

BOUNDARIES

- Proposed Boundary
- Existing Boundary
- Proposed Fencing
- Existing Fencing
- Proposed Driveway
- Existing Driveway
- Proposed Path
- Existing Path
- Proposed Footpath
- Existing Footpath
- Proposed Cycleway
- Existing Cycleway
- Proposed Road
- Existing Road
- Proposed Railway
- Existing Railway
- Proposed Canal
- Existing Canal
- Proposed Watercourse
- Existing Watercourse
- Proposed Drain
- Existing Drain
- Proposed Sewer
- Existing Sewer
- Proposed Gas
- Existing Gas
- Proposed Electricity
- Existing Electricity
- Proposed Water
- Existing Water
- Proposed Sewage
- Existing Sewage
- Proposed Stormwater
- Existing Stormwater
- Proposed Other
- Existing Other

VEGETATION

- Proposed Planting
- Existing Planting
- Proposed Removal
- Existing Removal
- Proposed Preservation
- Existing Preservation
- Proposed Clearance
- Existing Clearance
- Proposed Retention
- Existing Retention
- Proposed New
- Existing New
- Proposed Old
- Existing Old
- Proposed Dead
- Existing Dead
- Proposed Living
- Existing Living
- Proposed Dead
- Existing Dead
- Proposed Living
- Existing Living

UTILITIES

- Proposed Gas
- Existing Gas
- Proposed Electricity
- Existing Electricity
- Proposed Water
- Existing Water
- Proposed Sewage
- Existing Sewage
- Proposed Stormwater
- Existing Stormwater
- Proposed Other
- Existing Other

OTHER

- Proposed Building
- Existing Building
- Proposed Structure
- Existing Structure
- Proposed Feature
- Existing Feature
- Proposed Object
- Existing Object
- Proposed Item
- Existing Item
- Proposed Detail
- Existing Detail
- Proposed Part
- Existing Part
- Proposed Section
- Existing Section
- Proposed Element
- Existing Element
- Proposed Component
- Existing Component
- Proposed Part
- Existing Part
- Proposed Section
- Existing Section
- Proposed Element
- Existing Element
- Proposed Component
- Existing Component

Coordinate Table

Station	Description	Easting	Northing	Level
5801	Control Point	347900.00	165800.00	100.00
5802	Control Point	347900.00	165800.00	100.00
5803	Control Point	347900.00	165800.00	100.00
5804	Control Point	347900.00	165800.00	100.00
5805	Control Point	347900.00	165800.00	100.00
5806	Control Point	347900.00	165800.00	100.00
5807	Control Point	347900.00	165800.00	100.00
5808	Control Point	347900.00	165800.00	100.00
5809	Control Point	347900.00	165800.00	100.00
5810	Control Point	347900.00	165800.00	100.00
5811	Control Point	347900.00	165800.00	100.00
5812	Control Point	347900.00	165800.00	100.00
5813	Control Point	347900.00	165800.00	100.00
5814	Control Point	347900.00	165800.00	100.00
5815	Control Point	347900.00	165800.00	100.00
5816	Control Point	347900.00	165800.00	100.00
5817	Control Point	347900.00	165800.00	100.00
5818	Control Point	347900.00	165800.00	100.00
5819	Control Point	347900.00	165800.00	100.00
5820	Control Point	347900.00	165800.00	100.00
5821	Control Point	347900.00	165800.00	100.00
5822	Control Point	347900.00	165800.00	100.00
5823	Control Point	347900.00	165800.00	100.00
5824	Control Point	347900.00	165800.00	100.00
5825	Control Point	347900.00	165800.00	100.00
5826	Control Point	347900.00	165800.00	100.00
5827	Control Point	347900.00	165800.00	100.00
5828	Control Point	347900.00	165800.00	100.00
5829	Control Point	347900.00	165800.00	100.00
5830	Control Point	347900.00	165800.00	100.00

Soham Surveying Ltd
 165800 N
 347900 E
 The Old Mill
 165800 N
 347900 E

CSJ Planning

Fountain Timber
 Backwell
 Bristol

Topographical Survey Sheet 2

Drawn	Checked	Date	Scale	Sheet	Total
UT01647	ER	16/05/2020	1:1000	2	2

Building number identification plan (page 3 of 3)

348000 E

347900 E

165900 N

165900 N



KEY

A 5

ABBREVIATIONS

BOUNDARIES

CONSTRUCTION

LEVELS

UTILITIES

VEGETATION

OTHER

COLOURS

SYMBOLS

NOTES

GENERAL

PLANNING

ENVIRONMENTAL

ARCHITECTURAL

LANDSCAPE

MECHANICAL

ELECTRICAL

PLUMBING

HEATING

Cooling

Lighting

Acoustic

Fire

Security

Accessibility

Health & Safety

Other

Station	Description	Easting	Northing	Level
1000	1000	1000	1000	1000
1001	1001	1001	1001	1001
1002	1002	1002	1002	1002
1003	1003	1003	1003	1003
1004	1004	1004	1004	1004
1005	1005	1005	1005	1005
1006	1006	1006	1006	1006
1007	1007	1007	1007	1007
1008	1008	1008	1008	1008
1009	1009	1009	1009	1009
1010	1010	1010	1010	1010
1011	1011	1011	1011	1011
1012	1012	1012	1012	1012
1013	1013	1013	1013	1013
1014	1014	1014	1014	1014
1015	1015	1015	1015	1015
1016	1016	1016	1016	1016
1017	1017	1017	1017	1017
1018	1018	1018	1018	1018
1019	1019	1019	1019	1019
1020	1020	1020	1020	1020
1021	1021	1021	1021	1021
1022	1022	1022	1022	1022
1023	1023	1023	1023	1023
1024	1024	1024	1024	1024
1025	1025	1025	1025	1025
1026	1026	1026	1026	1026
1027	1027	1027	1027	1027
1028	1028	1028	1028	1028
1029	1029	1029	1029	1029
1030	1030	1030	1030	1030
1031	1031	1031	1031	1031
1032	1032	1032	1032	1032
1033	1033	1033	1033	1033
1034	1034	1034	1034	1034
1035	1035	1035	1035	1035
1036	1036	1036	1036	1036
1037	1037	1037	1037	1037
1038	1038	1038	1038	1038
1039	1039	1039	1039	1039
1040	1040	1040	1040	1040
1041	1041	1041	1041	1041
1042	1042	1042	1042	1042
1043	1043	1043	1043	1043
1044	1044	1044	1044	1044
1045	1045	1045	1045	1045
1046	1046	1046	1046	1046
1047	1047	1047	1047	1047
1048	1048	1048	1048	1048
1049	1049	1049	1049	1049
1050	1050	1050	1050	1050
1051	1051	1051	1051	1051
1052	1052	1052	1052	1052
1053	1053	1053	1053	1053
1054	1054	1054	1054	1054
1055	1055	1055	1055	1055
1056	1056	1056	1056	1056
1057	1057	1057	1057	1057
1058	1058	1058	1058	1058
1059	1059	1059	1059	1059
1060	1060	1060	1060	1060
1061	1061	1061	1061	1061
1062	1062	1062	1062	1062
1063	1063	1063	1063	1063
1064	1064	1064	1064	1064
1065	1065	1065	1065	1065
1066	1066	1066	1066	1066
1067	1067	1067	1067	1067
1068	1068	1068	1068	1068
1069	1069	1069	1069	1069
1070	1070	1070	1070	1070
1071	1071	1071	1071	1071
1072	1072	1072	1072	1072
1073	1073	1073	1073	1073
1074	1074	1074	1074	1074
1075	1075	1075	1075	1075
1076	1076	1076	1076	1076
1077	1077	1077	1077	1077
1078	1078	1078	1078	1078
1079	1079	1079	1079	1079
1080	1080	1080	1080	1080
1081	1081	1081	1081	1081
1082	1082	1082	1082	1082
1083	1083	1083	1083	1083
1084	1084	1084	1084	1084
1085	1085	1085	1085	1085
1086	1086	1086	1086	1086
1087	1087	1087	1087	1087
1088	1088	1088	1088	1088
1089	1089	1089	1089	1089
1090	1090	1090	1090	1090
1091	1091	1091	1091	1091
1092	1092	1092	1092	1092
1093	1093	1093	1093	1093
1094	1094	1094	1094	1094
1095	1095	1095	1095	1095
1096	1096	1096	1096	1096
1097	1097	1097	1097	1097
1098	1098	1098	1098	1098
1099	1099	1099	1099	1099
1100	1100	1100	1100	1100

Sedum Surveying Ltd

11, The Quadrant, Bristol, BS1 1NA

CSJ Planning

Fountain Timber
Backwell
Bristol

Topographic Survey Sheet 3

Scale: 1:500
Date: 11/05/2021
Project: CSJ
Sheet: 3 of 3