

TITLE: PROP DORMER SECTION  
S/W FACING  
MR & MRS DUFFY  
8 CAIRNEY PL BONKLE M22900  
DATE: 01.03.21

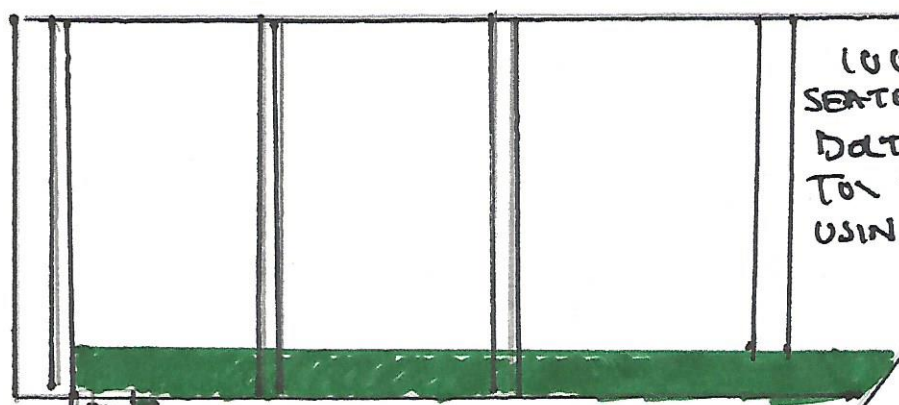

100x50 RIDGE INFILL  
SEATED ONTO 100x50 TIMBER  
BOLTED TO RAFTERS & BOLTED  
TO EXISTING RAFTERS  
USING 2x M12 BOLTS.

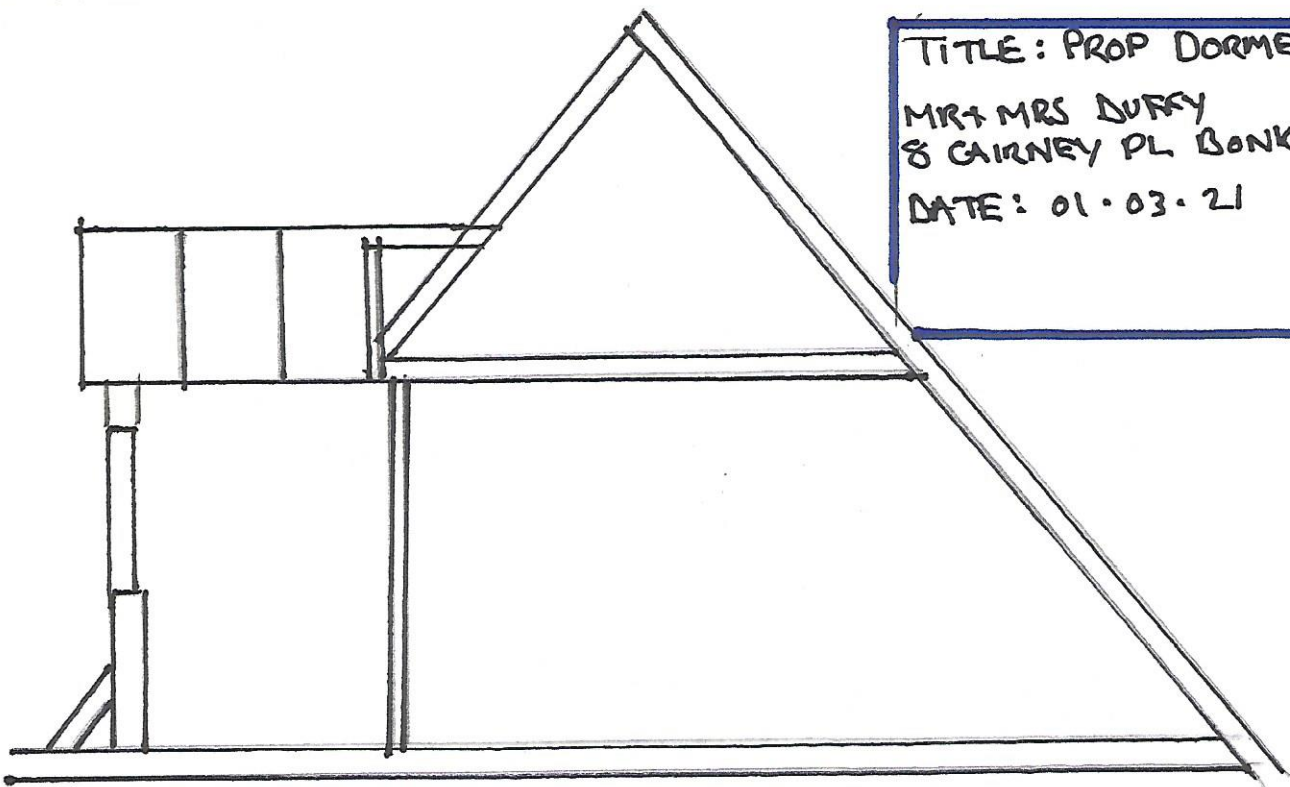

EXIST RAFTERS SEATED ONTO  
SIMPSON LSSU12.06 SLOPED  
HANGERS USING 3.75x30  
SQUARE TWIST NAILS

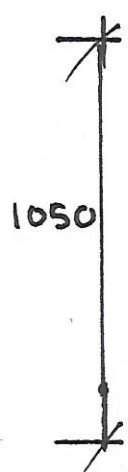

1050

ROOF U VALUE MAX 0.16  
CONCRETE TILES TO MATCH EXIST  
BATTONS 38x19mm  
EXT GRADE PLYWOOD  
CELOTEX XR4000 100mm / 0.2 W/M<sup>2</sup>K  
WALLS/CEILING. 12.5mm SQUARE PLS/BORD

50x100 C16 TIMBER  
STUDS @ 600mm c/c

DORMER SECTION 1/20 SCALE