

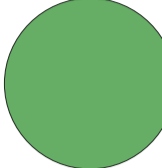

LEGEND

-  Existing building demolished
-  Approximate position of existing trees
-  Refuse/recyclable wheelie bins
-  Free draining surface (gravel)

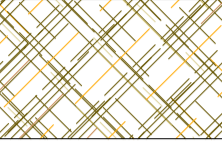
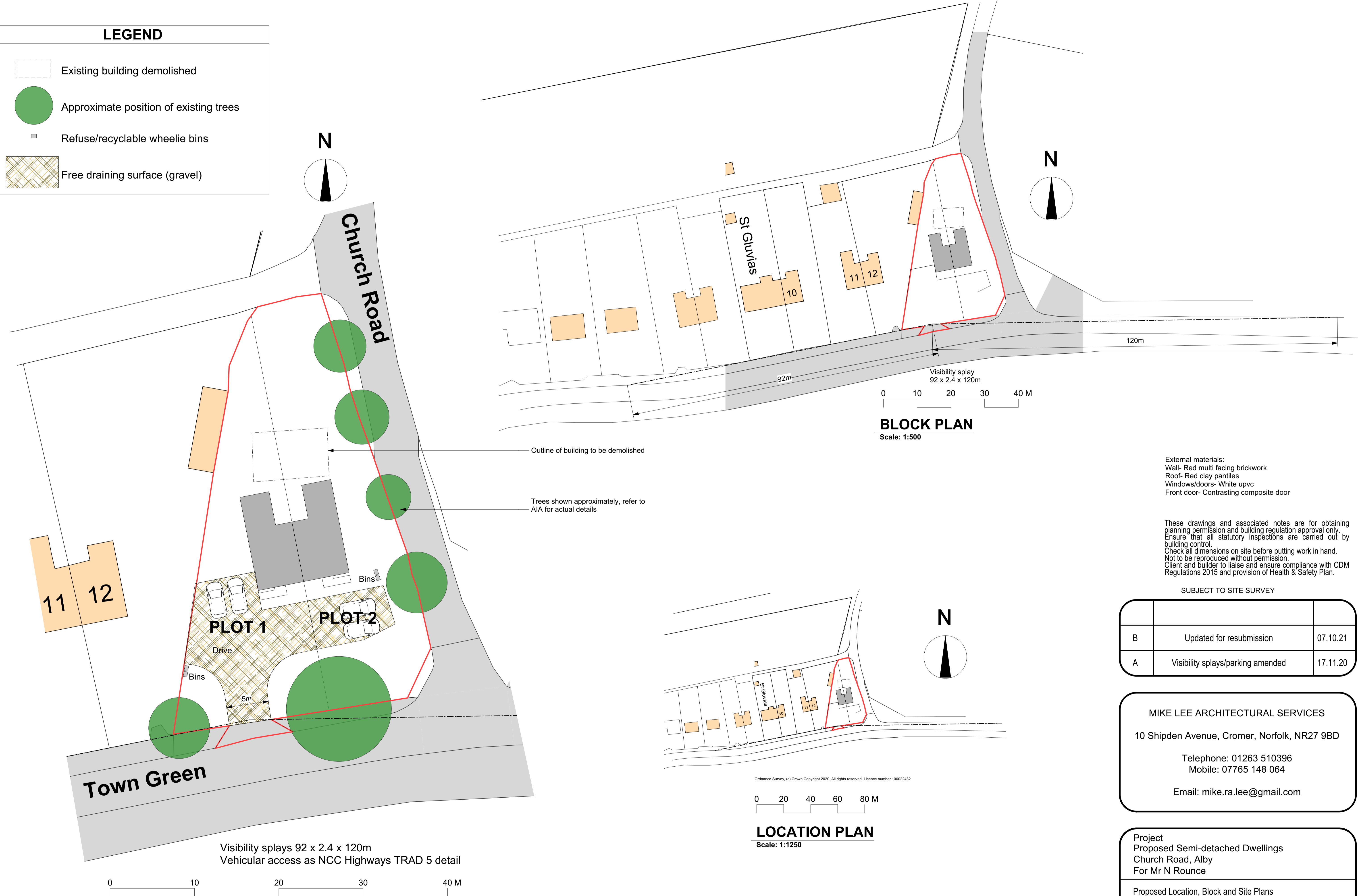

Outline of building to be demolished

Trees shown approximately, refer to AIA for actual details

External materials:
 Wall- Red multi facing brickwork
 Roof- Red clay pantiles
 Windows/doors- White upvc
 Front door- Contrasting composite door

These drawings and associated notes are for obtaining planning permission and building regulation approval only. Ensure that all statutory inspections are carried out by building control. Check all dimensions on site before putting work in hand. Not to be reproduced without permission. Client and builder to liaise and ensure compliance with CDM Regulations 2015 and provision of Health & Safety Plan.

SUBJECT TO SITE SURVEY

B	Updated for resubmission	07.10.21
A	Visibility splays/parking amended	17.11.20

MIKE LEE ARCHITECTURAL SERVICES
 10 Shipden Avenue, Cromer, Norfolk, NR27 9BD
 Telephone: 01263 510396
 Mobile: 07765 148 064
 Email: mike.ra.lee@gmail.com

Project
 Proposed Semi-detached Dwellings
 Church Road, Alby
 For Mr N Rounce

Proposed Location, Block and Site Plans

Date October 2020

Scale As Indicated @A1 Drawing ref: 2020/377 01B

BLOCK PLAN
 Scale: 1:500

LOCATION PLAN
 Scale: 1:1250

SITE PLAN
 Scale: 1:200

Visibility splays 92 x 2.4 x 120m
 Vehicular access as NCC Highways TRAD 5 detail

PLOT 1

PLOT 2

Drive

Bins

Bins

5m

Town Green

Church Road

St Gluvias

10

11

12

11

12

Ordnance Survey, (c) Crown Copyright 2020. All rights reserved. Licence number 100022432