

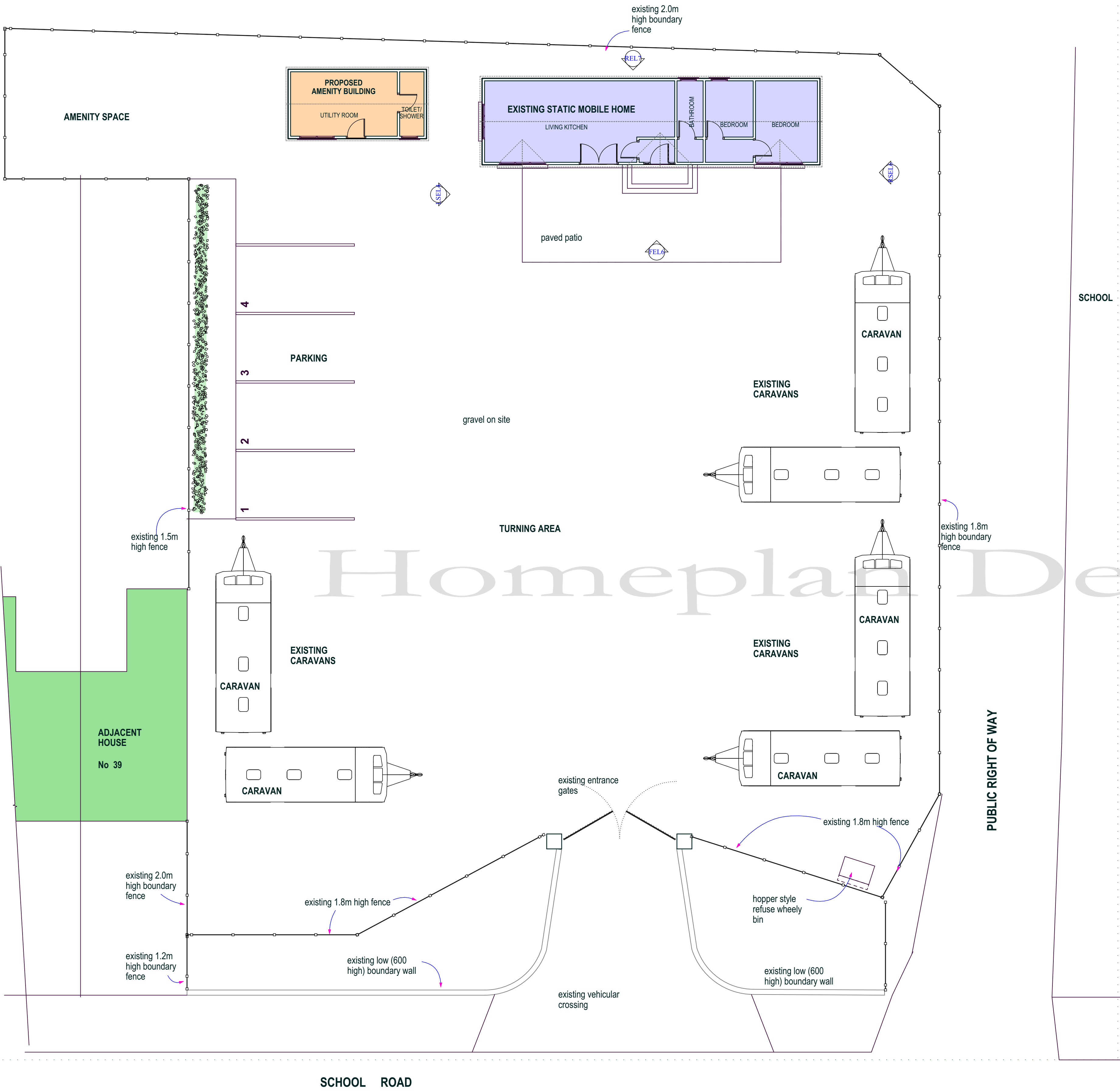

ADJACENT
CLUB HOUSE



0. EXISTING ground floor

1:100

REV A client changes SEP 21

*** Flood Risk assessment
The floor levels of the proposed extensions and building works will be no lower than the existing house/premises.
Also note the flood proofing of the proposed development has been considered by the applicant and will be incorporated where appropriate

PLANS

GENERAL NOTES
It is the responsibility of the Building Contractor to ensure that the work is carried out in a safe and satisfactory manner in accordance with the Health & Safety at Work Act 1974, CDM Regulations 1988, & where applicable the requirements of the CDM Regulations 1994.
Drawings are to approximate scale only and are to be read with associated documents.
Contractors MUST check proposals and are to bring any doubts or errors to architectural consultant's attention before proceeding.
NOTE that windows for openings being prepared on site must NOT be ordered by builder/client before they are finished, as the physical finished opening sizes can vary due to brick coursing.
All builders work must comply entirely with the current Building Regulations. Prior to start of work builder must be aware of any special planning conditions that may have been imposed by Council Planning Dept check APPROVAL DOCUMENTS.)
All electrical work required to meet the requirements of part P (electrical safety) will be designed, installed, respected and tested by a person competent to do so in accordance with BS 7671. A copy of the certificate should be forwarded to the council immediately following the completion of the electrical installation.
This plan & its specifications are copyright. Permission must be obtained from the above address before copying or using for any other purpose than it was originally drawn.
NO dimensions must be scaled from this drawing.

PROPOSED 2 STOREY HOUSE TO REPLACE EXISTING STATIC HOME PLANNING APPLICATION	CLIENT MR PETER ROGERS	
	DRAWING TITLE PLANS - EXISTING	
SITE STATLEY LODGE SCHOOL ROAD BLACKPOOL	SCALE 1:100, 1:76.76	DATE SEP 21
	DRAWING No HP 2897A PL / 21 / 07.3	REV ID