

GAMIA METAL SPIRAL STAIRCASE (1400mm)  
 PROPRIETARY ITEM PURCHASE THROUGH SPIRAL STAIRS DIRECT

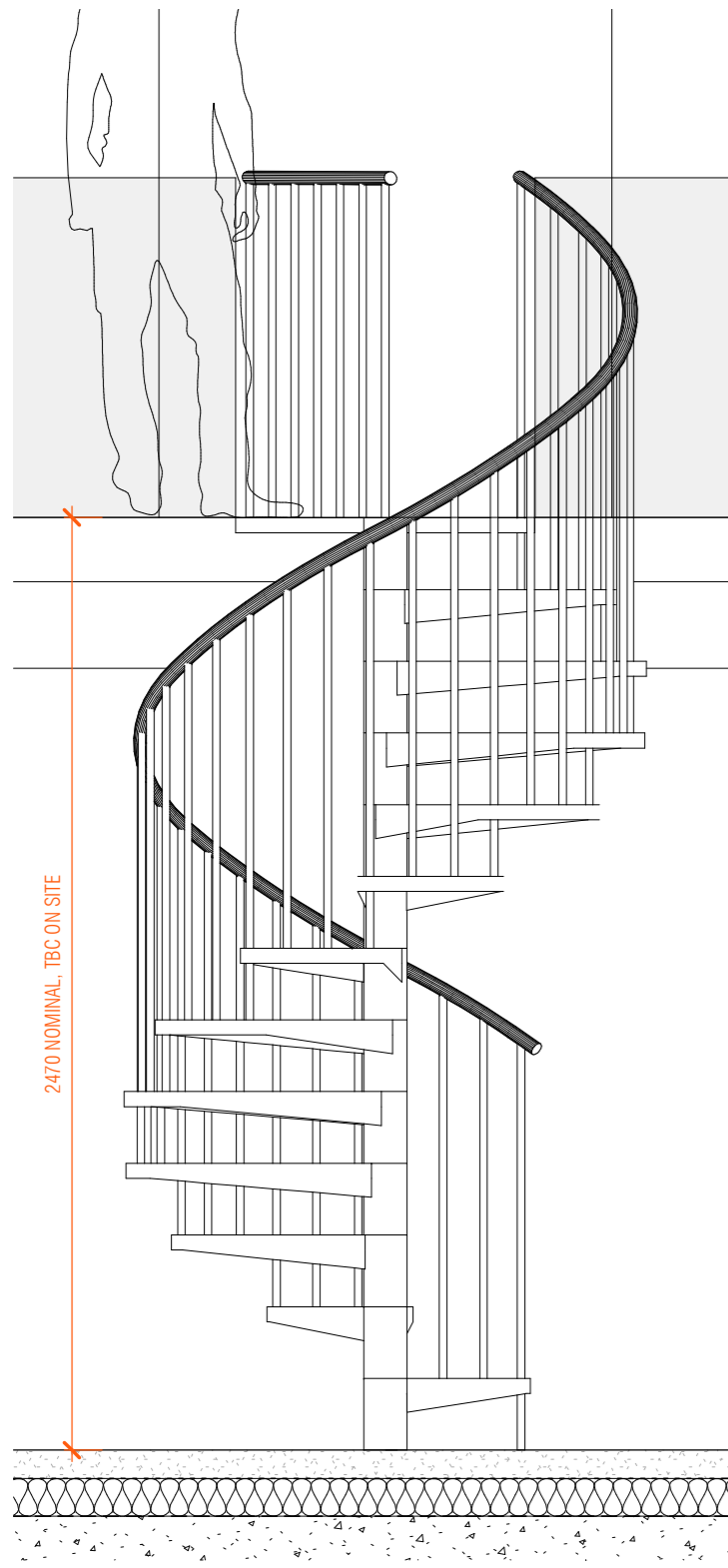

1 PROPOSED STAIRCASE SECTION  
 1:20

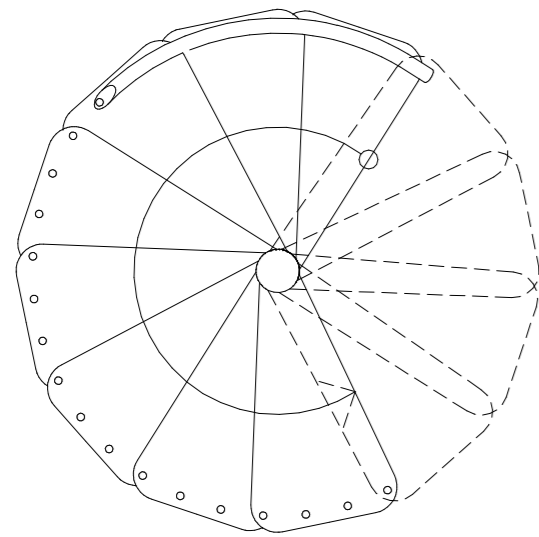

2 STAIRCASE PLAN (1400D)  
 1:20

SPIRAL STAIRCASES | GAMIA METAL MADE IN ITALY

---

### MATERIALS AND COLORS

**STEPS**

- In painted steel
- Maximum stability and mechanical strength
- Matt, scratch-proof, oven-dried epoxy powder coating
- Anti slip thanks to the strips on the steps

**HANDRAIL**

- In plastic material

**STRUCTURE**

- Composed of painted steel spacers on which the steps are welded
- Powder coated with matt scratch proof finish

**RAILING**

- Vertical columns in painted steel (distance between the columns less than 10 cm)

Steel colors (steps, structure and railing)

White RAL 9010	Grey Silver	Red RAL 3003	Blue RAL 5002	Green RAL 6000	Yellow RAL 1023	Black RAL 9055
-------------------	----------------	-----------------	------------------	-------------------	--------------------	-------------------

---

### CONFIGURATIONS

SQUARE OPENING

ROUND OPENING

UNIVERSAL LANDING WITH 60° OPENING: adaptable to any opening during installation.

---

### PACKAGE

**1 box = 1 complete staircase of 13 steps (landing included)**  
 Structure , steps, railing, handrail

The measures of the box may vary

---

### MEASUREMENTS

valid for all the configurations

The **SYSTEM FOR ADJUSTING THE HEIGHT BETWEEN THE STEPS (RISE)** allows you to:

- Obtain different heights between floors with the same number of steps.
- Obtain the height between the floors as required with more or fewer steps (this means you can find the best compromise between the step height and the space occupied by the staircase).

**ADJUSTABLE RISE**  
 Height between steps

Min. 21 cm  
 Max. 23 cm

During installation it is possible to adjust the rise by changing the height of the spacers

NUMBER OF STEPS	HEIGHT BETWEEN FLOORS (H)
10 steps <small>1 box</small>	Min. 210 cm Max. 230 cm
11 steps <small>1 box</small>	Min. 231 cm Max. 253 cm
12 steps <small>1 box</small>	Min. 252 cm Max. 276 cm
13 steps <small>1 box</small>	Min. 273 cm Max. 299 cm
14 steps <small>1 box + 1 extra step</small>	Min. 294 cm Max. 322 cm
15 steps <small>1 box + 2 extra steps</small>	Min. 315 cm Max. 345 cm
16 steps <small>1 box + 3 extra steps</small>	Min. 336 cm Max. 368 cm

**Add more steps to reach greater heights.**

- H = Finished floor to finished floor height.
- Top universal landing fixed at the same level as the finished upper floor.
- Ceiling opening diameter: staircase diameter + 5 cm.

---

**DIRECTION OF ASCENT**

Clockwise   Counter clockwise

**ACCESSORIES**

Extra step (with structure and railing).	Balustrade for upper floor (100 cm).	Extra section of internal post (needed for heights over 319 cm).

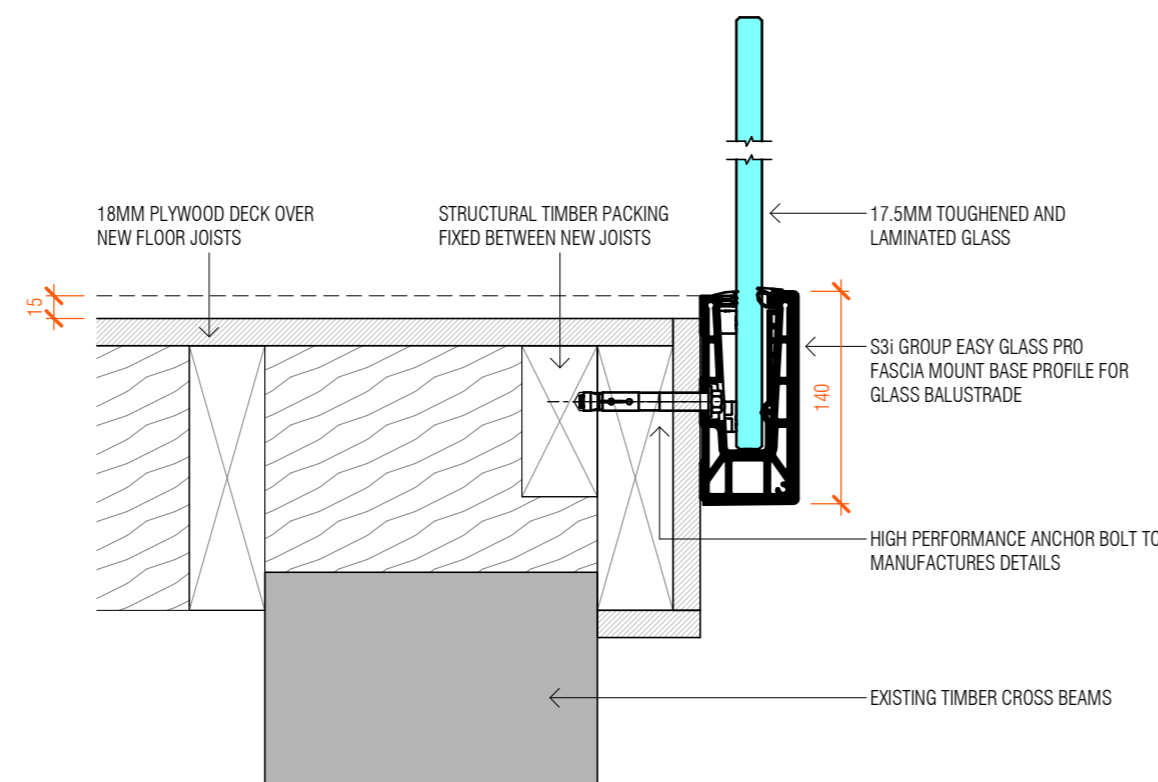

3 GLASS BALUSTRADE DETAIL/FIXING  
 1:5

ISSUE DATE  
 THESE DRAWINGS, PLANS AND SPECIFICATION ARE THE COPYRIGHT AND PROPERTY OF MAUDE + EDWARDS ARCHITECTS AND MUST NOT BE USED, REPRODUCED OR COPIED WHOLLY OR IN PART WITHOUT THE WRITTEN PERMISSION OF MAUDE + EDWARDS ARCHITECTS. ALL RIGHTS RESERVED.

**VAN DIJK**  
 CLIENT  
**GRANGE FARM**  
 PROJECT  
 POTASH LANE, IP14 4SL  
 SITE ADDRESS  
**STAIRCASE DETAILS**  
 DRAWING TITLE  
 SKETCH DESIGN (SD)  
 PROJECT STAGE

maude + edwards  
 architects

SCALE: As indicated @A2

2017.PL 902

DRAWN BY: BE