

LEFT HAND SIDE ELEVATION

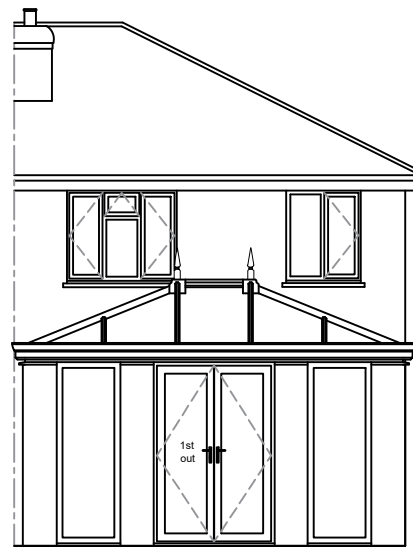

REAR ELEVATION



RIGHT HAND SIDE ELEVATION

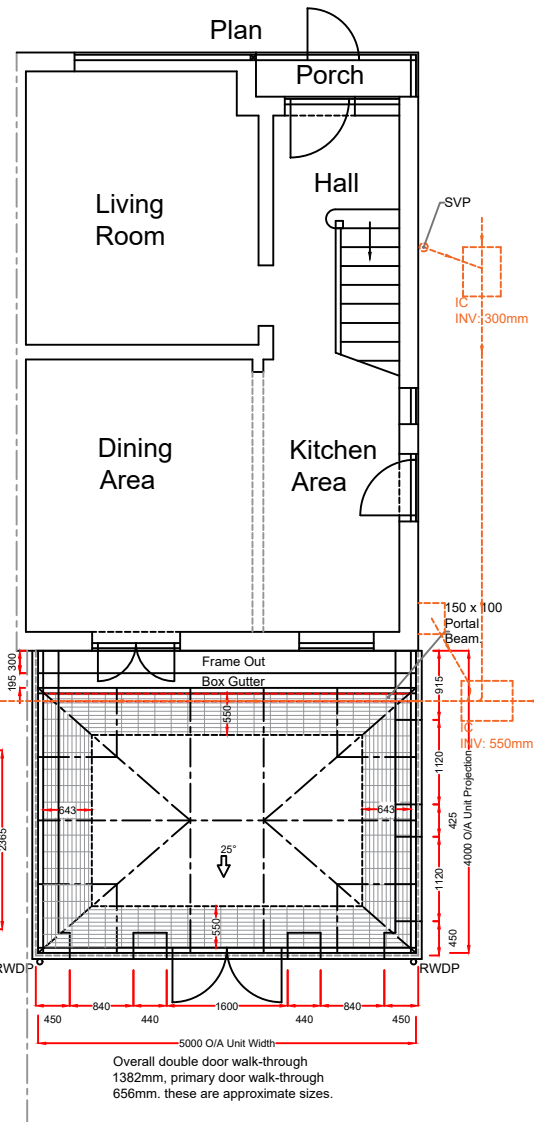

New Physical Barrier Viewed internally from house.

Manufacture sizes	W 1155	H 2365
Product type	White PVCu Double Doors	
Sill type/colour	None	
Frame colour out	White	
Frame colour in	White	
Ventilators	Standard	
Handle details	Chrome	
Door threshold	Mobility	
Door opening	Out	
Glass type	Clear Ultra 2	

= Internal Pelmet.

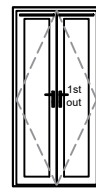

Overall double door walk-through 1382mm, primary door walk-through 656mm, these are approximate sizes.

Product Specification:
Roof:
 Roof Type: Aluminium Rafter with PVCu Capping
 Roof Glazing: Solarroof Glass
 Obscure Glass: N/A
 Orangerie Type: Anglian Pelmet
 Roof external colour: WHITE
 Roof internal colour: WHITE

Frames/Doors:
 Frame type: High Impact PVCu Mainframe
 External Colour: WHITE
 Internal Colour: WHITE

A.	12/10/21	Pelmet 550mm changed to increase side pelmets.	PN



Drawing title: **Proposed Plan and Elevations**

Contract No. : **900/08675** | **Page 2 of 2**

Proposed: **PVCu Orangerie**
 At: **12 SOUTHVILLE CLOSE**
EPSOM
SURREY
KT19 9RB

Drawers initials: **PN** | Scale : **1:100** | Date: **05/10/21**

Notes:
 Any drawings or plans depicted make no allowance for the provision of any tie bars within the roof of the proposed Living space. This can only be determined once the roof is put into manufacture.
 Knockthrough and new physical barrier by Anglian
 These drawings are the property of Anglian Home Improvements and must not be used, distributed, loaned or copied without the express permission of Anglian Home Improvements.
 All dimensions are in millimetres (mm) unless noted otherwise.
 Do not use for base laying purposes
 Produced on A3 paper

