

THIS DRAWING IS BASED ON DIMENSIONAL SURVEY INFORMATION PROVIDED BY OTHERS. THE ARCHITECT CANNOT ACCEPT RESPONSIBILITY FOR THE ACCURACY OF THIS SURVEY INFORMATION.
 THIS DRAWING SHOULD BE READ IN CONJUNCTION WITH ALL RELEVANT DRAWINGS, SPECIFICATIONS, SCHEDULES AND OTHER CONTRACT INFORMATION ISSUED BY THE ARCHITECT, STRUCTURAL ENGINEER, SERVICES ENGINEER AND ANY OTHER CONSULTANT EMPLOYED OR RETAINED BY THE EMPLOYER IN RESPECT OF THESE WORKS.
 REPORT ANY DISCREPANCIES, CONFLICTS, ERRORS OR OMISSIONS TO THE CA AND SEEK DIRECTIONS BEFORE PROCEEDING.
 ONLY DRAWINGS SHOWN WITH STATUS 'CONSTRUCTION' ARE TO BE USED FOR CONSTRUCTION.
 DO NOT SCALE FROM THIS DRAWING; USE ONLY FIGURED DIMENSIONS. IN THE CASE OF NEW WORKS, ALL DIMENSIONS SHOWN ARE TO THE FACE OF MASONRY, THE CENTRE LINE OF STRUCTURAL STEEL MEMBERS, OR THE FINISHED FACE OF STUD PARTITIONS, UNLESS NOTED OTHERWISE.
 CONFIRM ALL DIMENSIONS AND LEVELS ON SITE PRIOR TO COMMENCING WORK. IF IN DOUBT ASK!
 THIS DRAWING REMAINS THE COPYRIGHT OF BURRELL FOLEY FISCHER LLP

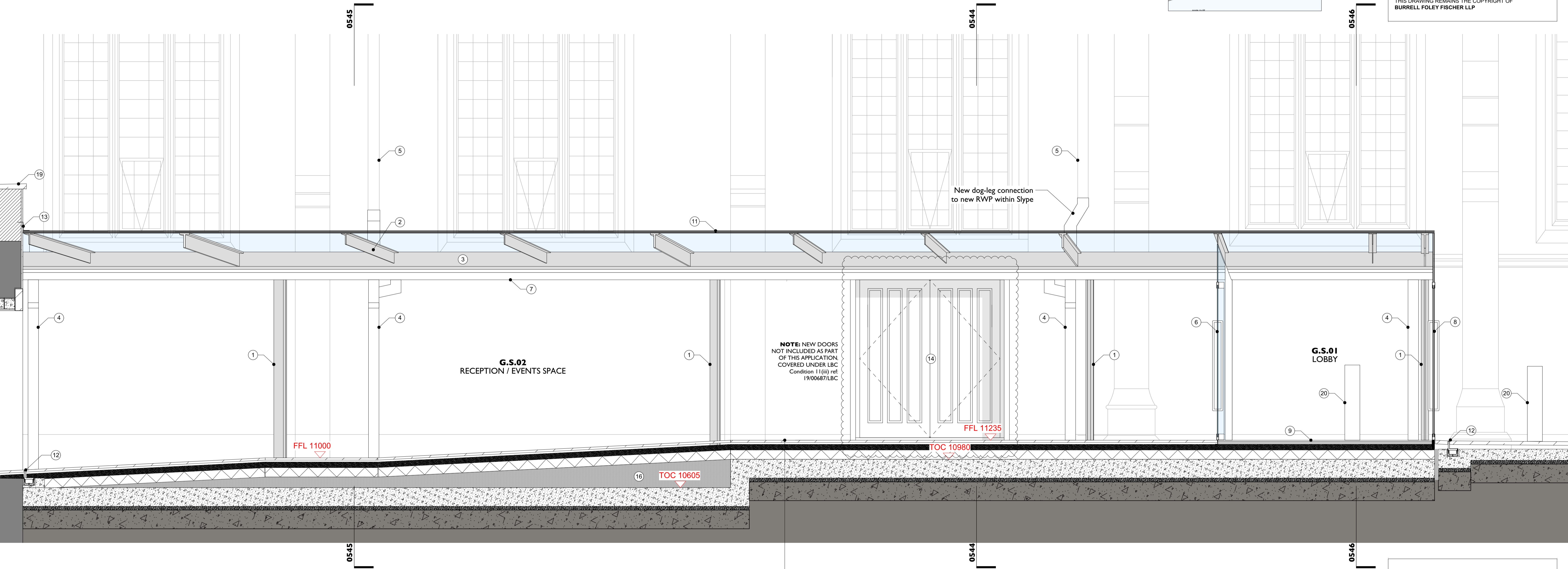

NOTE: NEW DOORS NOT INCLUDED AS PART OF THIS APPLICATION. COVERED UNDER LBC Condition 1 (iii) ref 19/00687/LBC

New dog-leg connection to new RWP within Slype

- Key**
- STEEL 'T-SECTION' (200mm H x 100mm W) PORTAL FRAME PPC IN ANTHRACITE
 - STEEL 'T-SECTION' (150mm H x 100mm H) BEAM PPC IN ANTHRACITE
 - STEEL RHS PPC IN ANTHRACITE
 - NEW DOWNPIPES COMBINE GUILDHALL AND SLYPE SPACE DRAINAGE PPC IN ANTHRACITE
 - EXISTING GUILDHALL DOWNPIPES RETAINED AND SHORTENED, CONNECTED VIA NEW LEAD COLOURED ALUMINIUM SLEEVED CONNECTION (RAL COLOUR TBC) TO NEW STAINLESS STEEL RWP WITHIN SLYPE SPACE VIA NEW LEAD. NEW DOG LEG CONNECTION IN ONE LOCATION AS NOTED ON DRAWING.
 - SINGLE GLAZED PIVOTING DOOR WITH POWERED ACTIVATION MOUNTED IN FLOOR
 - LINE OF NEW GUTTER WITH PPC ALUMINIUM PRESSING INTERNALLY IN ANTHRACITE
 - DOUBLE GLAZED PIVOTING DOOR WITH POWERED ACTIVATION MOUNTED IN FLOOR
 - RECESSED MATWELL TO LOBBY WITH UNDERFLOOR HEATING
 - YORKSTONE FLOOR FINISH TO SLYPE WITH UNDERFLOOR HEATING. BUILD UP AS NOTED ON DRAWING.
 - NEW STRUCTURAL GLAZING TO ENCLOSE SLYPE
 - NEW CONCEALED DRAINAGE SLOT
 - STEPPED CODE 4 LEAD FLASHING TO ABUTMENT

- NEW DOORWAY FORMED IN EXISTING WALL OF THE GUILDHALL WITH NEW DOUBLE DOORS
- WALL MOUNTED CONTROL GEAR FOR POWERED DOOR ACTIVATION FINAL LOCATION TBC
- STRUCTURAL FOAM VOID VILLER TO FORM RAMPS AS PER S.E. INFORMATION
- NEW FLASHING
- NEW CAST IRON DOWNPIPE TO MATCH EXISTING
- NEW CAST BATH STONE COPING REQUIRED TO ATKINSON BLOCK. NOTING EXISTING COPING STONES HAVE CAUSED SIGNIFICANT DAMAGE TO MASONRY BELOW DUE TO THEIR WEIGHT AND LACK OF DRIP DETAIL TO EITHER SIDE OF THE PARAPET. HENCE THE REPLACEMENT REQUIRED.
- ACCESS CONTROL BOLLARD HOUSING DOOR ENTRY EQUIPMENT

SLYPE SPACE FLOOR BUILD UP:
 30mm YORK STONE PAVING
 25mm BEDDING ZONE
 75mm SCREED WITH UFH
 125mm RIGID INSULATION
 250mm CONCRETE SLAB TO S.E. SPEC
 SUBBASE TO S.E. SPEC

NOTE: THE PURPOSE OF BFF'S DRAWINGS IS TO SHOW THE REVISED SLYPE SPACE DESIGN IN CONTEXT. REFER TO ARUP HERITAGE'S INFORMATION FOR DETAILS AND DETAIL LOCATIONS.
 ELEMENTS/ AREAS OF DRAWING NOT INCLUDED WITHIN THIS APPLICATION HAVE BEEN GREYED OUT WHERE POSSIBLE FOR CLARITY.

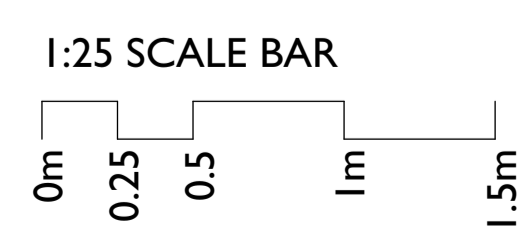

REVISED SLYPE SPACE DESIGN ISSUED FOR VARIATION/REMOVAL OF PLANNING AND LISTED BUILDINGS CONDITIONS JKFD 15/09/2020

PLANNING & LBC

BURRELL FOLEY FISCHER
 ARCHITECTS AND URBAN DESIGNERS

STUDIO 9 · 14 SOUTHGATE ROAD · LONDON · N1 5LY TEL: 020 7620 6114
 45 NEWHALL STREET · BIRMINGHAM · B3 3QR TEL: 0121 213 6364
 www.bff-architects.co.uk mail@bff-architects.co.uk

JOB: YORK GUILDHALL COMPLEX

FOR: CITY OF YORK COUNCIL

AT: THE GUILDHALL YORK

DRAWING TITLE: SOUTH RANGE LONGITUDINAL SECTION 4 - SLYPE

DATE: 02.10.17 SCALE: 1:25@A1
 JOB NO: BFF/1321 DRAWN BY: AR CHECKED BY: AR
 DWS NO: YGH-BFF-Z5-ZZ-M2-A-0543 .P1

Copyright