

**DO NOT SCALE**

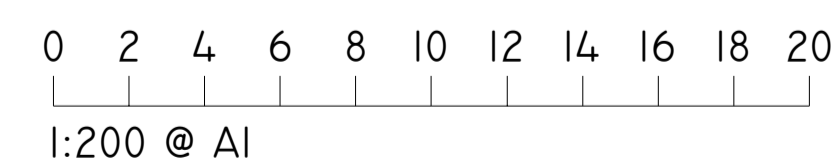
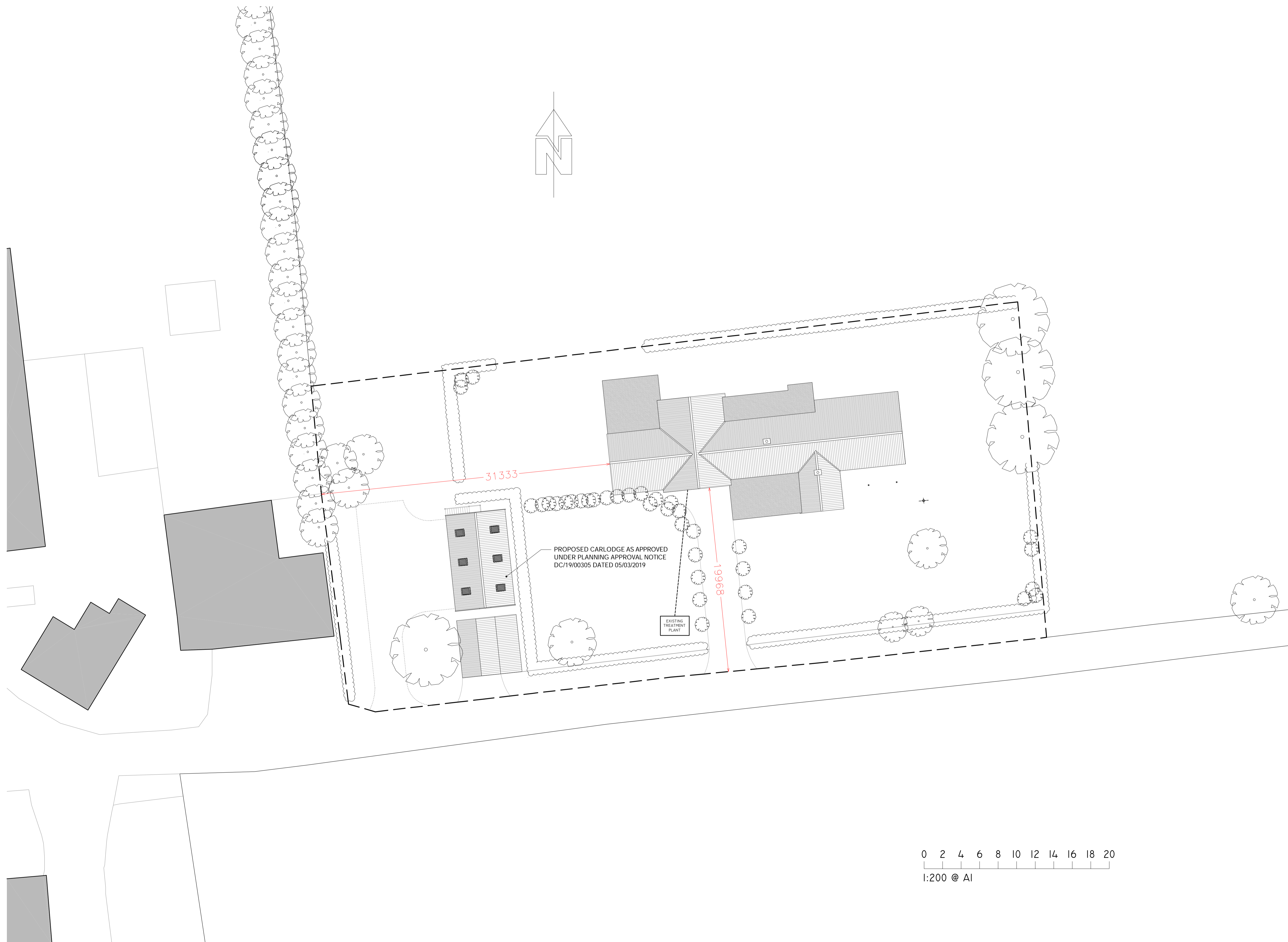

**NOTES**

NO DIMENSIONS ARE TO BE TAKEN FROM THIS DRAWING

THIS DRAWING MUST NOT BE REPRODUCED IN PART OR IN FULL WITHOUT THE WRITTEN CONSENT OF THE DESIGNER

ALL DIMENSIONS ARE TO BE CHECKED ON SITE AND ANY DISCREPANCIES ARE TO BE REPORTED TO THE DESIGNER PRIOR TO ANY CONSTRUCTION WORK TAKING PLACE

CONTRACTORS MUST VERIFY ALL FIGURED DIMENSIONS AT THE SITE BEFORE COMMENCING ANY WORK OR MAKING SHOP DRAWINGS

THIS DRAWING IS TO BE READ IN CONJUNCTION WITH ALL OTHER RELEVANT DRAWINGS, SPECIFICATIONS & ENGINEERS DETAILS

ALL CONSTRUCTION & MATERIALS TO COMPLY WITH THE CURRENT BUILDING REGULATIONS AND BRITISH STANDARDS.

JOHN DENNY ASSOCIATES CAN NOT BE HELD RESPONSIBLE FOR CONSTRUCTION PRACTICE & QUALITY WHERE WE ARE NOT APPOINTED TO OVERSEE AND PROJECT MANAGE ON SITE CONSTRUCTION.

Rev.	Date	Description	Checked
A	08-10-2021	PLANNING ISSUE	J.A.D.

**JOHN DENNY ASSOCIATES**  
ARCHITECTURAL DESIGNS

architecture · design · planning · surveys · feasibility

43 OALTON ROAD  
IPSWICH  
SUFFOLK  
IP1 1DD  
TEL/FAX: 01473 20888  
MOB: 07773 92888  
E CONTACT@JOHNDENNYASSOCIATES.CO.UK  
W JOHNDENNYASSOCIATES.CO.UK

**Client**

MR. K. BRATCH & MRS T. HALL  
WHITE OAK  
NORWICH ROAD  
MENEDESHAM  
STONMARKET  
SUFFOLK  
IP14 5NE

**Project**

PROPOSED FRONT, SIDE AND REAR EXTENSIONS TO EXISTING SINGLE STOREY DETACHED DWELLING INCLUDING INTERNAL AND EXTERNAL STRUCTURAL ALTERATION WORKS

**Location**

WHITE OAK, NORWICH ROAD, MENEDESHAM  
STONMARKET, SUFFOLK, IP14 5NE

**Drawing**

PROPOSED SITE PLAN

Drawn	Date	Scale
JAD	SEPT 2021	1:200 @ A1

Drawing Number	Revision
0284 - PL-005	A