

**DO NOT SCALE**

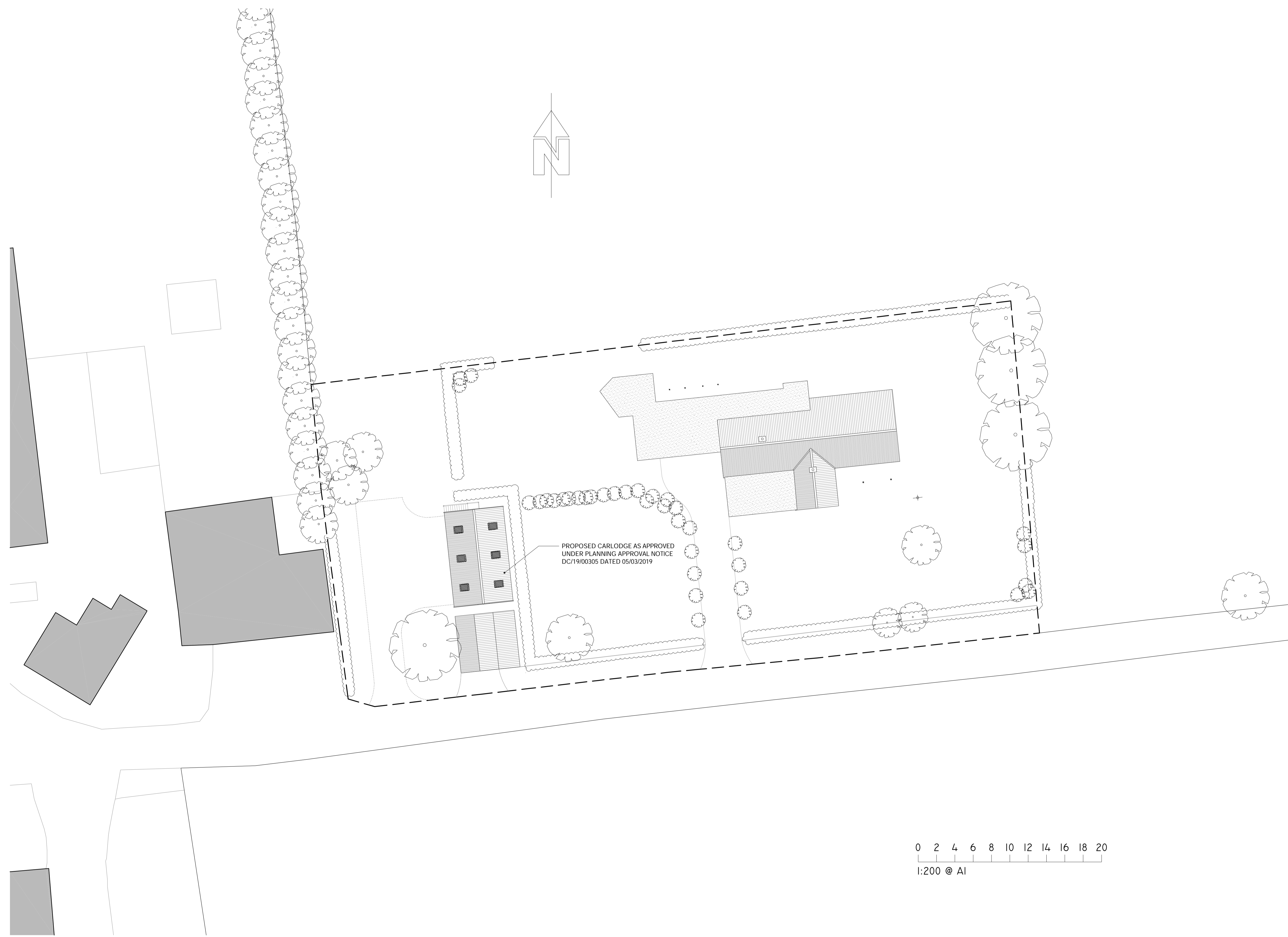

PROPOSED CAR LODGE AS APPROVED UNDER PLANNING APPROVAL NOTICE DC/19/00305 DATED 05/03/2019

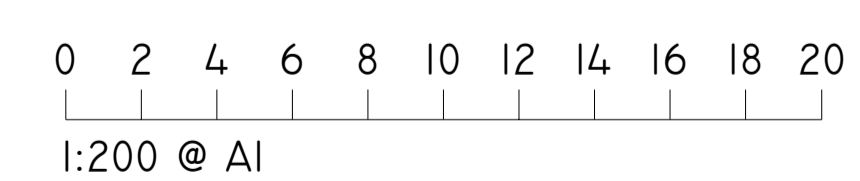

**NOTES**  
 NO DIMENSIONS ARE TO BE TAKEN FROM THIS DRAWING  
 THIS DRAWING MUST NOT BE REPRODUCED IN PART OR IN FULL WITHOUT THE WRITTEN CONSENT OF THE DESIGNER  
 ALL DIMENSIONS ARE TO BE CHECKED ON SITE AND ANY DISCREPANCIES ARE TO BE REPORTED TO THE DESIGNER PRIOR TO ANY CONSTRUCTION WORK TAKING PLACE  
 CONTRACTORS MUST VERIFY ALL FIGURED DIMENSIONS AT THE SITE BEFORE COMMENCING ANY WORK OR MAKING SHOP DRAWINGS  
 THIS DRAWING IS TO BE READ IN CONJUNCTION WITH ALL OTHER RELEVANT DRAWINGS, SPECIFICATIONS & ENGINEERS DETAILS  
 ALL CONSTRUCTION & MATERIALS TO COMPLY WITH THE CURRENT BUILDING REGULATIONS AND BRITISH STANDARDS.  
 JOHN DENNY ASSOCIATES CAN NOT BE HELD RESPONSIBLE FOR CONSTRUCTION PRACTICE & QUALITY WHERE WE ARE NOT APPOINTED TO OVERSEE AND PROJECT MANAGE ON SITE CONSTRUCTION.

Rev.	Date	Description	Checked
A	08-10-2021	PLANNING ISSUE	J.A.D.

**JOHN DENNY ASSOCIATES**  
 ARCHITECTURAL DESIGNS  
 architecture · design · planning · surveys · feasibility

43 OAKTON ROAD  
 IPSWICH  
 SUFFOLK  
 IP1 1DD  
 TEL/FAX: 01473 20888  
 MOB: 07773 92888  
 E CONTACT@JOHNDENNYASSOCIATES.CO.UK  
 W JOHNDENNYASSOCIATES.CO.UK

**Client**  
 MR. K. BRATCH & MRS T. HALL  
 WHITE OAK  
 NORWICH ROAD  
 MENDELISHAM  
 STONMARKET  
 SUFFOLK  
 IP14 5NE

**Project**  
 PROPOSED FRONT, SIDE AND REAR EXTENSIONS TO EXISTING SINGLE STOREY DETACHED DWELLING INCLUDING INTERNAL AND EXTERNAL STRUCTURAL ALTERATION WORKS

**Location**  
 WHITE OAK, NORWICH ROAD, MENDELISHAM  
 STONMARKET, SUFFOLK, IP14 5NE

**Drawing**  
 EXISTING SITE PLAN

**Drawn**  
 JAD

**Date**  
 SEPT 2021

**Scale**  
 1:200 @ A1

**Drawing Number**  
 O284 - PL-003

**Revision**  
 A