

**MARK
DYSON**
SURVEYORS LTD
(01392) 833828

BARN CONVERSION AND NEW VILLAGE HOUSE
at
TRELASH FARM TRELASH, DAVIDSTOW PL15 8RL

PLAN TYPE	Proposed Block / Site Plan
DATE	10.8.21
SCALE	1 : 250 / A3
REF	TM765a+b.P1c V3
NOTES	

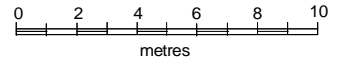

N

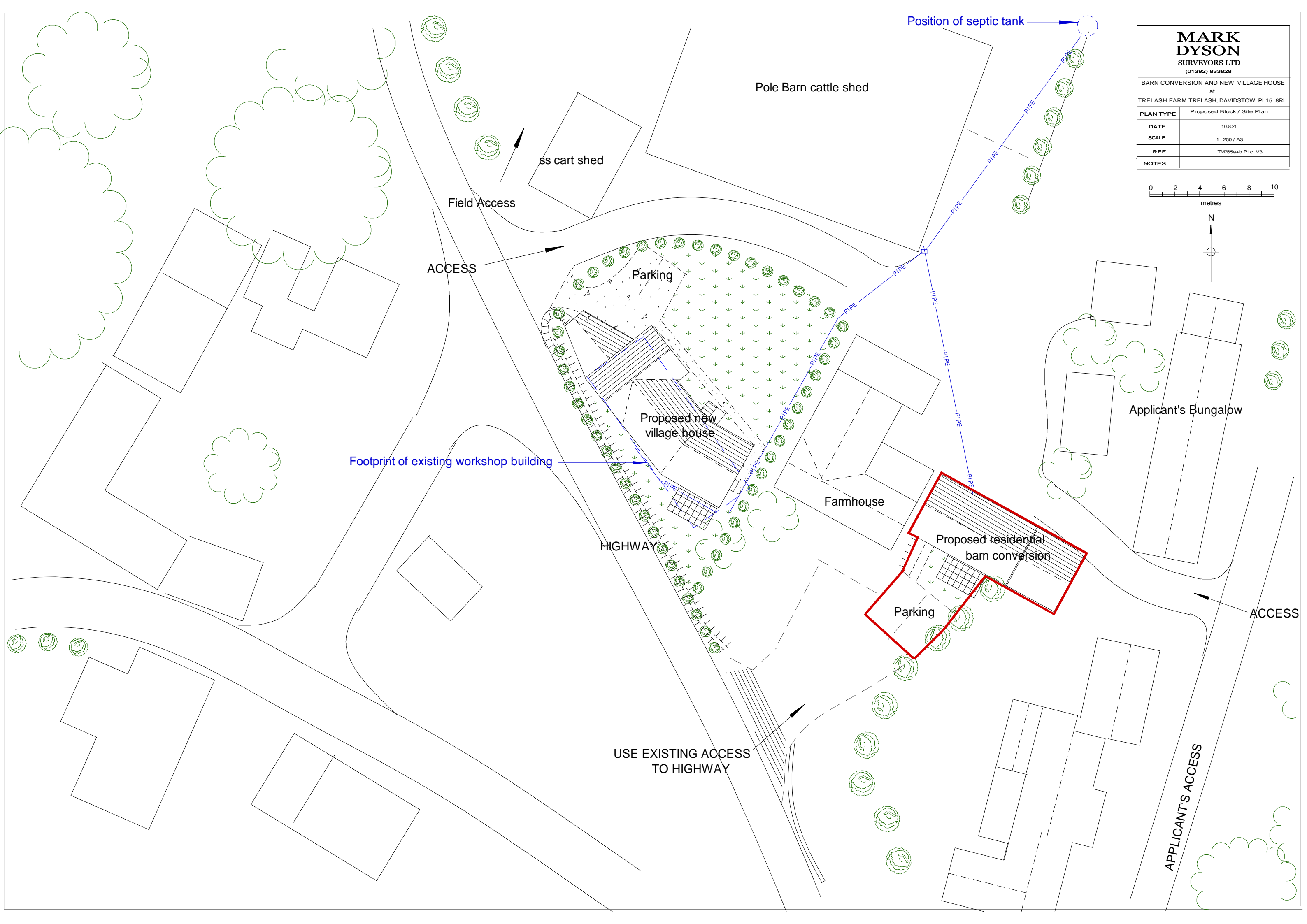

ss cart shed

Pole Barn cattle shed

Field Access

ACCESS

Parking

Proposed new village house

Footprint of existing workshop building

HIGHWAY

Farmhouse

Proposed residential barn conversion

Parking

Applicant's Bungalow

ACCESS

USE EXISTING ACCESS TO HIGHWAY

APPLICANT'S ACCESS

Position of septic tank