





KEY

-  Existing Wall
-  New Wall
-  Removed Wall
-  Structure Over



General Note: All windows to be re-glazed with slim line double glazed units

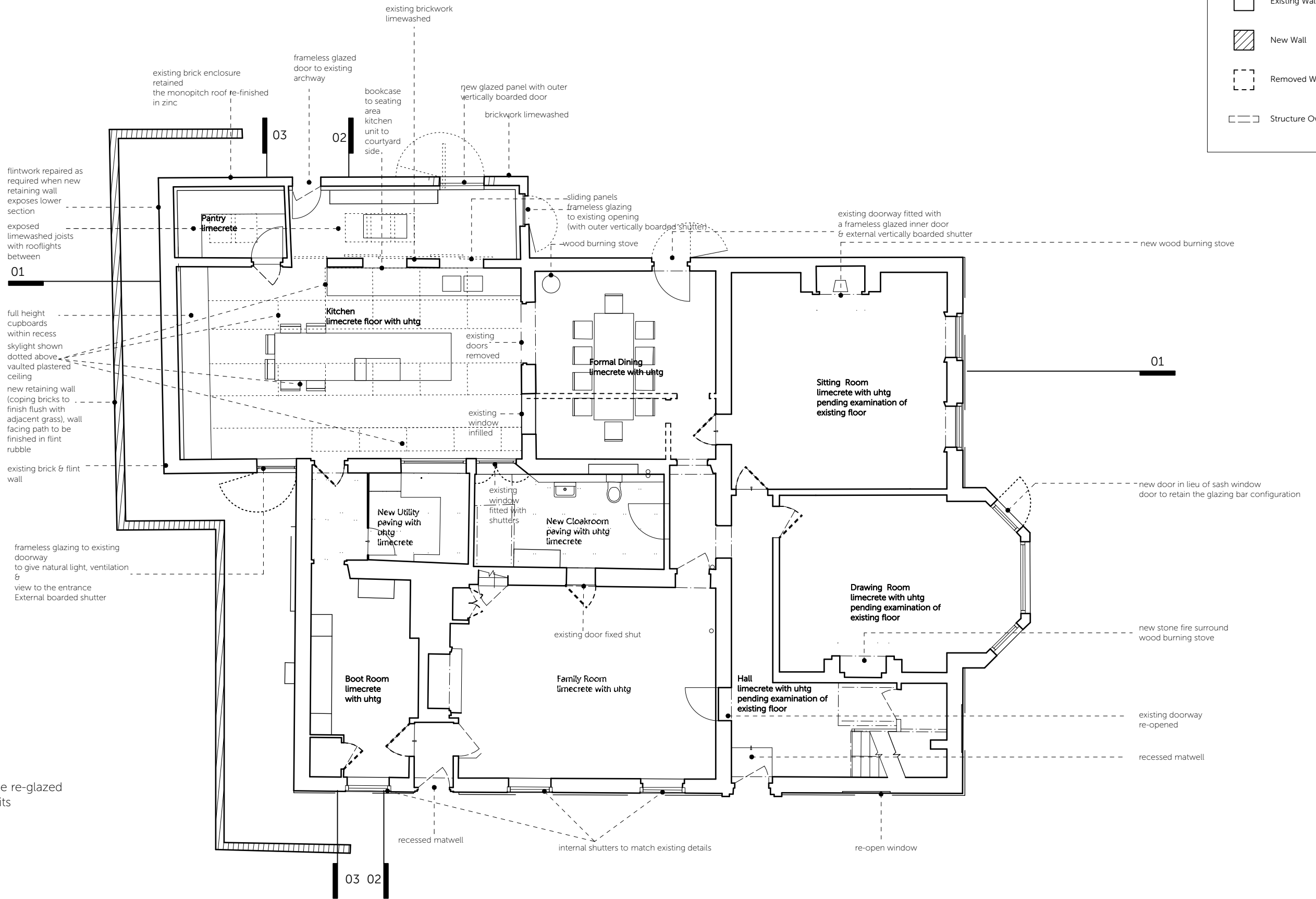
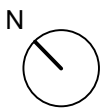

Proposed Ground Floor Plan
Scale 1:100 @ A3



DO NOT SCALE FROM THIS DRAWING AND CHECK ALL DIMENSIONS ON SITE
THIS DRAWING IS TO BE READ IN CONJUNCTION WITH ALL OTHER RELEVANT INFORMATION FROM OTHER CONSULTANTS

REV	DATE	NOTES
P1	03/12/2020	Draft Issue for Client
P2	20/12/2020	Alterations following meeting with client 2020-12-08
P3	24/03/2021	Revised scheme following pre-app comments
P4	18/06/2021	Revised scheme following meeting with planning dept. 2021-06-07
P5	15/07/2021	Minor Amendments
P6	10/09/2021	Minor amendments following comments from conservation officer 2021-07-29

DRAWN	PROJECT	TITLE
MS/KL	Old Rectory North Barsham Alterations to a grade II listed house	Proposed Ground Floor Plan Planning/Listed Building Submission
CHECKED	SCALE @ A1 1:50 / @ A3 1:100 DATE October 2020	NO 2024 / 101 REV P6

cowper griffith architects

COWPER GRIFFITH ARCHITECTS LLP
15 HIGH STREET WHITTLESFORD CAMBRIDGE CB22 4LT
www.cowpergriffith.co.uk