

HM Land Registry

9

7

Form LCCI (Local Land Charges Rules 1977 Schedule 1, Form C)

Official Number 232
(To be completed by the registering authority)

The duplicate of this form must also be completed;
a carbon copy will suffice

For directions, notes and fees see overleaf

Register of local land charges

Requisition for search and official certificate of search

Insert name and address of registering authority in space below

Tendring District Council
Local Land Charges
Council Offices
Thorpe Road
Weeley
Clacton On Sea
Essex. CO16 9AJ

Requisition for search

(A separate requisition must be made in respect of each parcel of land except as explained overleaf)

An official search is required in Part(s) _____ of the register of local land charges kept by the above-named registering authority for subsisting registrations against the land [defined in the attached plan]¹ described below.

Description of land sufficient to enable it to be identified

Sunnyside Cansey Lane, Bradfield, Manningtree

Shown on attached plan edged red

Name and address to which certificate is to be sent

NAIRNSEY FISHER & LEWIS
105 LONDON ROAD
BENFLEET, ESSEX SS7 5TG
DX: 48950 BENFLEET

Signature of applicant (to be signed)

NAIRNS [redacted] & LEWIS

Date
7.7.95

Telephone number

Reference
BM/17943/RAWLINGS

Enclosure
Cheque/Money Order/Pick Note/Other £73.00

To be completed by authorised officer

Official certificate of search

It is hereby certified that the search requested above reveals ~~no subsisting registrations~~

or the 3 registrations described in the Schedule hereto² up to and including the date of the certificate.

Signature [redacted]

On behalf of TENDRING DISTRICT COUNCIL

Date
25 JUL 1995

- 1 Delete if inappropriate. Otherwise insert Part(s) in which search is required.
- 2 Delete if inappropriate (A plan should be furnished in duplicate if it is desired that a copy should be returned.)

- 3 Delete inapplicable words. (The Parts of the Schedule should be securely attached to the certificate and the number of registrations disclosed should be inserted in the space provided. Only Parts which disclose subsisting registrations should be sent.)

- 4 Insert name of registering authority.

17/04/27

PART 3 Planning Charges

(a) Notices deposited under Section 158 of the Town and Country Planning Act 1971				
1 Description of charge (including particulars of planning decision)	2 Originating Authority	3 Particulars of Compensation and Apportionment	4 Place where relevant documents may be inspected	5 Date Registered

(b) Other Planning Charges															
1 Description of Charge (including reference to appropriate Statutory provision)	2 Originating Authority	3 Place where relevant documents may be inspected	4 Date of Registration												
Revocation Order under Section 45 of the Town and Country Planning Act 1971, revoking planning permissions TEN/42/54 and TEN/135/53. Erection of detached dwelling. (Superceded by Sec. 69 T & C Planning Act 1990). Conditions imposed on the following Planning Permissions (Details shown in Register of Planning Applications kept under Section 34, Town and Country Planning Act, 1971)	Essex County Council	County Hall Chelmsford.	28.6.73.												
<table border="0"> <tr> <td style="text-align: center;"><u>Numbered</u></td> <td style="text-align: center;"><u>Dated</u></td> <td></td> <td></td> </tr> <tr> <td style="text-align: center;">TEN/514/89</td> <td style="text-align: center;">14.4.89</td> <td>Tendring District Council</td> <td>Council Offices Weeley</td> </tr> <tr> <td style="text-align: center;">TEN/820/90</td> <td style="text-align: center;">27. 7.90</td> <td style="text-align: center;">"</td> <td style="text-align: center;">"</td> </tr> </table>	<u>Numbered</u>	<u>Dated</u>			TEN/514/89	14.4.89	Tendring District Council	Council Offices Weeley	TEN/820/90	27. 7.90	"	"			26.5.89 24. 8.90
<u>Numbered</u>	<u>Dated</u>														
TEN/514/89	14.4.89	Tendring District Council	Council Offices Weeley												
TEN/820/90	27. 7.90	"	"												

PART 10 Listed Building Charges Town and Country Planning Act 1971 Section 54(6)

1 Description of Charge	2 Originating Authority	3 Place where relevant documents may be inspected	4 Date of Registration

Signature of Authorised Officer

[Redacted Signature]

Date

25 JUL 1995

No. of Search

2139

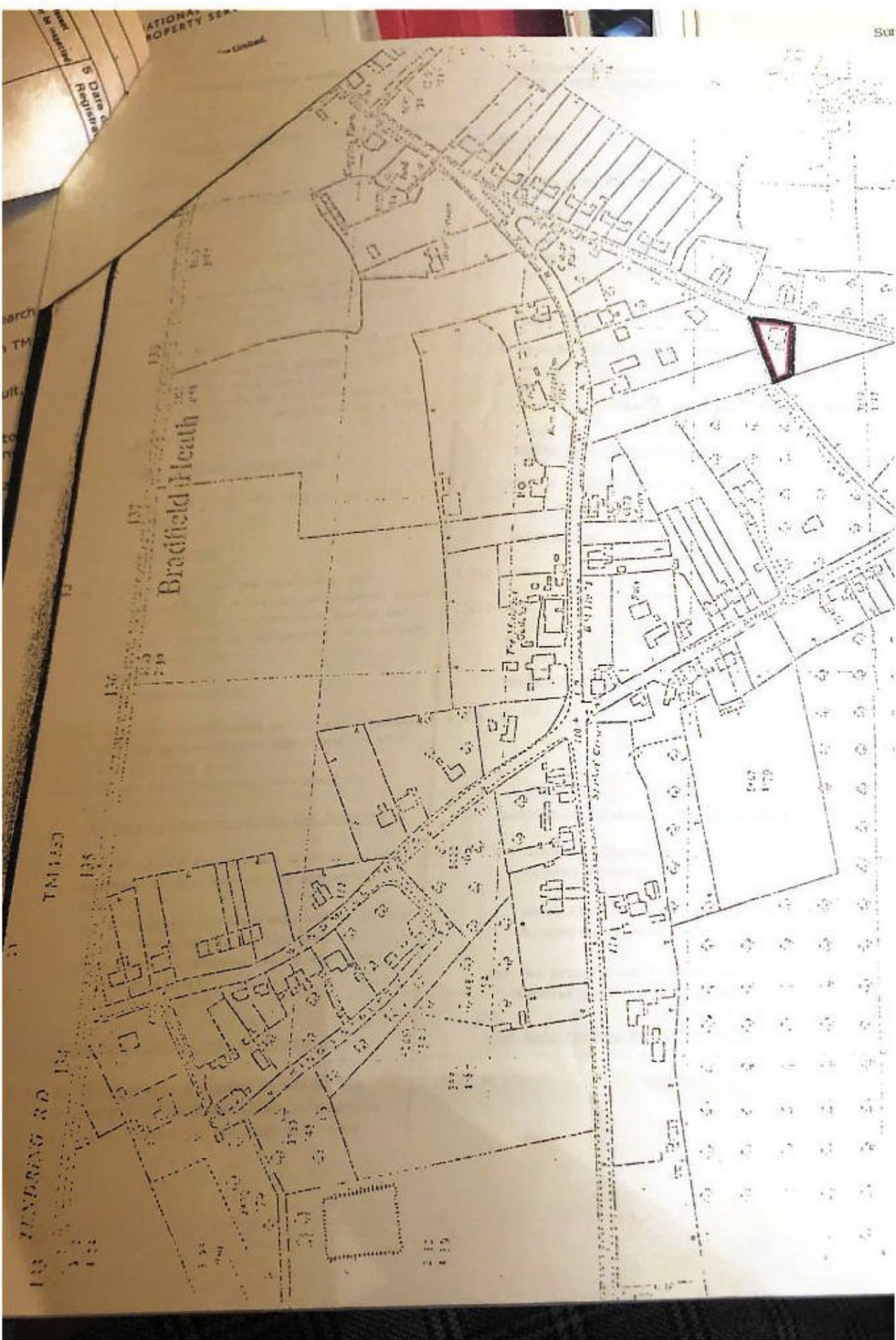

5 District

NATIONAL PROPERTY SERVICE

Sur

Search

TUNDRAS RD

Bradfield Heath

T.M. 1127

138

136

137

135

133

134

135

136

137

138

139

140

141

142

143

144

145

146

147

148

149

150

151

152

153

154

155

156

157

158

159

160

161

162

163

164

165

166

167

168

169

170

171

172

173

174

175

176

177

178

179

180

181

182

183

184

185

186

187

188

189

190

191

192

193

194

195

196

197

198

199

200

201

202

203

204

205

206

207

208

209

210

211

212

213

214

215

216

217

218

219

220

221

222

223

224

225

226

227

228

229

230

231

232

233

234

235

236

237

238

239

240

241

242

243

244

245

246

247

248

249

250

251

252

253

254

255

256

257

258

259

260

261

262

263

264

265

266

267

268

269

270

271

272

273

274

275

276

277

278

279

280

281

282

283

284

285

286

287

288

289

290

291

292

293

294

295

296

297

298

299

300

301

302

303

304

305

306

307

308

309

310

311

312

313

314

315

316

317

318

319

320

321

322

323

324

325

326

327

328

329

330

331

332

333

334

335

336

337

338

339

340

341

342

343

344

345

346

347

348

349

350

351

352

353

354

355

356

357

358

359

360

361

362

363

364

365

366

367

368

369

370

371

372

373

374

375

376

377

378

379

380

PROPERTY:- Sunnyside, Cansley Lane, Bradfield.

Part I - Standard Enquiries

ENQUIRIESDEVELOPMENT PLANS PROVISIONSStructure Plan

- 1.1.1 What structure plan is in force?
- 1.1.2 Have any proposals been made public for the alteration of the structure plan?

Local Plan

- 1.2.1 What stage has been reached in the preparation of a local plan?
- 1.2.2 Have any proposals been made public for the alteration or replacement of a local plan?

Old Style Development Plan

- 1.3 What old style development plan is in force?

Unitary Plan

- 1.4.1 What stage has been reached in the preparation of a unitary development plan?
- 1.4.2 Have any proposals been made public for the alteration or replacement of a unitary development plan?

Non-Statutory Plan

- 1.5.1 Have the Council made public any proposals for the preparation or modification of a non-statutory plan?
- 1.5.2 If so, what stage has been reached?

Policies or proposals for the Property

- 1.6 Do any of the above plans (including any proposed alterations or replacements) indicate:-
- (a) a designation of primary use or zoning for the property or the area, or
- (b) a specific proposal which includes the property?

Land Required for Public Purposes

- 1.7 Is the property included in any of the categories of land specified in Schedule 13 paras 5 and 6 of the T&CP Act 1990?

REPLIESDEVELOPMENT PLANS PROVISIONSStructure Plan

- 1.1.1 Essex Structure Plan - First Alteration
- 1.1.2 No

Local Plan

- 1.2.1 Tendring District Local Plan - Deposit Draft - June 1993.
- 1.2.2 No

Old Style Development Plan

- 1.3 County of Essex Development Plan

Unitary Plan

- 1.4.1 N/A
- 1.4.2 N/A

Non-Statutory Plan

- 1.5.1 No
- 1.5.2 N/A

Policies or Proposals for the Property

- 1.6 (a) Essex Development Plan - Without Notation
- Local Plan - Part Within Part Outside Housing Settlement Limit.
- (b) The property is also subject to the General Policies of the plan

Land Required for Public Purposes

- 1.7 No

cial

reb:
1993

ur

if
isif
the

DRAINAGE

Foul Drainage

- 2.1.1 To the Councils knowledge, does foul drainage from the property drain to a public sewer?
- 2.1.2 If yes, does the property drain into the public sewer through -
 - (a) a public sewer, or
 - (b) a private drain and then a private sewer?

Surface Water Drainage

- 2.2.1 To the Council knowledge, does surface water from the property drain to -
 - (a) a public sewer, or
 - (b) a highway drain?
- 2.2.2 If the answer to 2.2.1(a) or (b) is yes, does the surface water drain to it through:
 - (a) a private drain, or
 - (b) a private drain and then a private sewer?

Statutory Agreements and Consents

- 2.3.1 Is there in force an agreement under s22 of the Building Act 1984 for drainage of any part of the property in combination with another building through a private sewer?
- 2.3.2 Except as shown in the Official Certificate of Search, is there in force an agreement or consent under s18 of the Building Act 1984 for the erection of a building or extension of a building over or in the vicinity of a drain, sewer or disposal main?

Adoption Agreement

- 2.4.1 To the Councils knowledge, is any sewer serving or which is proposed to serve, the property the subject of an agreement under s104 of the Water Industry Act 1991 for the sewer to become vested in the sewerage undertaker?
- 2.4.2 If so, is such an agreement supported by a bond or other financial security?

Sewerage Undertaker

- 2.5 Please state the name and address of the sewerage undertaker.

DRAINAGE

Foul Drainage

- 2.1.1 Drainage replies are available on request to from Customer Services Dept., Anglian Water
- 2.2.2 Authority, 33 Sheepen Road, Colchester, Essex, CO3 3LB
Telephone - 01296 774000

Statutory Agreements and Consents

- 2.3.1 This Council is not aware of any agreement
- 2.3.2 None with this Council

Adoption Agreement

- 2.4.1 Drainage replies are available on request to from Customer Services Dept., Anglian Water
- 2.5 Authority, 33 Sheepen Road, Colchester, Essex, CO3 3LB
Telephone - 01206 774000

SEARCH NO 2139

MAINTENANCE OF ROADS ETC

Publicly Maintained

3.1 Are all the roadways, footpaths and footways referred to in Boxes B and C on Page 1 maintainable at the public expense within the meaning of the Highways Act 1980?

Resolutions to Make Up or Adopt

3.2 If not, have the Council passed any resolution to:-
(a) make up any of those roadways, footpaths or footways at the cost of the frontagers, or
(b) adopt any of them without cost to the frontagers?
If so, please specify.

Adoption Agreements

3.3.1 Have the Council entered into any subsisting agreement relating to the adoption of any of those roadways, footpaths or footways? If so, please specify.
3.3.2 Is any such agreement supported by a bond or other financial security?

ROAD SCHEMES

Trunk and Special Roads

4.1.1 What orders, draft orders or schemes have been notified to the Council by the appropriate Secretary of State for the construction of a new trunk or special road, the centre line of which is within 200 metres of the property?
4.1.2 What proposals have been notified to the Council by the appropriate Secretary of State for-
(a) the alteration or improvement of an existing road, involving the construction, whether or not within existing highway limits, of a subway, underpass, flyover, footbridge, elevated road, or dual carriageway, the centre line of which is within 200 metres of the property, or
(b) the construction of a roundabout (other than a mini roundabout), or the widening of an existing road by the construction of one or more additional traffic lanes, the limits of construction of which are within 200 metres of the property?

MAINTENANCE OF ROADS ETC

Publicly Maintained

3.1 (as described by you in box B)
Yes

Resolutions to Make Up or Adopt

3.2
(a) N/A
(b) N/A

Adoption Agreements

3.3.1 N/A
3.3.2 N/A

ROAD SCHEMES

Trunk and Special Roads

4.1.1 None
4.1.2
(a) None
(b) None

nd suffice

nnysj

to whi

al

ha

4

uation must explained ov

Other Roads

4.2 What proposals of their own have the Council approved for any of the following, the limits of construction of which are within 200 metres of the property:-

- (a) the construction of a new road, or
- (b) the alteration or improvement of an existing road, involving the construction, whether or not within the existing highway limits, of a subway, underpass, flyover, footbridge, elevated road, dual carriageway, the construction of a roundabout (other than a mini roundabout), or the widening of an existing road by the construction of one or more additional traffic lanes?

Road Proposals Involving Acquisition

4.3 What proposals have the Council approved, or have been notified to the Council by the appropriate Secretary of State, for highway construction or improvement that involve the acquisition of the property?

Road Proposals at Consultation Stage

4.4 What proposals have either the Secretary of State or the Council published for public consultation relating to:-

- (a) the construction of a new road indicating a possible route the centre line of which would be likely to be within 200 metres of the property, or
- (b) the alteration or improvement of an existing road, involving the construction, whether or not within existing highway limits, of a subway, flyover, footbridge, elevated road, dual carriageway, the construction of a roundabout (other than a mini roundabout), or the widening of an existing road by the construction of one or more additional traffic lanes, the limits of construction of which would be likely to be within 200 metres of the property?

Other Roads

4.2

- (a) None
- (b) None

Road proposals Involving Acquisition

4.3 None

Road Proposals at Consultation Stage

4.4 None

and sufficien

unnysic

s to which

ate

hat th

idin

Or

(A

SEARCH NO 2139

OUTSTANDING NOTICES

- 5. What outstanding statutory notices or informal notices have been issued by the Council under the Public Health Acts, Housing Acts, Highways Act, Building Acts or Part III of the Environmental Protection Act 1990? (This enquiry does not cover notices shown in the Official Certificate of Search or notices relating to matters covered by Enquiries 13 or, if raised, 31, 34 or 35).

BUILDING REGULATIONS

- 6. What proceedings have the Council authorised in respect of an infringement of the Building Regulations?

PLANNING APPLICATIONS AND PERMISSIONS

Applications and Decisions

- 7.1 Please list -
 - (a) any entries in the Register of planning applications and permissions,
 - (b) any applications and decisions in respect of listed building consent, and
 - (c) any applications and decisions in respect of conservation area consents.

Inspection and Copies

- 7.2 If there are any entries:
 - (a) how can copies of the decision be obtained?
 - (b) where can the Register be inspected?

OUTSTANDING NOTICES

- 5. None

BUILDING REGULATIONS

- 6. None - but in cases of a new property/flat conversion/extension or alterations you are advised to contact Building Control, Council Offices, Weeley, to see if completion certificates have been issued or if any Building Regulation matters are outstanding. You are advised that no occupation should take place until a Certificate has been issued.

PLANNING APPLICATIONS AND PERMISSIONS

Applications and Decisions

- 7.1
 - (a) & (b) & (c) - Applications Register of Applications may be inspected at Planning Registry.
 - (a) & (b) & (c) - List of decisions (other than those shown on Part III schedule)
- TEN/778/77: Refused. TEN/135/53, TEN/553/70, TEN/957/85: Granted.

Inspection and Copies

- 7.2
 - (a) Contact Planning Registry, Council offices, Weeley, CO16 9AJ. Tel: 01255 256131
 - (b) As above

of land

Sun

res to

O.

C

th; T

u

SEARCH NO 2139

n of 1

NOTICES UNDER PLANNING ACTS

Enforcement and Stop Notices

- 8.1.1 Please list any entries in the Register of enforcement notices and stop notices.
- 8.1.2 If there are any entries:
 - (a) how can copies of the notices be obtained?
 - (b) where can that Register be inspected?

Proposed Enforcement or Stop Notices

- 8.2 Except as shown in the Official Certificate of Search, or in reply to enquiry 8.1.1, has any enforcement notice, listed building enforcement notice, or stop notice been authorised by the Council for issue or service (other than notices which have been withdrawn or quashed)?

Compliance with Enforcement Notices

- 8.3 If an enforcement notice or listed building enforcement notice has been served or issued, has it been complied with to the satisfaction of the Council?

Other Planning Notices

- 8.4 Has the Council served, or resolved to serve, any breach of condition or planning contravention notice or any other notice or proceedings relating to a breach of planning control?

Listed Building Repairs Notices, etc.

- 8.5.1 To the knowledge of the Council, has the service of a repairs notice been authorised?
- 8.5.2 If the Council have authorized the making of an order for the compulsory acquisition of a listed building, is a "minimum compensation" provision included, or to be included, in the order?
- 8.5.3 Have the Council authorised the service of a building preservation notice?

DIRECTIONS RESTRICTING PERMITTED DEVELOPMENT

- 9. Except as shown in the Official Certificate of Search, have the Council resolved to make a direction to restrict permitted development?

NOTICES UNDER PLANNING ACTS

Enforcement and Stop Notices

- 8.1.1 None - other than any which may be shown on Part III schedule if relevant
- 8.1.2
 - (a) Contact Mrs Raison, Council Offices, Weeley. Tel: 01255 256165
 - (b) Planning Department, Council Offices, Weeley, CO16 9AJ

Proposed Enforcement or Stop Notices

- 8.2 No

Compliance with Enforcement Notices

- 8.3 If relevant, purchasers should satisfy themselves on this point.

Other Planning Notices

- 8.4 No

Listed Building Repairs Notices, etc.

- 8.5.1 No
- 8.5.2 No
- 8.5.3 No

DIRECTIONS RESTRICTING PERMITTED DEVELOPMENT

- 9. No

S

'dres

CC

ORDERS UNDER PLANNING ACTS
Revocation Orders etc.

10.1 Except as shown in the Official Certificate of Search, have the Council resolved to make any Orders, revoking or modifying any planning permission or discontinuing an existing planning use?

ORDERS UNDER PLANNING ACTS

Revocation Orders etc.

10.1 No

Tree Preservation Order

10.2 Except as shown in the Official Certificate of Search, have the Council resolved to make any Tree Preservation Orders?

Tree Preservation Order

10.2 No

COMPENSATION FOR PLANNING DECISIONS

11. What compensation has been paid by the Council under s114 of the T&CP Act 1990 for planning decisions restricting development other than new development?

COMPENSATION FOR PLANNING DECISIONS

11. None

CONSERVATION AREA

12. Except as shown in the Official Certificate of Search, is the area a conservation area?

CONSERVATION AREA

12. No

COMPULSORY PURCHASE

13. Except as shown in the Official Certificate of Search, have the Council made any order (whether or not confirmed by the appropriate Secretary of State) or passed any resolution for compulsory acquisition which is still capable of being implemented?

COMPULSORY PURCHASE

13. No

AREAS DESIGNATED UNDER HOUSING ACTS ETC.

Clearance

14.1 Has any programme of clearance for the area been-
(a) submitted to the Department of the Environment, or
(b) resolved to be submitted, or
(c) otherwise adopted by resolution of the Council?

AREAS DESIGNATED UNDER HOUSING ACTS ETC.

Clearance

14.1

(a) No

(b) No

(c) No

Housing

14.2 Except as shown in the Official Certificate of Search, have the Council resolved to define the area as designated for a purpose under the Housing Acts? If so, please specify the purpose.

Housing

14.2 No

ENQUIRIES OF LOCAL AUTHORITY (1994 Edition)

Please type or use BLOCK LETTERS

Search No.
 The Replies are given on the attached sheet(s)
 Signed Proper Officer
 Date

Sun
198 11

A To **Tendring District Council**
 Local Land Charges
 Council Offices
 Thorpe Road
 Weeley
 Clacton On Sea
 Essex. CO16 9AJ

B Property
Sunnyside Cansey Lane
 Bradfield
 Manningtree

C Other roadways, footpaths and footways

D A plan in duplicate is attached YES/NO
 Optional Enquiries are to be answered YES/NO
 (see Box G)
 Additional Enquiries are attached in YES/NO
 duplicate on a separate sheet

E Fees of £ 73.00 are enclosed.
 Signed: **NAIRNSEY** [Redacted] **LEWIS**
 Date: 7.7.95
 Reference: **BM/17943/RAWLINGS**
 Tel. No.: 01268 566655

F Reply to
NAIRNSEY FISHER & LEWIS
 105 LONDON ROAD
 BENFLEET
 ESSEX
 SS7 5TG
 DX 48950 BENFLEET

- A Enter name and address of District or Borough Council for the area. If the property is near a Local Authority boundary, consider raising certain Enquiries (e.g. road schemes) with the adjoining Council.
- B Enter address and description of the property. A plan in duplicate must be attached if possible, and is insisted upon by some Councils. Without a plan, replies may be inaccurate or incomplete. A plan is essential for Optional Enquiries 18, 37 and 38.
- C Enter name and/or location (and mark on plan, if possible) any other roadways, footpaths and footways (in addition to those entered in Box B) for Enquiry 3 and (if raised) Enquiries 19 and 20.
- D Answer every question. Any additional Enquiries must be attached on a separate sheet in duplicate, and an additional fee will be charged for any which the Council is willing to answer.
- E Details of fees can be obtained from the Council or The Law Society.
- F Enter name and address of the person or firm lodging this form.
- G Tick which Optional Enquiries are to be answered.

PLEASE READ THE NOTES ON PAGE

- G
- 17. Road proposals by private bodies
 - 18. Public paths or byways
 - 19. Permanent road closure
 - 20. Traffic schemes
 - 21. Advertisements
 - 22. Completion notices
 - 23. Parks and countryside
 - 24. Pipe lines
 - 25. Houses in multiple occupation
 - 26. Noise abatement
 - 27. Urban development areas
 - 28. Enterprise zones
 - 29. Inner urban improvement areas
 - 30. Simplified planning zones
 - 31. Land maintenance notices
 - 32. Mineral consultation areas
 - 33. Hazardous substance consents
 - 34. Environmental and pollution notices
 - 35. Food safety notices
 - 36. Radon gas precautions
 - 37. Sewers within the property
 - 38. Nearby sewers