

Narborough, Blaby (S)

Tree Id	Common name	Height	Spread	Age Class	Site features	Recommendations	Priority
4	Hornbeam	10.0m	8.0m	Young-Mature	None recorded..	Clean Out - Remove dead wood from canopy General Works	Priority 2
5	Rowan	9.0m	8.0m	Mature	None recorded..	Stump chip 450-750mm 450mm deep Straight Fell	Priority 2
9	Wild Cherry	11.0m	8.0m	Young-Mature	Hazard - Street Light	Crown Lift Clear Street Light (add crown lift) General Works - Remove wire	Priority 2
10	Small-leaved Lime	13.0m	10.0m	Young-Mature	Hazard - Street Light	Clear Street Light (add crown lift) General Works Remove Basal Growth	Priority 2
11	Red Oak	18.0m	15.0m	Mature	None recorded..	Clean Out General Works	Priority 2
12	Swedish Whitebeam	15.0m	11.0m	Mature	None recorded..	Section Fell Stump chip 750-1200mm 450mm deep	Priority 2
16	Common Lime	18.0m	13.0m	Mature	Adjacent - Parking area Hazard: Footpath under crown	Clean Out General Works Remove Basal Epic Growth - 2.4m	Priority 2
17	Common Lime	16.0m	13.0m	Mature	Adjacent - Parking area Hazard: Footpath under crown	General Works Remove Basal Epic Growth - 2.4m	Priority 2
18	Common Lime	18.0m	13.0m	Mature	Adjacent - Parking area Hazard: Footpath under crown	General Works Remove Basal Epic Growth - 2.4m	Priority 2
19	Common Lime	17.0m	13.0m	Mature	Adjacent - Parking area Hazard: Footpath under crown	General Works Remove Basal Epic Growth - 2.4m	Priority 2
20	Common Lime	18.0m	14.0m	Mature	Adjacent - Parking area Hazard: Footpath under crown	Clean Out - Clear low dence growth General Works Remove Basal Epic Growth - 2.4m	Priority 2

Narborough, Blaby (S) ... (contd)..

Tree Id	Common name	Height	Spread	Age Class	Site features	Recommendations	Priority
27	Common Beech	22.0m	14.0m	Mature	Adjacent - Road Hazard: Footpath under crown Hazard - Road Under Crown Hazard - Street Light	Clean Out - Remove dead wood Crown Lift - Clear road signs and play equipment General Works	Priority 2
28	Norway Maple	17.0m	16.0m	Mature	Adjacent - Road Hazard: Footpath under crown Hazard - Street Light	Clean Out Clear Street Light (add crown lift) General Works	Priority 2
32	Silver Birch	16.0m	7.0m	Middle-Aged	None recorded..	Section Fell Stump chip 450-750mm 450mm deep	Priority 2
36	Balsam Poplar	22.0m	16.0m	Mature	Adjacent - Road Hazard: Footpath under crown	Clean Out - Remove dead wood General Works	Priority 2
38	Stump	1.0m	1.0m	Mature	None recorded..	Stump chip 750-1200mm 450mm deep	Priority 2
41	Hawthorn	7.0m	6.0m	Mature	Hazard: Footpath under crown	Crown Reduce - 3.5m reduction to ease stress on decayed areas General Works	Priority 2
43	Balsam Poplar	22.0m	15.0m	Mature	None recorded..	Crown Lift - Clear footway 2.5m General Works	Priority 2
44	Norway Maple	12.0m	9.0m	Young-Mature	Hazard: Footpath under crown	Crown Lift - Clear footway 2.5m General Works	Priority 2
46	Norway Maple	10.0m	8.0m	Young-Mature	Hazard: Footpath under crown	Crown Lift - Clear footway 2.5m General Works	Priority 2
47	Balsam Poplar	22.0m	16.0m	Mature	Adjacent - Road Hazard: Footpath under crown	Clean Out - Remove dead wood General Works	Priority 2
48	Norway Maple	18.0m	13.0m	Middle-Aged	Hazard: Footpath under crown	Clean Out - Remove dead wood and hanging branch General Works	Priority 2

Narborough, Blaby (S) ... (contd)..

Tree Id	Common name	Height	Spread	Age Class	Site features	Recommendations	Priority
49	Purple-leaved Plum	9.0m	9.0m	Mature	None recorded..	Clean Out - Remove broken branch General Works	Priority 2
52	Balsam Poplar	15.0m	9.0m	Young-Mature	Adjacent - Road Hazard: Footpath under crown Hazard - Road Under Crown Hazard - Street Light	Section Fell Stump Treat >450mm at G.L.	Priority 2
53	Balsam Poplar	22.0m	17.0m	Mature	Adjacent - Road Hazard: Footpath under crown Hazard - Road Under Crown Hazard - Street Light Hazard - Telephone Cable (Wire)	Clean Out - Remove dead wood Clear Street Light (add crown lift) General Works	Priority 2
54	Norway Maple	15.0m	12.0m	Young-Mature	Adjacent - Road Hazard: Footpath under crown Hazard - Road Under Crown Hazard - Telephone Cable (Wire)	Crown Lift - Clear footway and highway 5.5m General Works	Priority 2
56	Silver Birch	17.0m	11.0m	Mature	Adjacent - Road Hazard - Car Parking Hazard: Footpath under crown Hazard - Road Under Crown	Crown Lift - Highway and footway 5.5m General Works	Priority 2
58	English Oak	15.0m	14.0m	Middle-Aged	None recorded..	Clean Out - Dead wood and hanging branch General Works	Priority 2
59	English Oak	16.0m	14.0m	Middle-Aged	None recorded..	Crown Lift - For grass maintenance 5m General Works	Priority 2
						Total:	29 trees

Notes:-

Overall total:	29 trees	-
-----------------------	-----------------	---

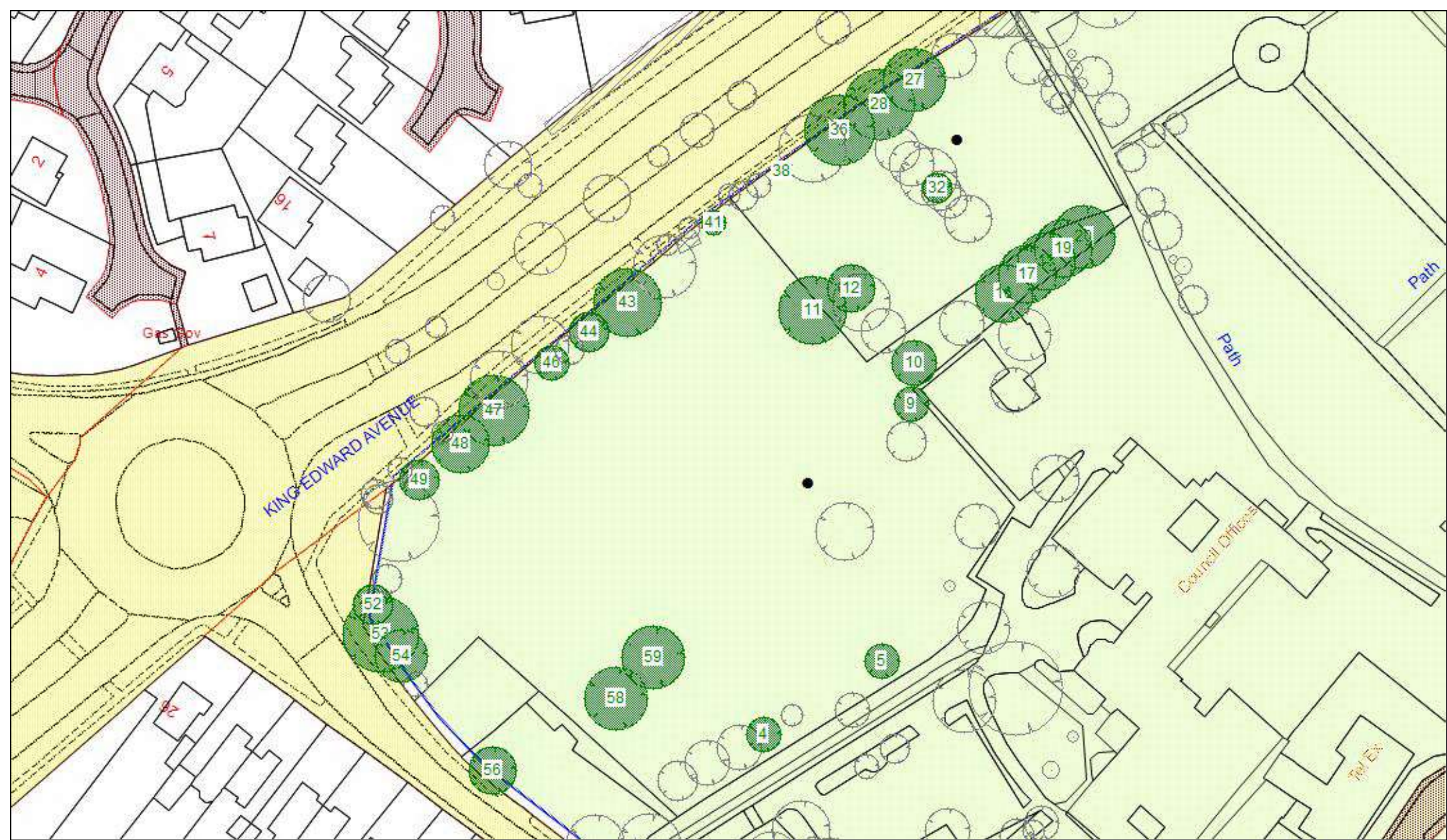

Narborough Park P2 Works - WI_Tree Schedule

WI_Tree Schedule - Narborough Park P2 Works

Scale

Unknown

Date

18/10/2021

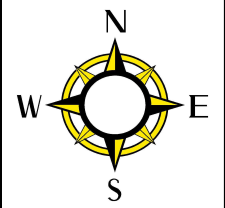

Reproduced from the Ordnance Survey mapping with the permission of the Controller of Her Majesty's Stationery Office. (c) Crown Copyright Reserved. Unauthorised reproduction infringes Crown Copyright and may lead to prosecution or civil proceedings.

