

ROSEMONT AVENUE

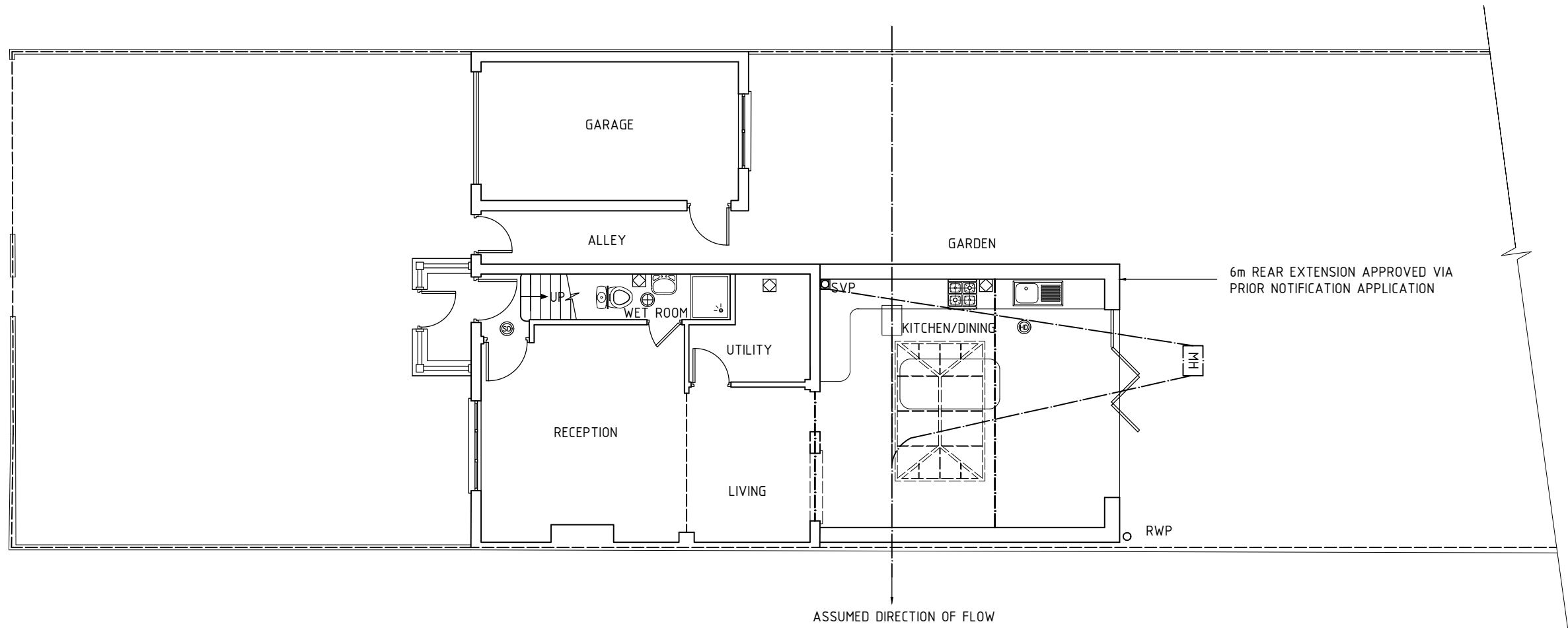

NOTES:
1- ALL DIMENSIONS TO BE CHECKED ON SITE ANY DISCREPANCY BROUGHT TO THE ATTENTION IMMEDIATELY
2- ALL STRUCTURAL WORKS TO BE CARRIED OUT TO ENGINEERS DESIGN AND STRICTLY UNDER HIS SUPERVISION
3- CONTRACTOR TO TAKE FULL RESPONSIBILITY FOR ALL DESIGN, ERECTION AND TEMPORARY WORKS

EXISTING GROUND FLOOR PLAN

SCALE 1:100
A3

DWG NO N/02

ADDITIONS ALTERATION TO:
1 ROSEMONT AVENUE
KT3 3EP

FOR:
Mr. KAMRAN BEMANA

PLANNING SUBMISSION DRAWING

Planning Additions Ltd
22 South Lane West
New Malden
KT3 5AQ
m. 0785 211 7366
e. info@planningadditions.co.uk
w. www.planningadditions.co.uk

