

# 70mm Tilt & Turn Window



## Features

### Frame Offering

- < Choice of outer frame - 68mm and 85mm height
- < Choice of 3 transom widths - 63mm, 72mm and 86mm
- < Dedicated 65mm sash
- < All sections available featured and bevelled
- < Available fully welded or mechanically jointed.

### Weatherseals

- < High performance Q-Lon gasket supplied in all mainframe sections with a manufacturer lifetime guarantee.

### Thermal and Steel Reinforcing

- < Galvanised steel range to suit topography requirements
- < Aluminium range for mechanical joint requirements
- < Range of thermal reinforcements (with strip steel) for higher 'U' value and ERP requirements
- < All reinforcements are designed to achieve required security and weathering requirements, where required.

### Finishes

- < Standard white and brilliant white
- < Range of solid colour and woodgrain foils.

### Glazing

- < Choice of 4 glazing thicknesses - 24mm or 28mm for double glazed units. 36mm or 44mm for triple glazed
- < Georgian bars in 20mm, 28mm and 50mm Dummy Transom widths.

### Ancillaries

- < Comprehensive range of add-ons, couplers, corner posts, bay poles available to suit any installation.

### Hardware

- < Full depth eurogroove positioned centrally, accepts a wide range of perimeter locking and concealed hardware
- < Secured By Design and Part Q specification available.

### Ventilation

- < Proprietary ventilation devices can be used on all designs
- < A range of ventilation options available including large outer frame, head extension and dedicated one piece head vent (see cavity closer for further details).

### Thermal Performance

- < A range of A++ to C and 0.8 to 1.6 'U' value performance are achievable with the Duraflex Diamond Suite. See separate energy performance data sheet for details.

## Tested to BS 6375-1:2015

Air Permeability	Water Tightness	Wind Resistance
Class 4 600Pa	Class 9A 600Pa	Class A3 2400Pa

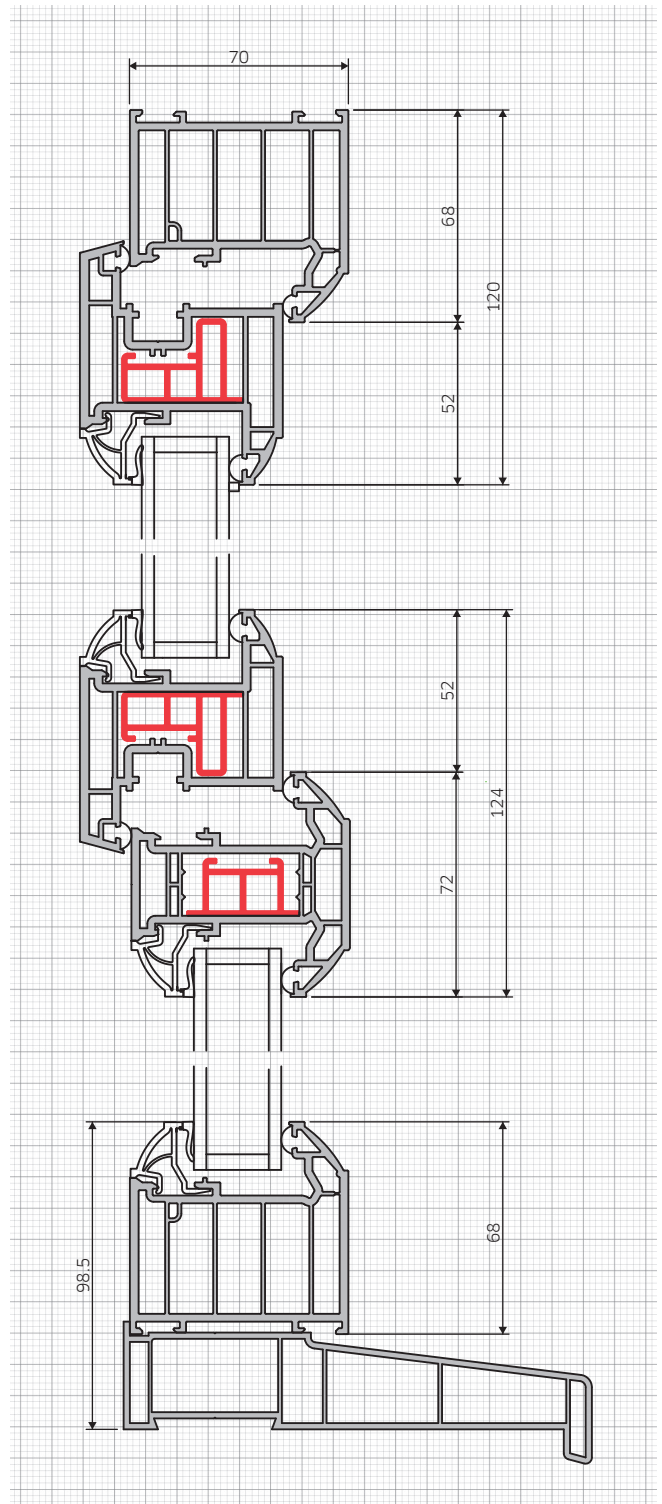

## Performance

### Security

- < A wide range of hardware options available
- < Concealed and perimeter locking options
- < Enhanced security, Secured By Design hardware also available.

### Thermal

- < A large number of simulations have been carried out by 'approved' simulators at Duraflex providing a comprehensive range of WER's (Window Energy Ratings) for A++, A+, A, B and C ratings and 'U' values to 0.8 - 1.6W/m<sup>2</sup>k using standard readily available components, lower 'U' values are available with the use of special glass combinations.

## General Features

- < **Q-Lon** - 99% compression recovery, high performance acoustic and weather sealing properties with lifetime guarantee. Operates perfectly in temperatures ranging from -20°C to 70°C
- < **Lead Free** - environmentally friendly, calcium organic lead free formulation
- < **Finishes** - comprehensive range of natural wood and solid colour foils
- < **Structural** - comprehensive range of coupling sections to suit various applications
- < **Featured and Bevelled.**