

AGRICULTURAL TO DWELLING - DC/20/01832

CONDITION 5 - HIGHWAYS: PROVISION OF PARKING.

Please refer to the plan attached for this proposal.

1. Private parking to cottage for 2 vehicles.
2. Private parking for Barn for 2/3 vehicles.
3. A locked workshop for bicycles.
4. A concrete area for daily parking and manoeuvring of large vehicles.

The aerial view of the barns and yard clearly shows there is plenty of room for daily parking and the manoeuvre of various vehicles including large vehicles such as refuse lorries.

Proposed parking for private and daily use.
Also the manoeuvring of various vehicles.

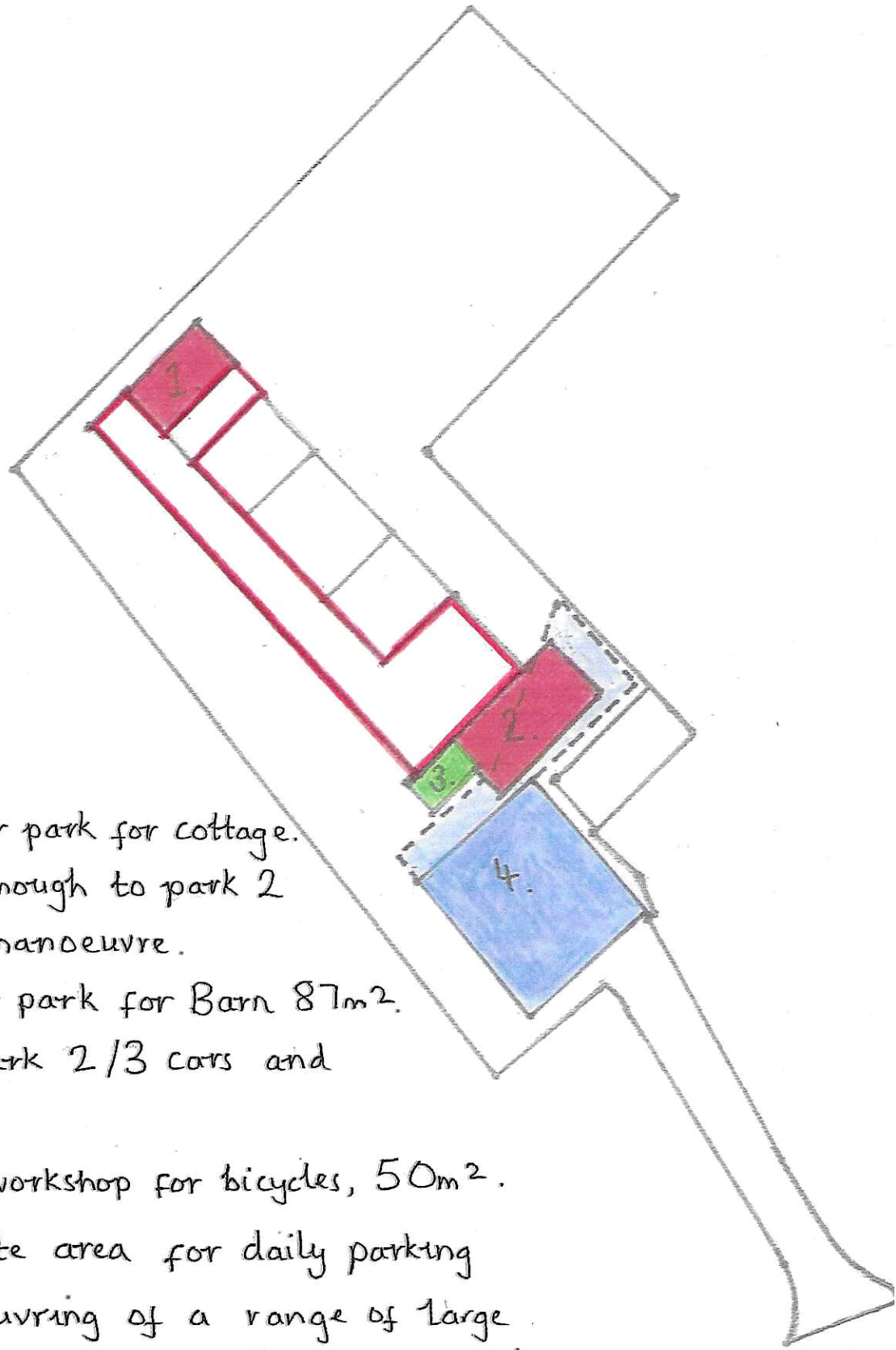

1. Private car park for cottage.
 66.5m^2 . Enough to park 2 cars and manoeuvre.
2. Private car park for Barn 87m^2 .
Enough to park 2/3 cars and manoeuvre.
3. A locked workshop for bicycles, 50m^2 .
4. A concrete area for daily parking and manoeuvring of a range of large vehicles, ie: Refuse lorries and oil lorries.
Concrete area ranging from 270m^2 up to 450m^2 .

AGRICULTURAL TO DWELLING - DC/20/01832

CONDITION 6 - REFUSE BINS AND COLLECTION AREAS.

Please refer to plan attached with this proposal.

1. 1st possible collection point.
2. 2nd possible collection point.
3. Storage of bins for the cottage.
4. Storage of bins for the Barn.

Proposed storage and collection points of refuse and recycling bins.

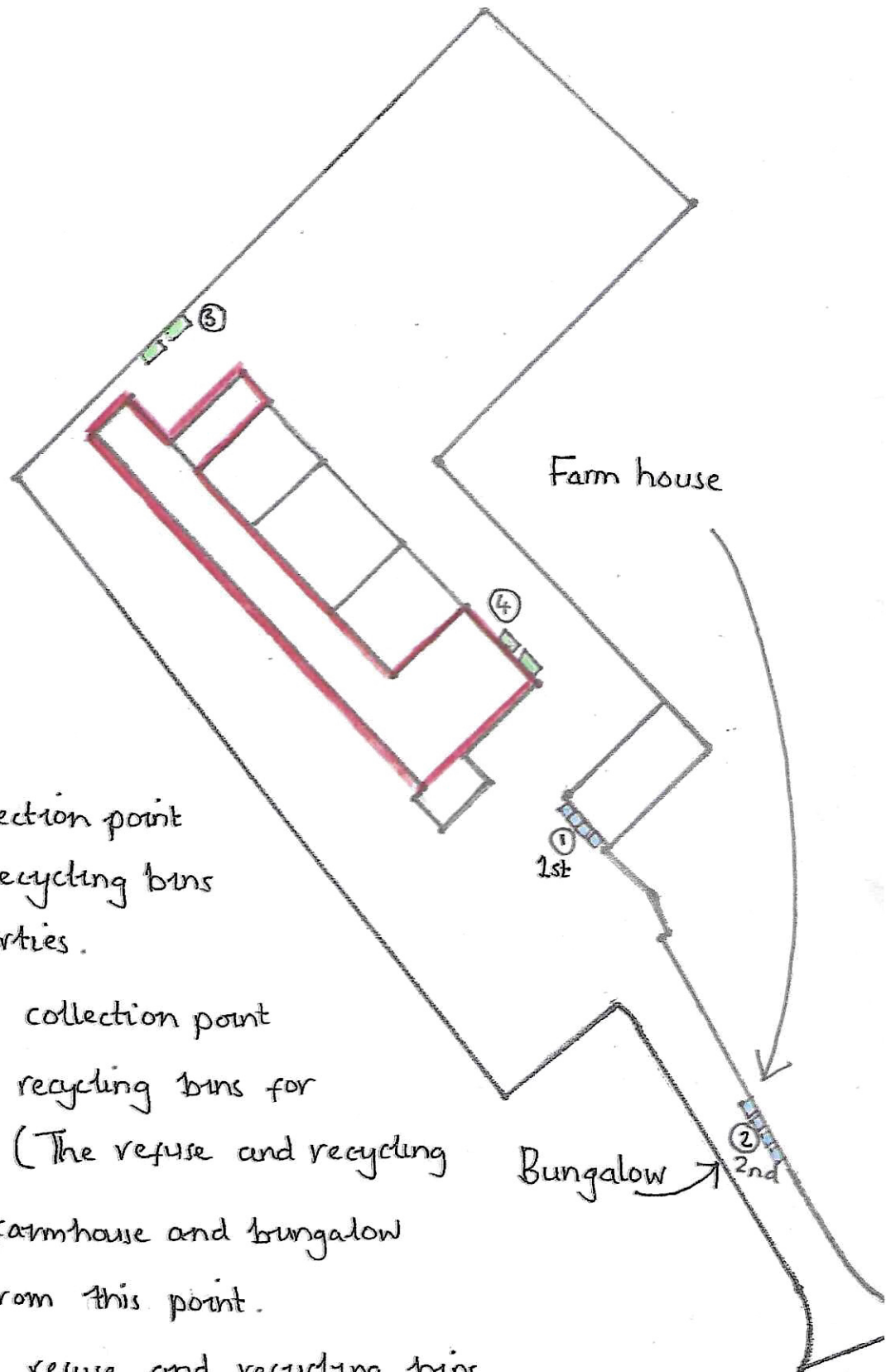

- ① 1st possible collection point for refuse and recycling bins for both properties.
- ② 2nd possible collection point for refuse and recycling bins for both properties (The refuse and recycling bins from the farmhouse and bungalow are collected from this point).
- ③ Storage for refuse and recycling bins for the cottage.
- ④ Storage for the refuse and recycling bins for the Barn.