

**GENERAL NOTES:**  
This drawing is the property of Cordage Group and must not be reproduced in part or whole or used for the execution of works without their permission.

All dimensions to be checked on site prior to commencement of any construction works and Cordage Group notified of any discrepancy via the Supervising Officer.

Figured dimensions are to be used in preference to scaled dimensions. However for Planning purposes scaling is permitted.

No deviation from this drawing will be permitted without the express consent of Cordage Group via the Supervising officer.

All works are to comply with the current edition of the Building Regulations and British Standards.

It is the contractors responsibility to check all dimensions and quantities on site prior submitting his tender for the works.

**Construction Design and Management (CDM) REGULATIONS 2015, RISK ASSESSMENT.**

**M & E**  
Standards required - CIBSE, BAFE, NICEIC, Gas safe. Dampers to ducting where required. Fire stopping where required. Light fittings to be Fire Rated where ceilings are fire separation. Fire Officer Testing and Certificate.

**BUILDING REGULATIONS**  
To Building regulation and British Standard. Requirements in all respects. To Fire Officer requirements in all respects. The Building Contractor must include for all works required by the M&E Contractors.

CLIENT  
Cordage 32 Ltd

PROJECT  
Horse & Groom,  
Sudbury,  
CO10 2TU

ISSUE  
17.03.2021  
RE-ISSUE  
-

SCALE  
1:500 @A3

DRAWN BY: GP

DESCRIPTION  
Existing Topo Survey

PROJECT NO.  
21.16  
00.02

A

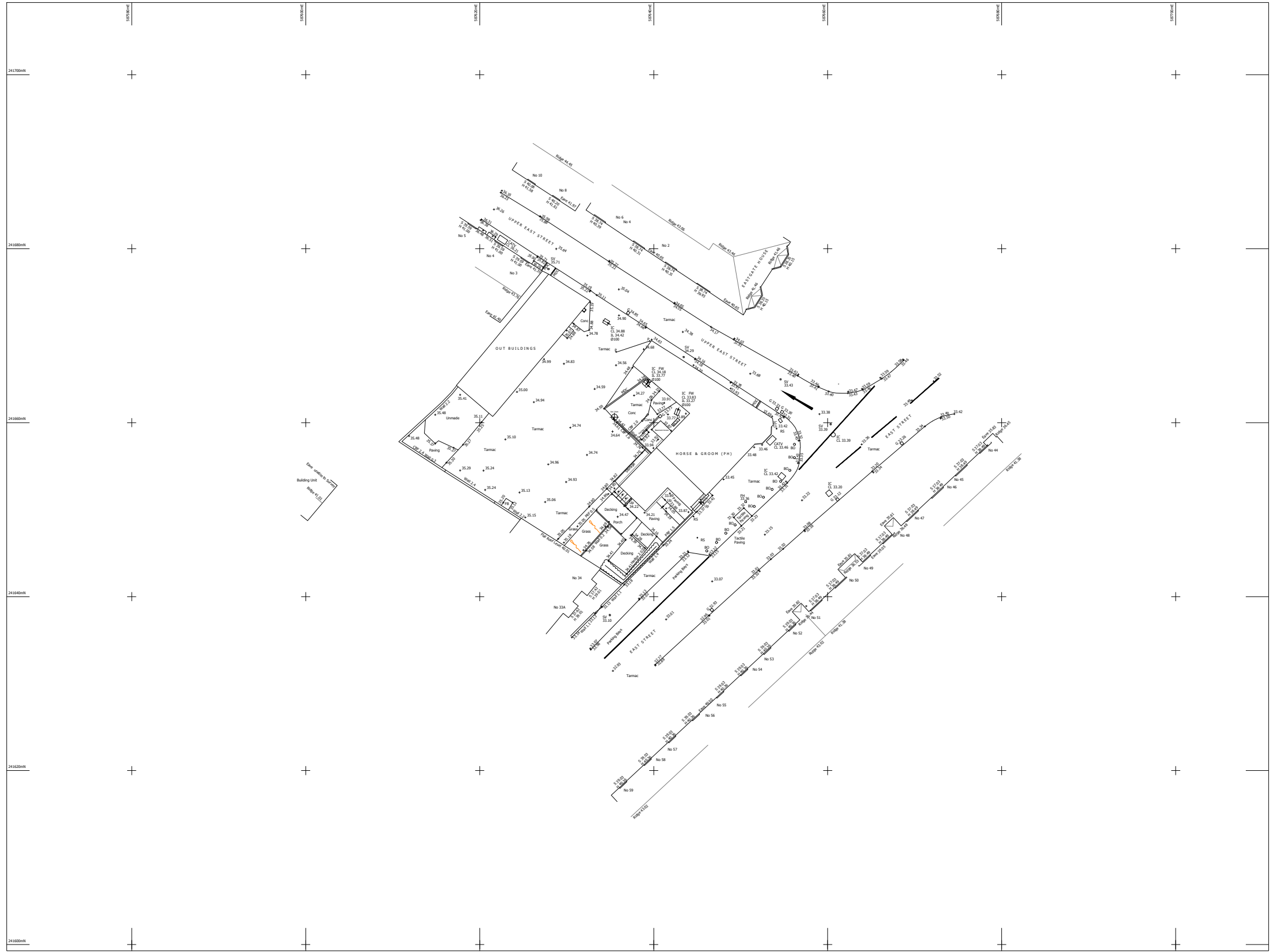

EXISTING TOPO SURVEY - SCALE 1:500 @ A3

