

EXISTING BUILDING SURVEY:

The drawings herewith described are prepared from a visual inspection of the property and thus the accuracy of the information shown cannot be guaranteed. The drawings are therefore for information only, to describe the intent of the works and are subject to a measured survey prior to manufacture.



KEY. REF; AA(314)---

W1. 08.

W2. 08.

W3. 08.

All new windows to be sliding sash as detail To match existing unless noted otherwise.

Sliding sash window as detail with matching fixed side units built into existing / retained timber projecting bay.

WINDOWS TO BE REPLACED INDICATED WITH NUMBER AND ESTIMATED DIMENSIONS. READ IN CONJUNCTION WITH DETAIL DRAWINGS AND SCHEDULE NOTED.

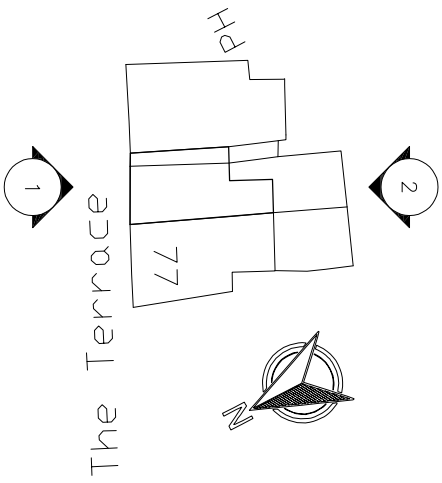

ELEVATION KEY

KEY TO TYPICAL MATERIALS, LEGEND AND WORKS:

The existing external windows noted are SINGLE GLAZED and in a state of disrepair and thus need to be replaced.

The works centre around replacement in a like for like manner and in a style and colour to match.

READ IN CONJUNCTION WITH HERITAGE, DESIGN AND ACCESS STATEMENT.



Rev No.	Date	Description	Rev No.	Date	Description
C.	26-10-21.	SPECIFICATION KEY UPDATED, WINDOW DETAILS ADDED.	KNJ		



Kirkham Board Associates
3 RIVER COURT, PYNES HILL,
EXETER, EX2 5LJ.
Tel: 01392 444747
email: office@kirkhamboard.com

Client: LIVEST WEST LTD.

Title: PROPOSED REPLACEMENT WINDOWS.
DRAWING AS SHOWN.

Address: PROPERTY KNOWN AS
75, THE TERRACE, PENRYN, TR10 8EL.

Date: JULY.21.	Scale: AS SHOWN	Drawn By:KNJ.
Dwg No: 21130	AL(4-)01	Rev:C.