

EXISTING BUILDING SURVEY:

The drawings herewith described are prepared from a visual inspection of the property and thus the accuracy of the information shown cannot be guaranteed. The drawings are therefore for information only, to describe the intent of the works and are subject to a measured survey prior to manufacture.



Elevation – 1.

FACING NORTH – EAST

(AS EXISTING)

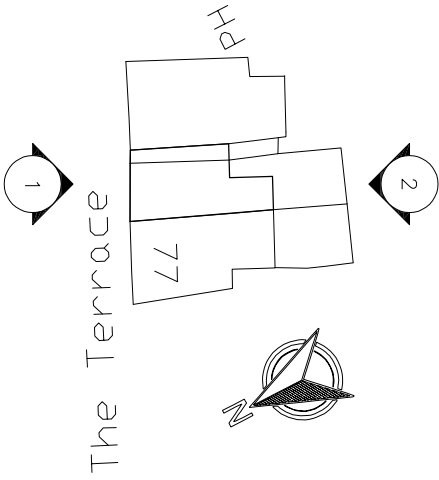

Rev No.	Date	Description	Rev No.	Date	Description
1	26-10-21	WINDOW DETAILS ADDED.			



**Kirkham Board Associates**  
3 RIVER COURT, PYNES HILL,  
EXETER, EX2 5JL.  
Tel: 01392 444747  
email: office@kirkhamboard.com

Client: LIVEST LTD.		
Title: PROPOSED REPLACEMENT WINDOWS. DRAWING AS SHOWN.		
Address: PROPERTY KNOWN AS 75, THE TERRACE, PENRYN, TR10 8EL.		
Date: JULY 21.	Scale: AS SHOWN	Drawn By: KNU.
Dwg No: 21130	AL(062)01	Rev: C.