

Club House

Pond

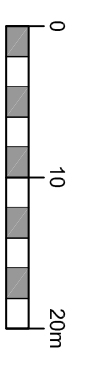

SCALE 1:500

1

# Existing Site Block Plan

Scale: 1:500 @ A3

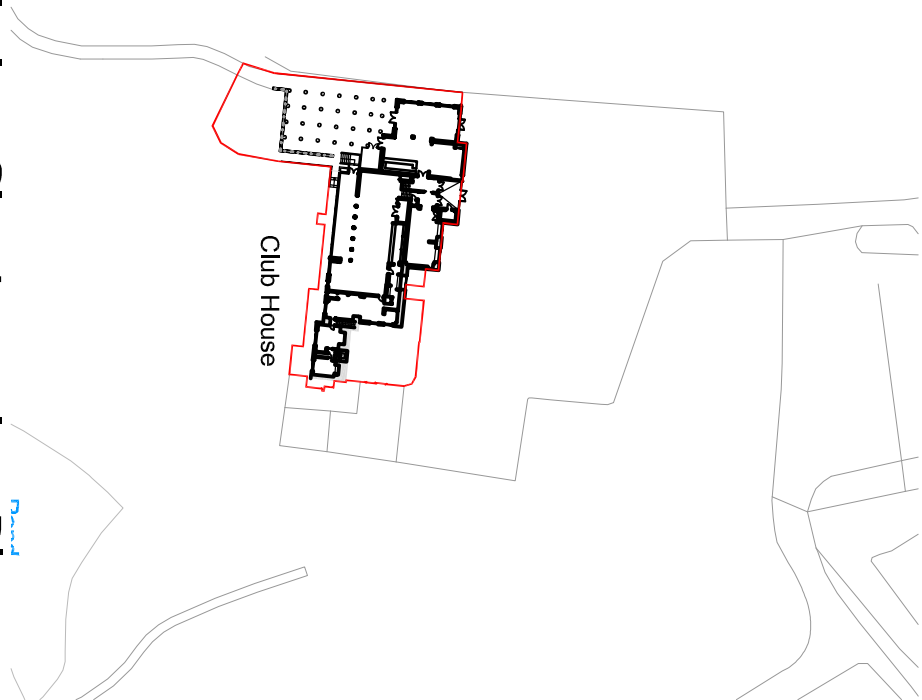

Club House

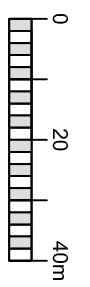

SCALE 1:1250

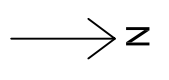

Proposals relate to Golf Club House only

2

# Existing Site Location Plan

Scale: 1:1250 @ A3

REVISIONS		Name	
Rev.	Date	Details	

		<b>Client</b> <b>Get Golfing</b>	
<b>Project</b> Warley Park Golf Club Magpie Ln Little Warley Brentwood CM13 3DX		<b>Drawing Title</b> Existing Site Block & Location Plan	
<b>Status</b> PLANNING		<b>Drawing No.</b> 21.018.GG.G 104	
<b>Drawn By</b> [Name]		<b>Scale</b> 1:500 @ A3	
<b>Date</b> SEPT 2021		<small>All information shown on drawings is for information only and does not constitute a contract. The client is responsible for ensuring that all information is up to date and correct.</small>	

13 Jubilee Way, Eurolink Business Centre, Faversham, Kent, ME13 8GD  
 Tel: 01795 537896 Fax: 08712 516713 E-mail: mail@design-id.co.uk