

Elevation  
1:10

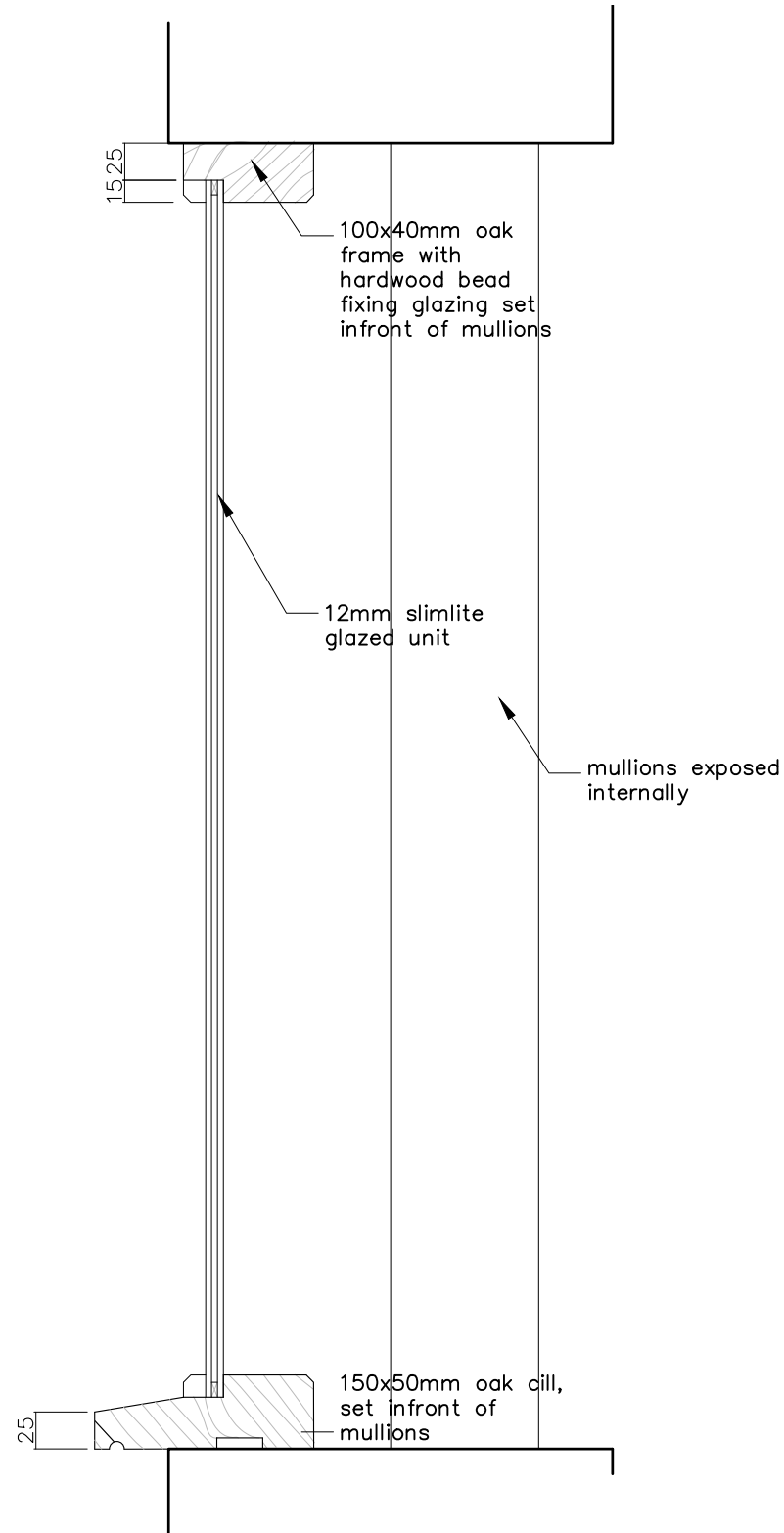

Vertical Section  
1:5

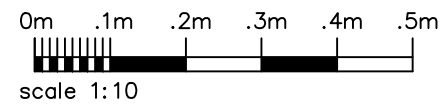
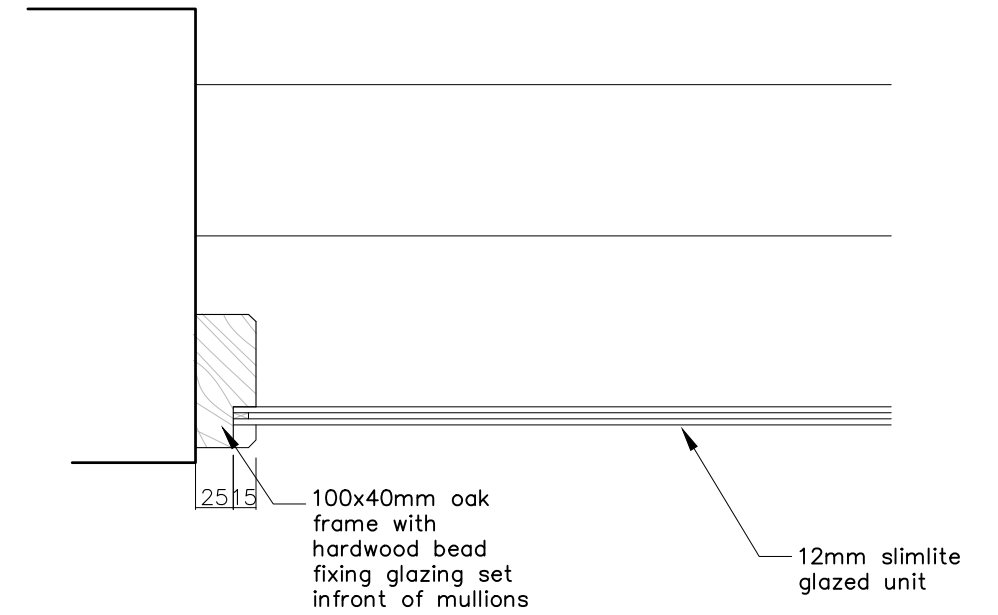
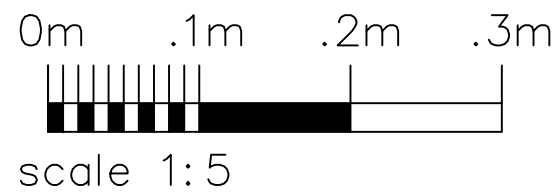

Horizontal Section  
1:5

revision	description	date

Client:

**Ms S Bagnall**

Job Title:

**The Royal Oak, Monk Soham**

Drawing Title:

**Mullion window glazing details**

Scale:

**1:5**

Drawn By:

**A3 JM**

Date:

**Aug 2021**

Job Number:

**6350**

Drawing Number:

**20**

Status:

**Building Regs**

**whitworth**

Chartered Architects & Chartered Building Surveyors  
18 Hatter Street, Bury St Edmunds, Suffolk, IP33 1NE  
01284 760421 info@whitworth.co.uk www.whitworth.co.uk

NOTE:

Do not scale from this drawing. Confirm all dimensions on site. Refer any discrepancies to the Architect before work is put in hand. Read this drawing in conjunction with the relevant sections of the specification, schedule of works and other drawings.

This drawing is copyright of whitworth.