

- NOTES:**
- This drawing is to be read in conjunction with GHB series 058/2019 drawings and documents and any other relevant project team documents.
 - Preliminary Issue - Any work undertaken before approvals are received (in writing) are at risk of abortive works.
 - All roadworks and adoptable storm water drainage to be undertaken in strict accordance with the current E.C.C. Highway Estate Roads Construction Specification and agreed on site by the E.C.C. Engineer.
 - The contractor is to take extreme care to locate and avoid any existing services.
 - All main drainage works to be installed in accordance with Sewers for Adoption (7th Ed.) and AWS drawing DS/SFA/001.
 - All manholes to be installed in accordance with Sewers for Adoption (7th Ed.).
 - All drainage pipework to be:

Vitrified Clay	to	BS-EN 295
Concrete	to	BS 5911
Grey Iron	to	BS 437
Ductile Iron	to	BS-EN 598
UPVC	to	BS-EN 1401
PP	to	BS-EN 1852
Structure walled plastic	to	BS-EN 13476
 - All pipe dimensions to be as shown.
 - Sulphate resistant cement to be used in all concrete and concrete products used in main drainage works.
 - Where cover to pipes is less than 1.2 m in trafficked areas and 0.9 m below other hard landscaped areas only rigid pipes with concrete surround/slab protection should be used.
 - All inspection chambers to be 450 mm diameter. Where total depth exceeds 1.2 m the cover size should be 350 mm x 350 mm (Max.) to restrict access. where total depth is less than 1.2 m use 450 mm x 450 mm covers.
 - Cover strength to be D400 in carriageways, C250 in lightly trafficked (i.e. pedestrian) areas, B125 elsewhere.
 - The contractor is ascertain the precise position, depth & size of all sewer connections before drain laying commences and report all discrepancies to the engineer.
 - The design infiltration rate to be confirmed by representative testing to BRE DG365 prior to construction and all discrepancies reported to the engineer.
 - The contractor is to ensure that all excavations for proposed drainage works are not undermining existing or proposed adjacent foundations.
 - Verification of formation subgrade CBR required prior to installation of subbase. Refer to engineer if less than design value of 3% (Ref. CSG/15952)
 - Foundation design to DMRB CD 225 (Restricted Class 2) - in-situ testing of subbase not required at top of granular material to confirm foundation stiffness achieved.
 - All compaction of granular material to SHW Clause 802 unless stated otherwise.

P5	08/09/21	Issued for Co-Ordination
P4	22/03/21	EH Comments Including Altered Bus Stop Location.
P3	24/02/21	Essex Highways Vetting Comments Addressed
P2	02/02/21	Issued to E.C.C
P1	28/01/21	Initial Issue
Revision	Date	Description

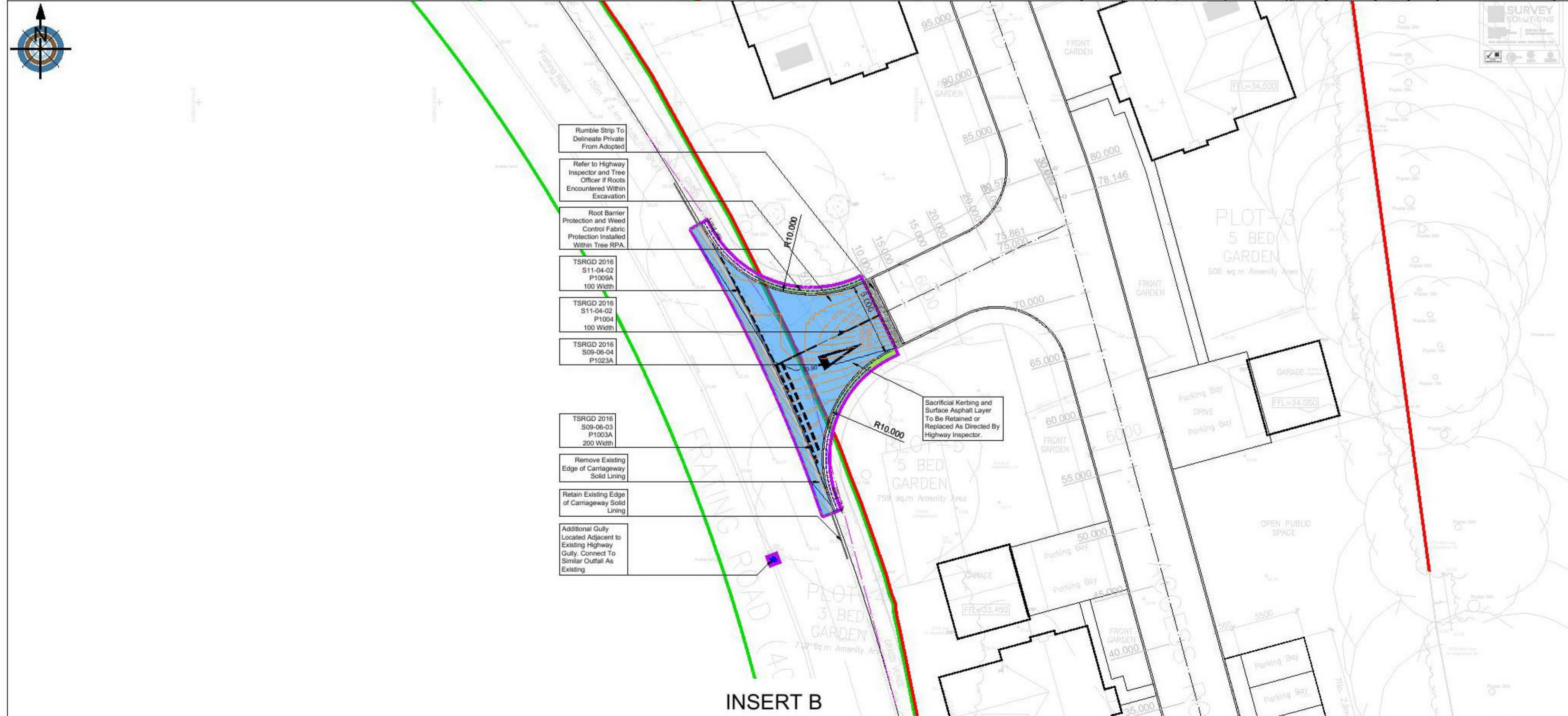

SECTION 278 LEGEND:

- ADOPTABLE MINOR ACCESS (INCLUDING SITE STEPPED TRANSITION TIE IN)
- ADOPTABLE OVER-RUNNABLE MARGIN
- ADOPTABLE FOOTWAY
- ADOPTABLE VERGE
- KERB CUT-IN EXTENT
- DEVELOPMENT BOUNDARY
- SECTION 278 BOUNDARY
- EXISTING HIGHWAY BOUNDARY
- ROOT PROTECTION BARRIER

© Copyright
GHBullard & Associates LLP
 Civil and Traffic Engineering Consultants

27 Barton Road,
 Thurston,
 Suffolk,
 IP31 3PA

Client: **MR M JOHNSON**

Project: **LITTLE PADDOCKS GREAT BROMLEY**

Drawing Title: **SECTION 278 DETAILED SITE PLAN LAYOUT**

Scale: **1:250 @ A1**

Date: **JAN 2021** Drawn: **DJB** Checked: **MSG**

DWG Reference: **058-2019.DWG**

Status: **FOR APPROVAL**

Drawing Number: **058/2019/14** Revision: **P5**

PI = Preliminary, CI = Construction, AB# = As Built