

GROUND FLOOR PLAN

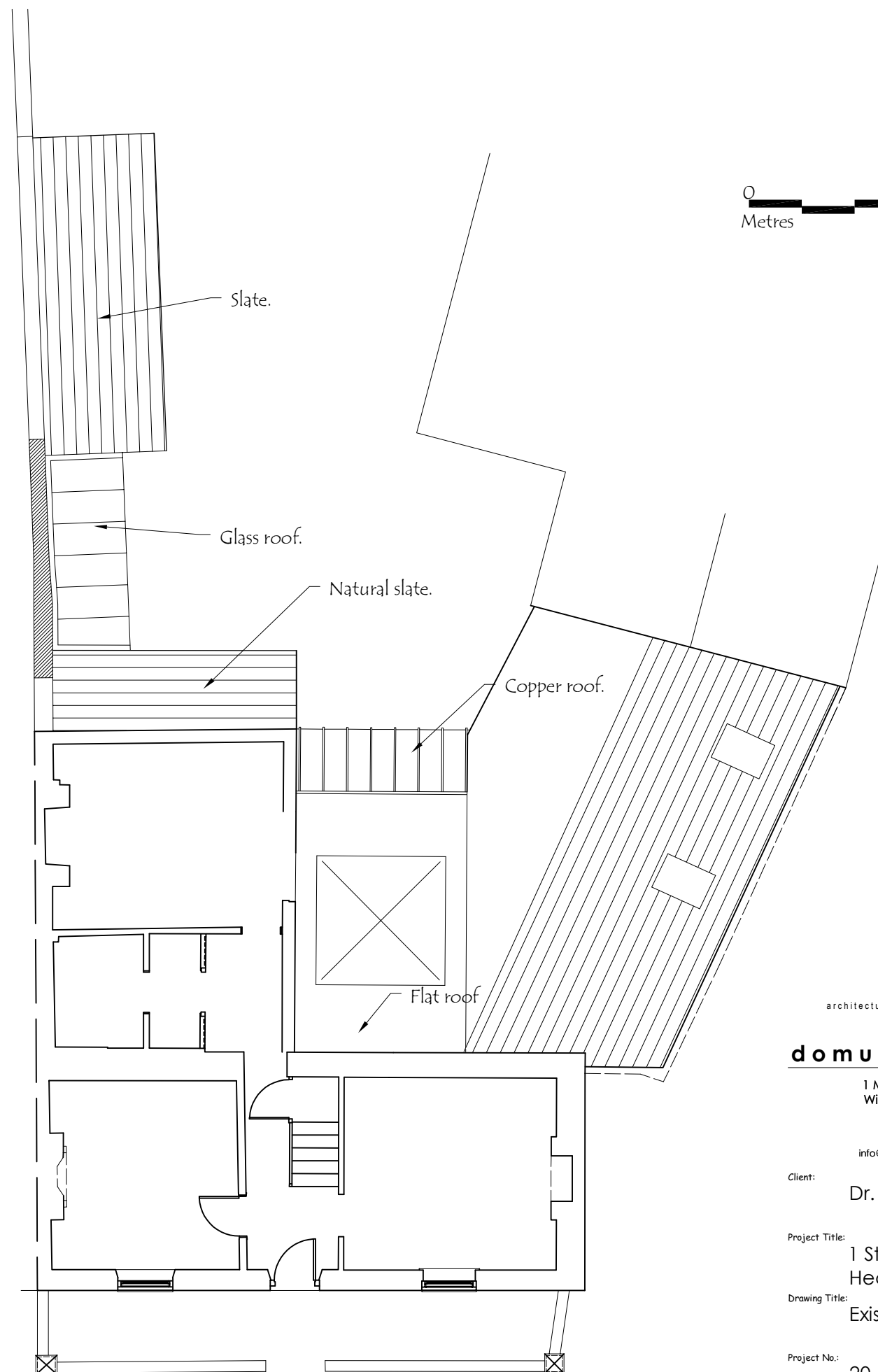

ROOF PLAN



architectural & interior designers

domus DESIGNS

1 Manor Cottages
Willow Court Lane
Moulsoford
OX10 9HZ
01865 875690
info@domusdesigns.co.uk

Client:

Dr. B. Lavery

Project Title:

1 St. Andrew's Road
Headington OX3 9DL

Drawing Title:

Existing Plans

Project No.:

20.10

Drawing No.:

02

Drawing Scale:

1 : 100 @ A3

Copyright: domus DESIGNS 2021

All dimensions and levels to be checked on site and any discrepancies to be reported to the supervising officer before construction. **DO NOT SCALE**