

Proposed Site Layout Plan 1:200 @ A1

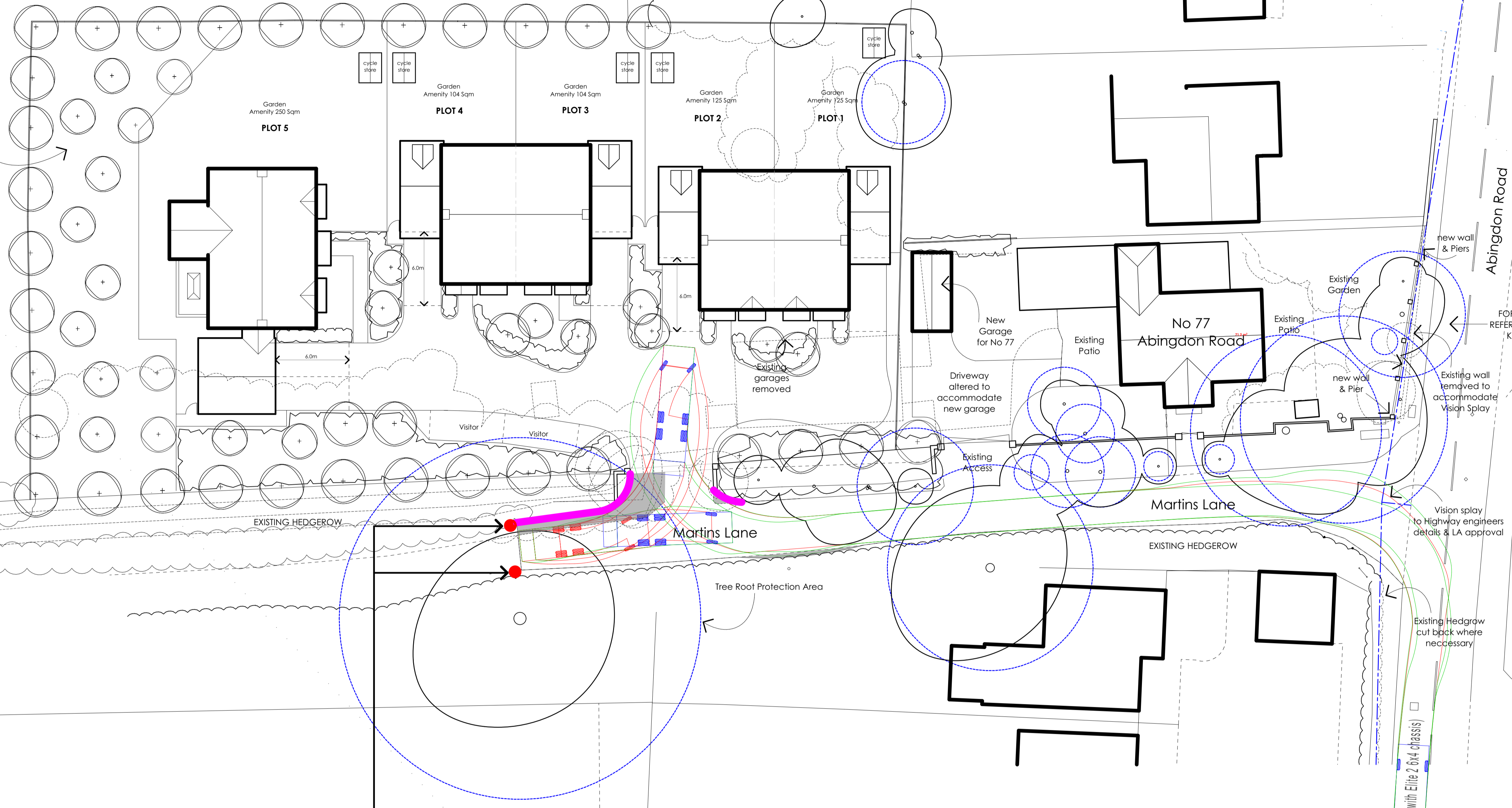

Landscape Buffer, Please refer to separate Landscape Plan



Abingdon Road

No 77 Abingdon Road

Martins Lane

EXISTING HEDGEROW

Martins Lane

EXISTING HEDGEROW

Tree Root Protection Area

FOR ELEVATION REFER TO DRAWING KA2017-208

new wall & Piers

Existing wall removed to accommodate Vision Splay

Existing Hedgerow cut back where necessary

Pipework 223W (with Elite 2 6x4 chassis)

New kerb positions shown in pink to match existing

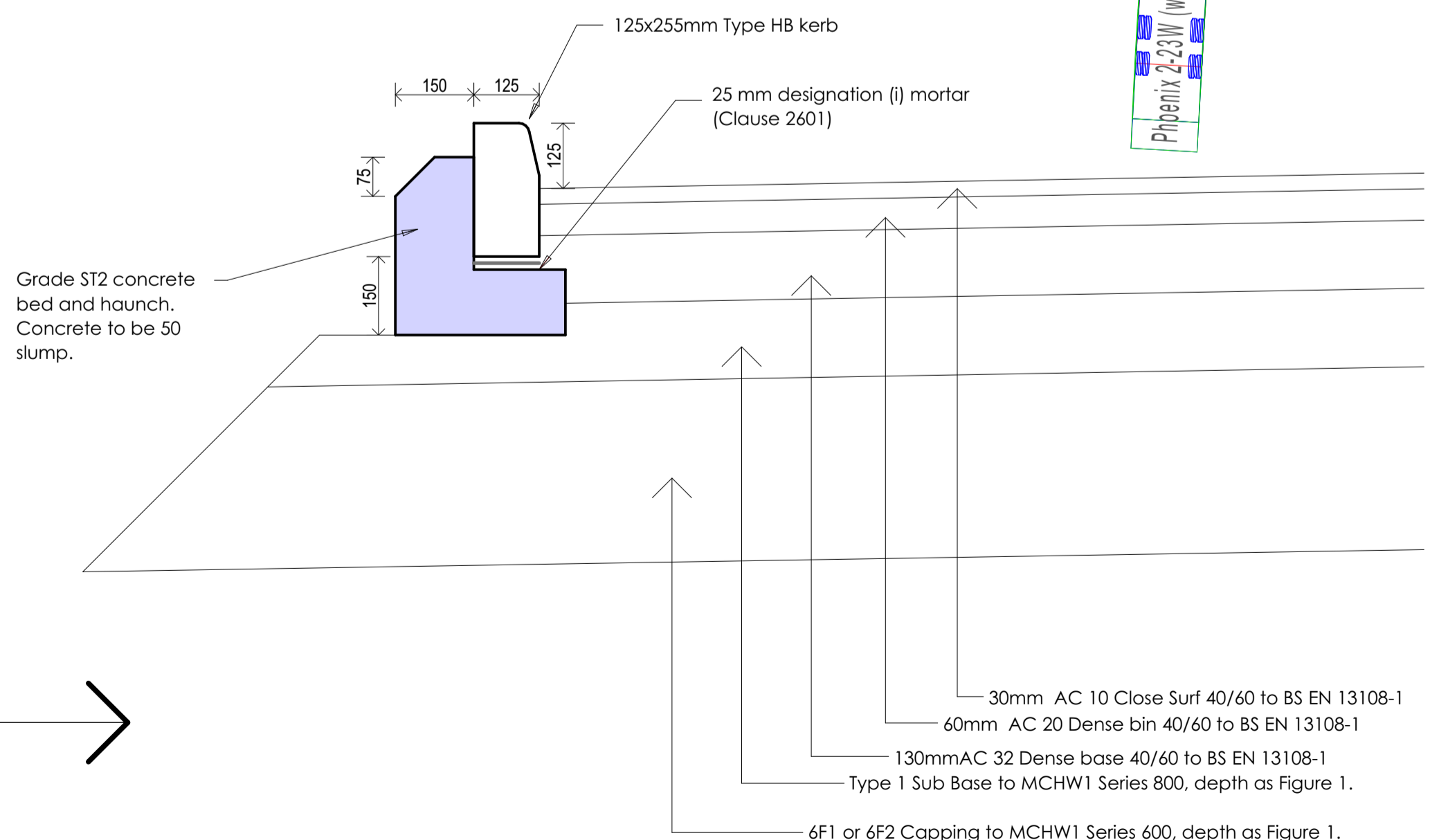

Generic Road Section Detail 1:10 @ A1

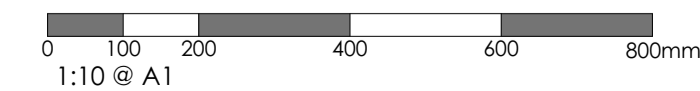

Two signs to be placed either side of Martins Lane where the road narrows. To be an aluminium road sign of high reflectivity mounted on light weight corrosion free aluminium post.



Shaded area of Martins Lane to be constructed to OCC's adoptable highway standard

Rev	Date	Notes
A	03-21	Minor Revisions

This document is the copyright work of Key Land Estates Architecture Ltd. Unless formally assigned in writing



52 Brook Street
Tring - Hertfordshire
HP23 5EF
T: +44(0)7968 031139
pburman@keylandestates.co.uk
www.keylandestates.co.uk

Project **Land to rear of 77 Abingdon Road Standlake**

for Aarhus Developments Ltd

Drawing Title **Martins Lane**

Status **PLANNING**

Scale 1:200 @ A1 Date 29/10/2021

Job No KA2007 Drawing No KA2017 - 207 Revision A