

Application site edged in red

0 10 20 30 40m

Streetwise Licence no. 100047474

EXISTING SITE LOCATION PLAN  
01

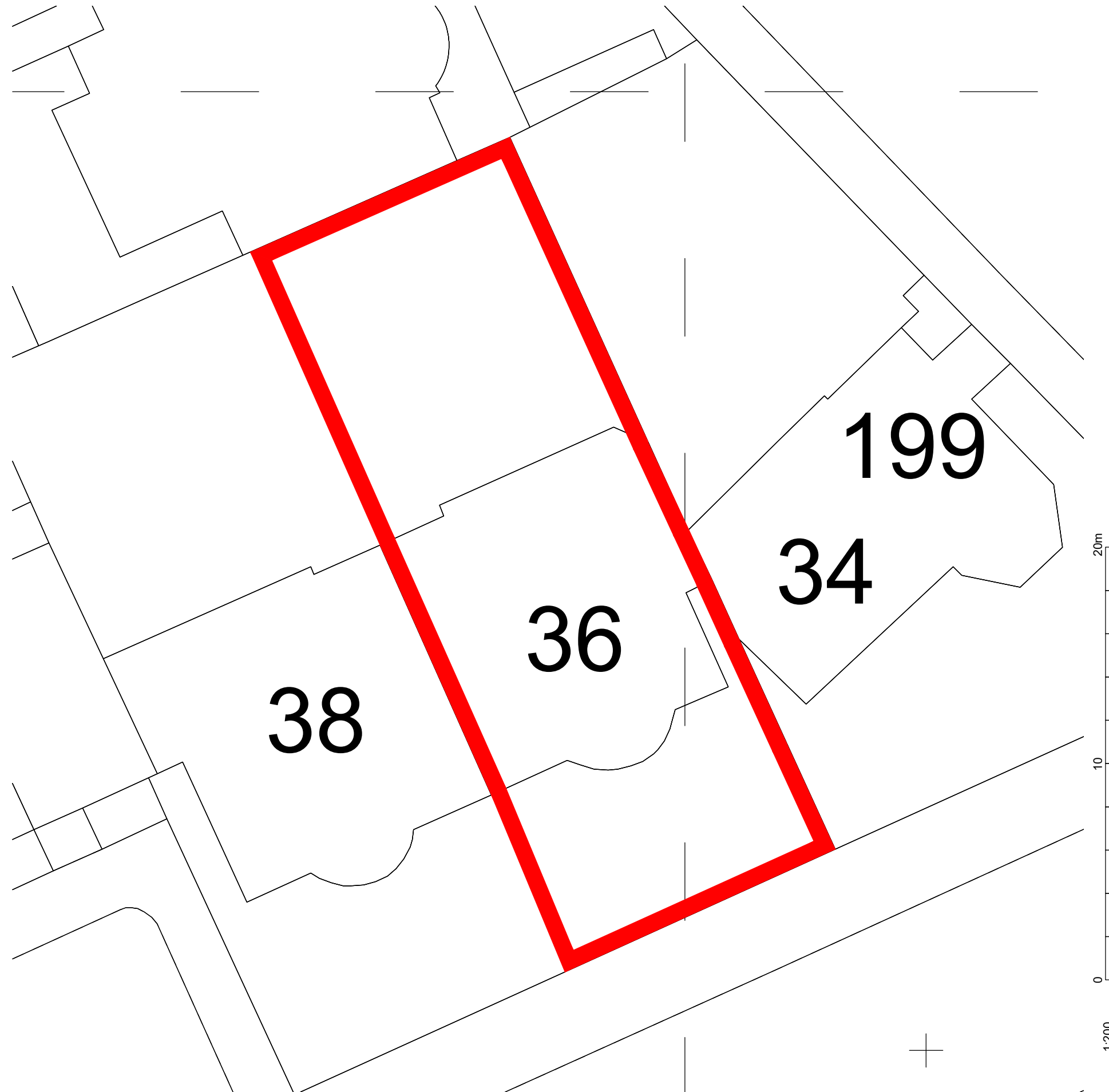
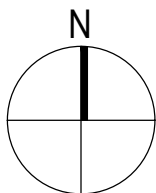

EXISTING AND PROPOSED SITE BLOCK PLAN (UNCHANGED)  
02

DRAWING: SITE LOCATION & BLOCK PLANS		ON BEHALF OF: WESTMINSTER HIA  (QUINN STUDIO LTD. 148 CROYLAND RD LONDON N9 7BD)
PROJECT ADDRESS: FLAT 6, 36 GLOUCESTER GDNS, W2 6BP		
CASE No./DWG No./REV: P-01	SCALE: AS SHOWN	
DRAWN BY: JQ	DATE: 27.10.21	