

Notes :-

1. This drawing to be read in conjunction with all relevant Architects, Engineers & Specialist drawings and specifications.
2. For Section A-A refer to drawing 9113-02

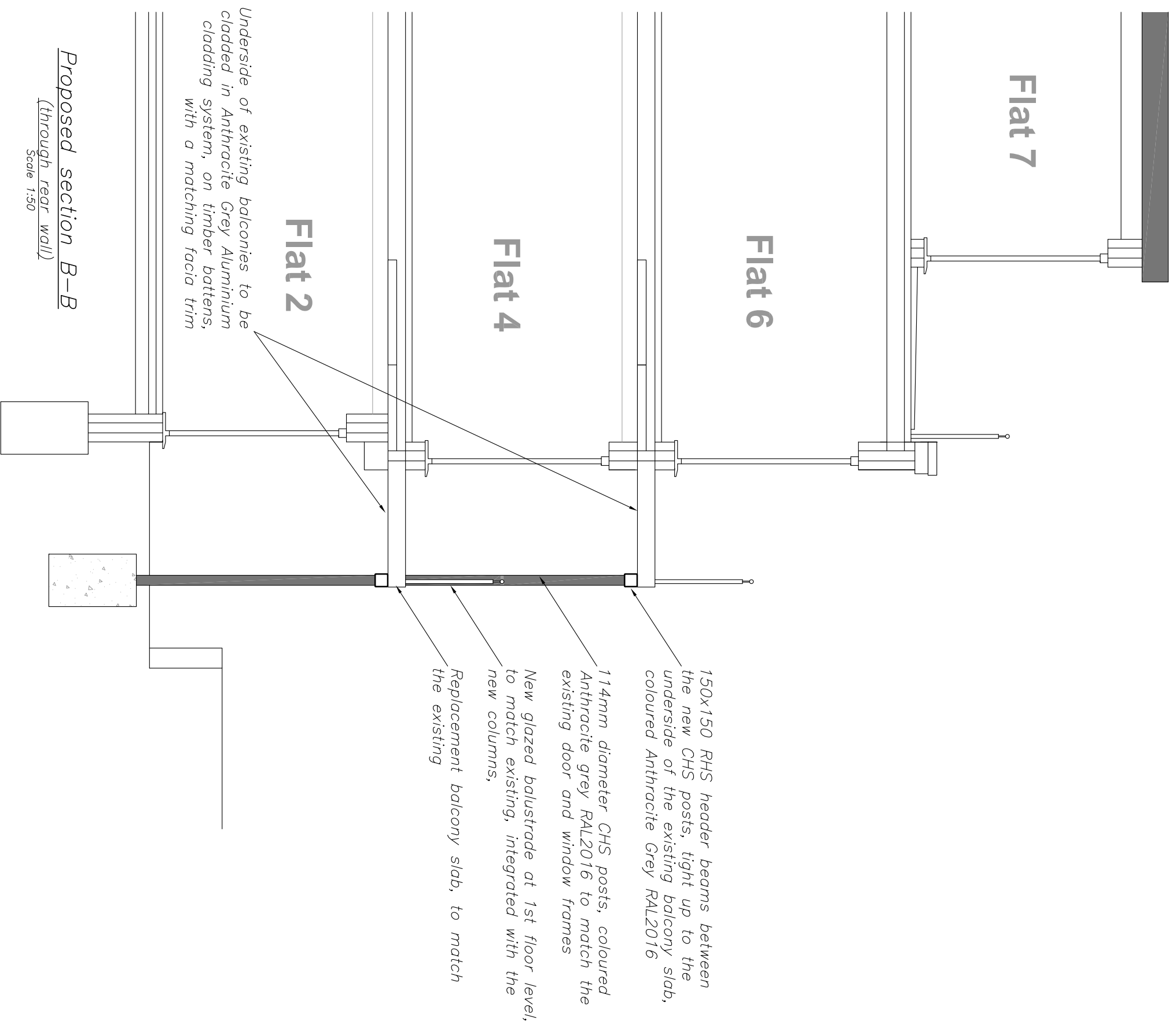

**PRELIMINARY**

|     |          |                              |
|-----|----------|------------------------------|
| A.  | 16.08.21 | ISSUED FOR PLANNING APPROVAL |
| .   | 10.07.21 | ISSUED FOR INFORMATION       |
| Rev | Date     | Comment                      |



**clive adams associates ltd**

Consulting Engineers  
Vicarage Close  
Roxwell, Essex, CM1 4LR  
Telephone: (01708)344344  
E-mail address: design@cliveaa.com

**Project**  
Lawrence Court  
120 Main Road  
Sidcup, Kent  
DA14 6NE

**Title**  
*Proposed full height section  
A-A through rear wall*

|            |         |         |         |
|------------|---------|---------|---------|
| Drawn      | Checked | Date    | Scale   |
| M.T.       | C.I.A.  | May '21 | 1:50@A3 |
| Drawing No | 9113-05 | Rev     | A.      |