

The use of this data by the recipient acts as an agreement of the following statements. Do not use this data if you do not agree with any of the following statements:  
 We cannot guarantee any information supplied by third parties and as such their accuracy cannot be guaranteed. All features are approximate and subject to clarification by a detailed topographical survey, statutory service enquiries and confirmation of the legal boundaries.  
 Do not scale the drawing.  
 Use figured dimensions in all cases.  
 Contractors/Sub-contractors/Manufacturers to check all dimensions on site prior to commencement of the works.  
 Report any discrepancies in writing to PJC ARCHITECTURE LTD before proceeding.

REV	DATE	AMENDMENTS	BY
A	04/11/21	Red Line Boundary	AH
B	05/11/21	Red Line Boundary	AH

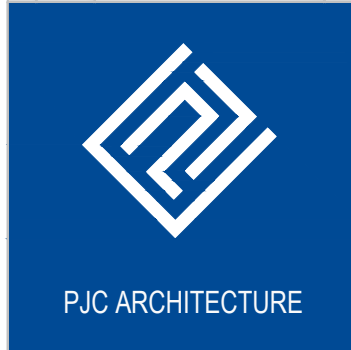
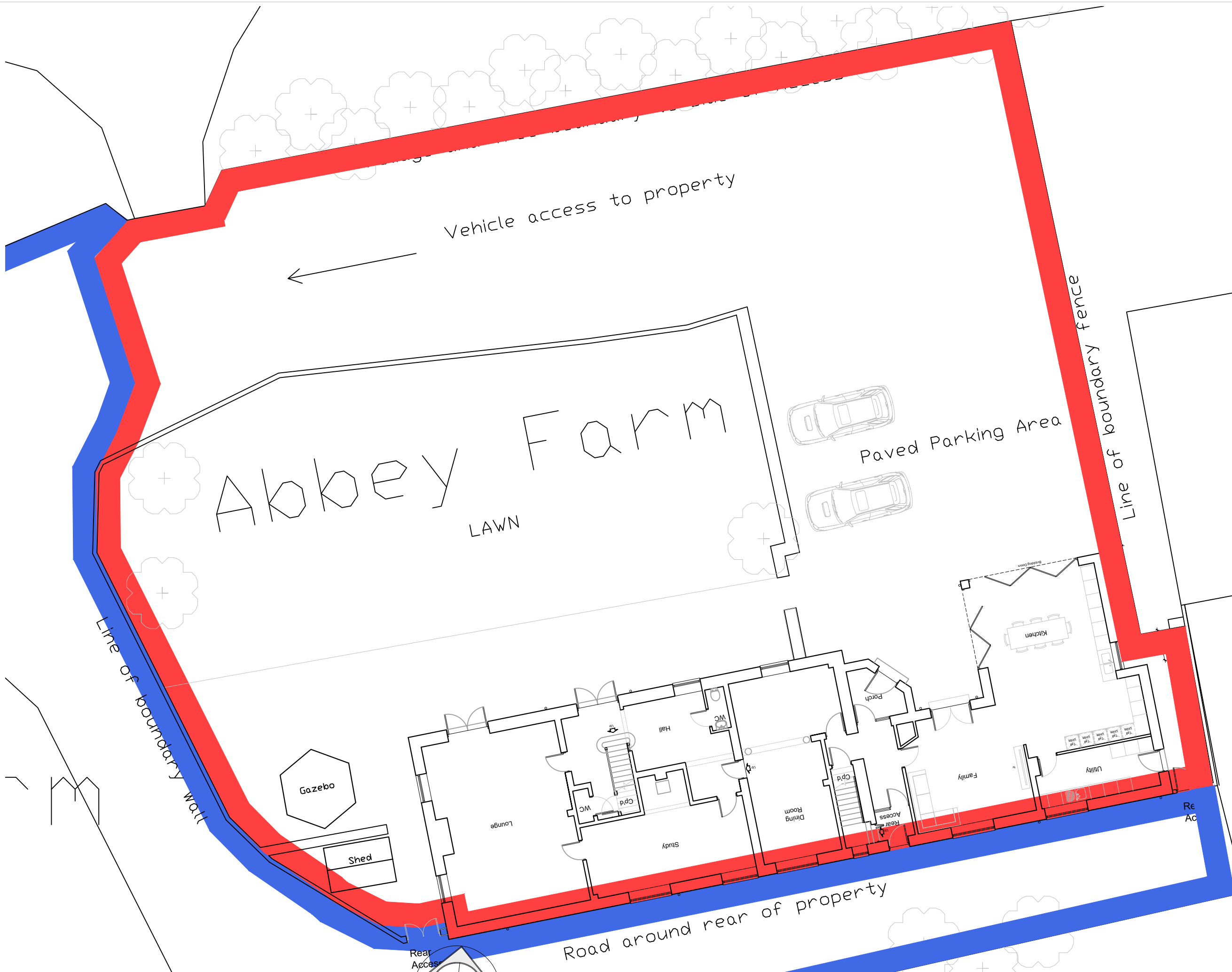

**PJC ARCHITECTURE**  
 PJC ARCHITECTURE LTD  
 The Old Post Office  
 31 Main Road  
 Kenton Bank Foot  
 Newcastle upon Tyne  
 NE13 8AA  
 T: 0191 2140022  
 F: 0191 2140060  
 E: enquiries@pjc-architecture.co.uk  
 W: www.pjc-architecture.co.uk

Status	Planning
Project	Alan Taylor Extension and Alterations at Abbey Farm, Morpeth Northumberland NE61 2YN
Drawing	Proposed Site Plan
Date	05/11/21
Drawing No.	PL_1022_102
Revision	B
Scale	1:250 A3
Drawn By	AH
Checked By	PJC

■ Site Plan ■ Ownership