

Proposed plans for Hopper Huts, The Granary, Rock Farm, Gibbs Hill, Nettlestead, Kent

NOT TO SCALE

ALAN BAXTER PARTNERSHIP LLP CONSULTING STRUCTURAL ENGINEERS
 THE CLOCK BUILDING, PYMPES COURT TELEPHONE: 01622 744263
 BUSBRIDGE ROAD, LOOSE FAX: 01622 749270
 MAIDSTONE, KENT, ME15 0HZ EMAIL: mail@abpengineers.co.uk

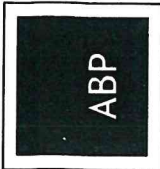

PROJECT: HOPPER HUTS	MADE BY: JR	CHECKED:	PAGE No: SK1	REV.
	DATE: SEPT 21		JOB No: D659	

ALAN BAXTER PARTNERSHIP LLP

THE CLOCK BUILDING, PYMPES COURT,
BUSBRIDGE ROAD, LOOSE, MAIDSTONE
KENT ME15 0HZ

CONSULTING STRUCTURAL ENGINEERS

TELEPHONE: 01622 744263
FAX: 01622 749270
EMAIL: mail@abpengineers.co.uk

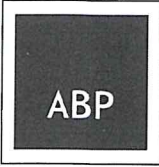

Project Title: HOPPER HUTS	Originator: JR	Checked:	Page: SK2	Rev:
	Date: SEPT '21		Job Number: D659	

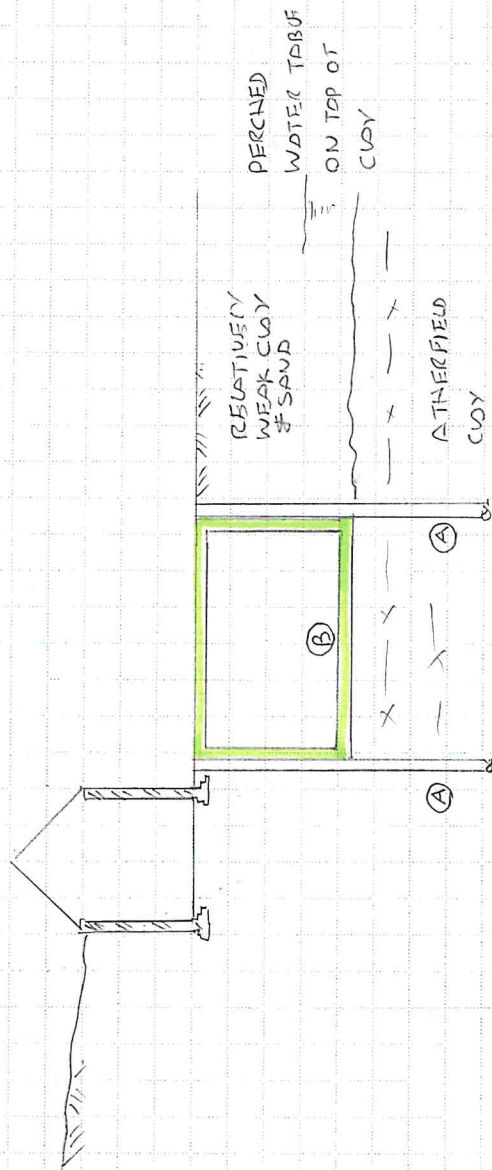

SCALE ~ 1:200

A - A

- (A) CONTIGUOUS PILED WALL
- (B) REINFORCED CONCRETE BASEMENT

ALAN BAXTER PARTNERSHIP LLP

THE CLOCK BUILDING, PYMPES COURT,
BUSBRIDGE ROAD, LOOSE, MAIDSTONE
KENT ME15 0HZ

CONSULTING STRUCTURAL ENGINEERS

TELEPHONE: 01622 744263
FAX: 01622 749270
EMAIL: mail@abpengineers.co.uk

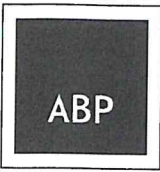

Project Title: HOPPER HUTS	Originator: JR	Checked:	Page: SK3	Rev:
	Date: SEPT '21		Job Number: D659	

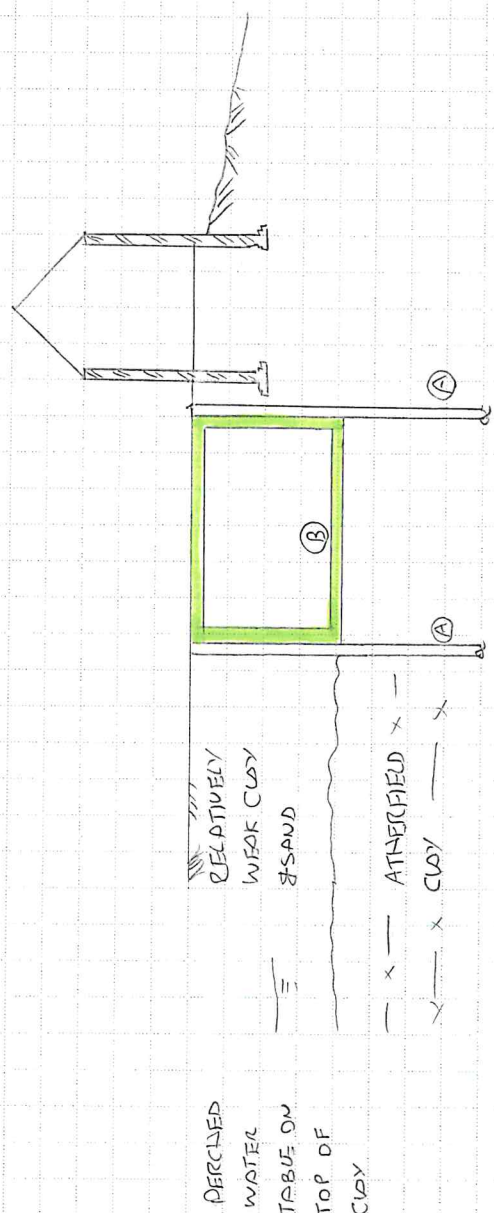

B-B

SCALE 1:200

- (A) CONTIGUOUS PILED WALL
- (B) REINFORCED CONCRETE BASEMENT