

NOTES



Revision

Rev	Notes	Date
A	Planning Issue	29/09/2021

KEY

- Existing walls
- Boundary line
- Existing furniture
- Level line
- 1.5m head height
- 1.8m head height

JOB TITLE

Proposed ground floor side extension, floor plan redesign and all associated works at 130 Woodside Road

STATUS

Planning Drawings

DRAWING TITLE

Existing Floor and Roof Plans

CLIENT

Blackwell

SCALE

1 : 100 at A3

DRAWN

AR

DATE

Sep 2021

CHECKED

MF

DRAWING NO. 69270 - 1100 A

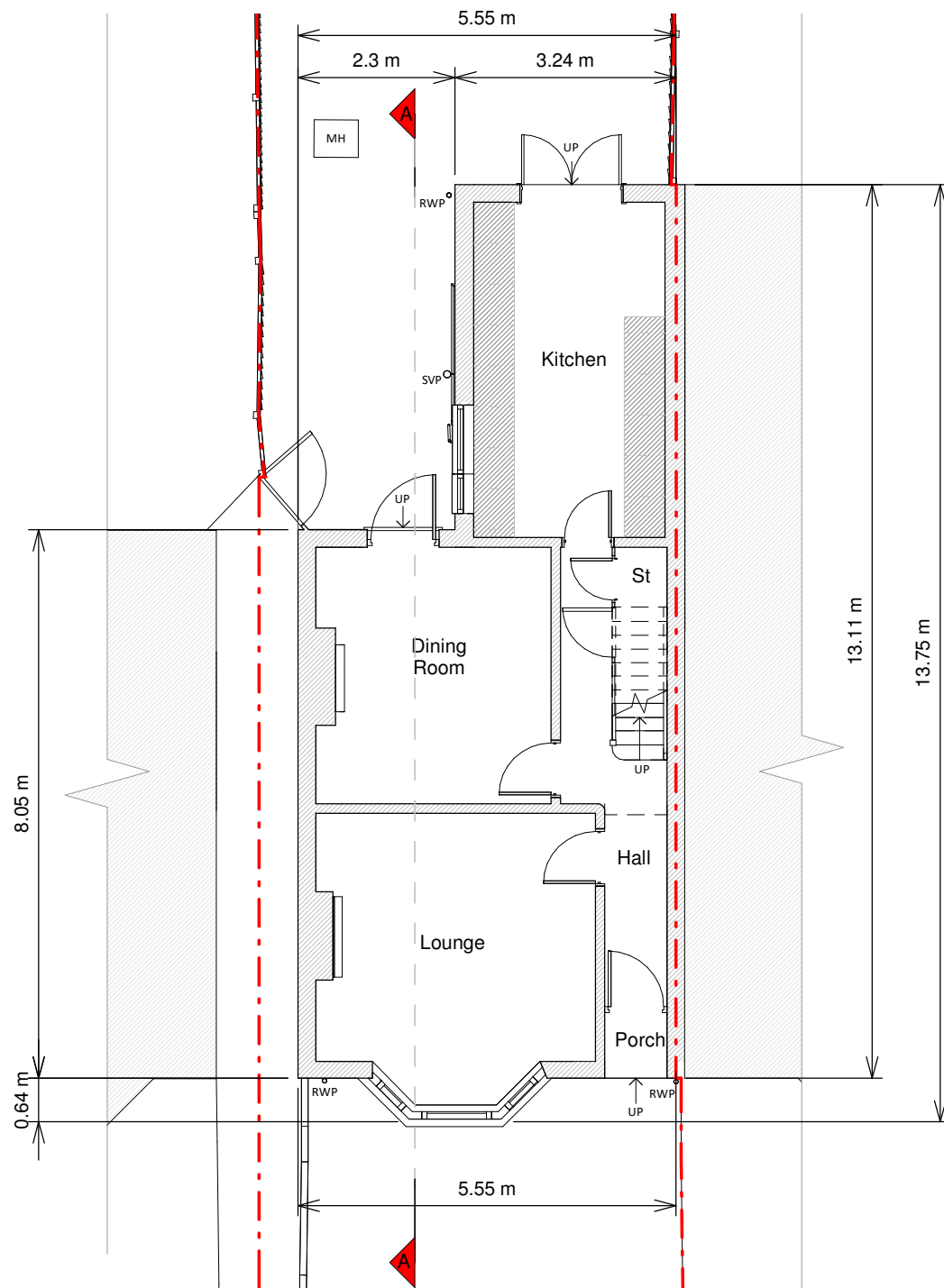

Ground Floor Plan

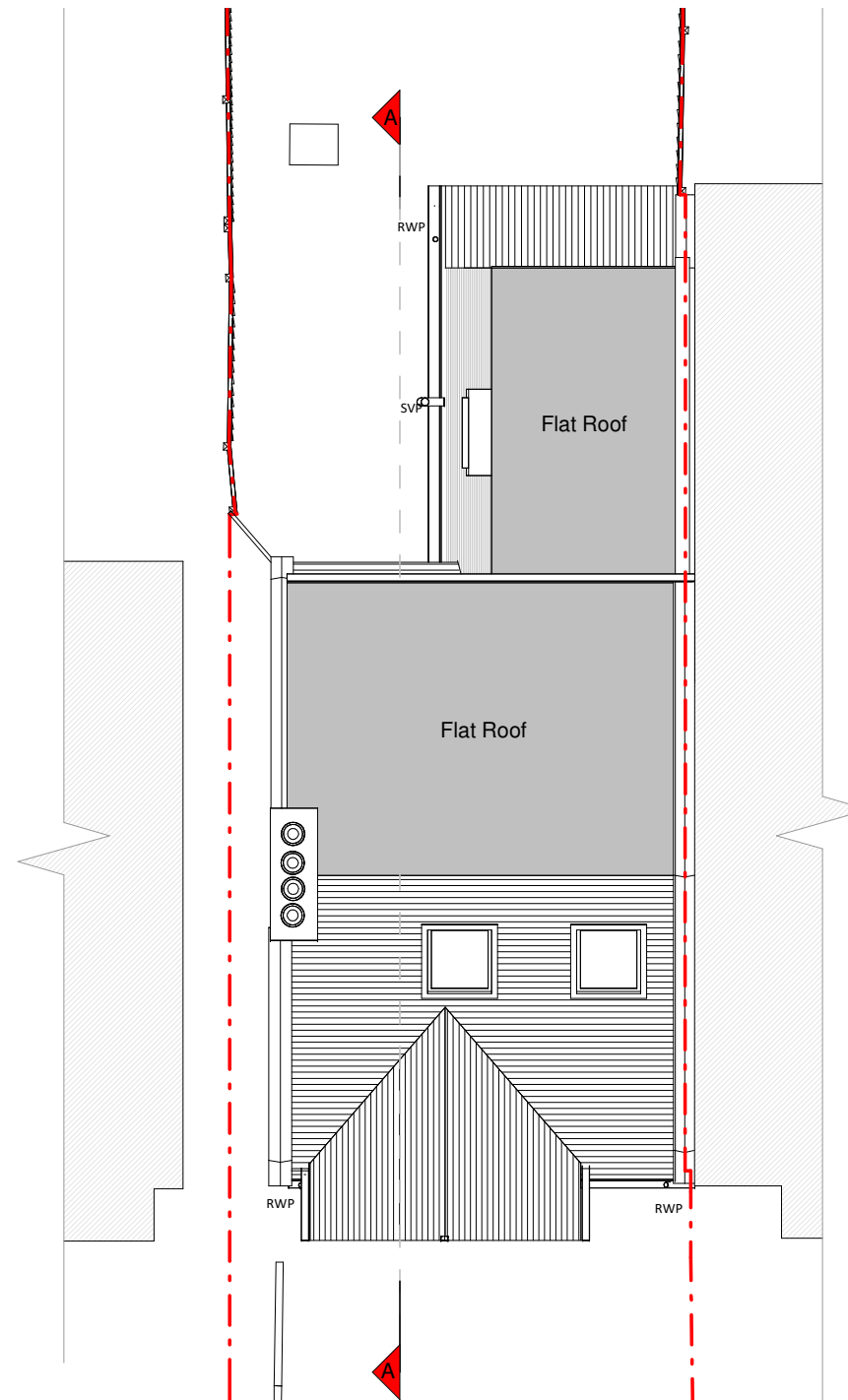

Roof Plan

