

206540.00 N

206530.00 N

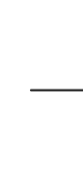
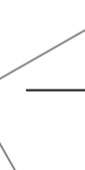
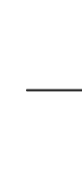
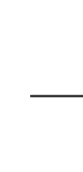
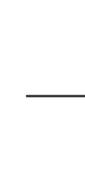
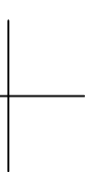

398270.00 E

398280.00 E

398290.00 E

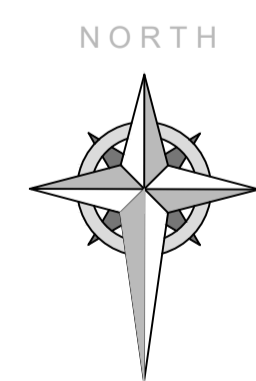
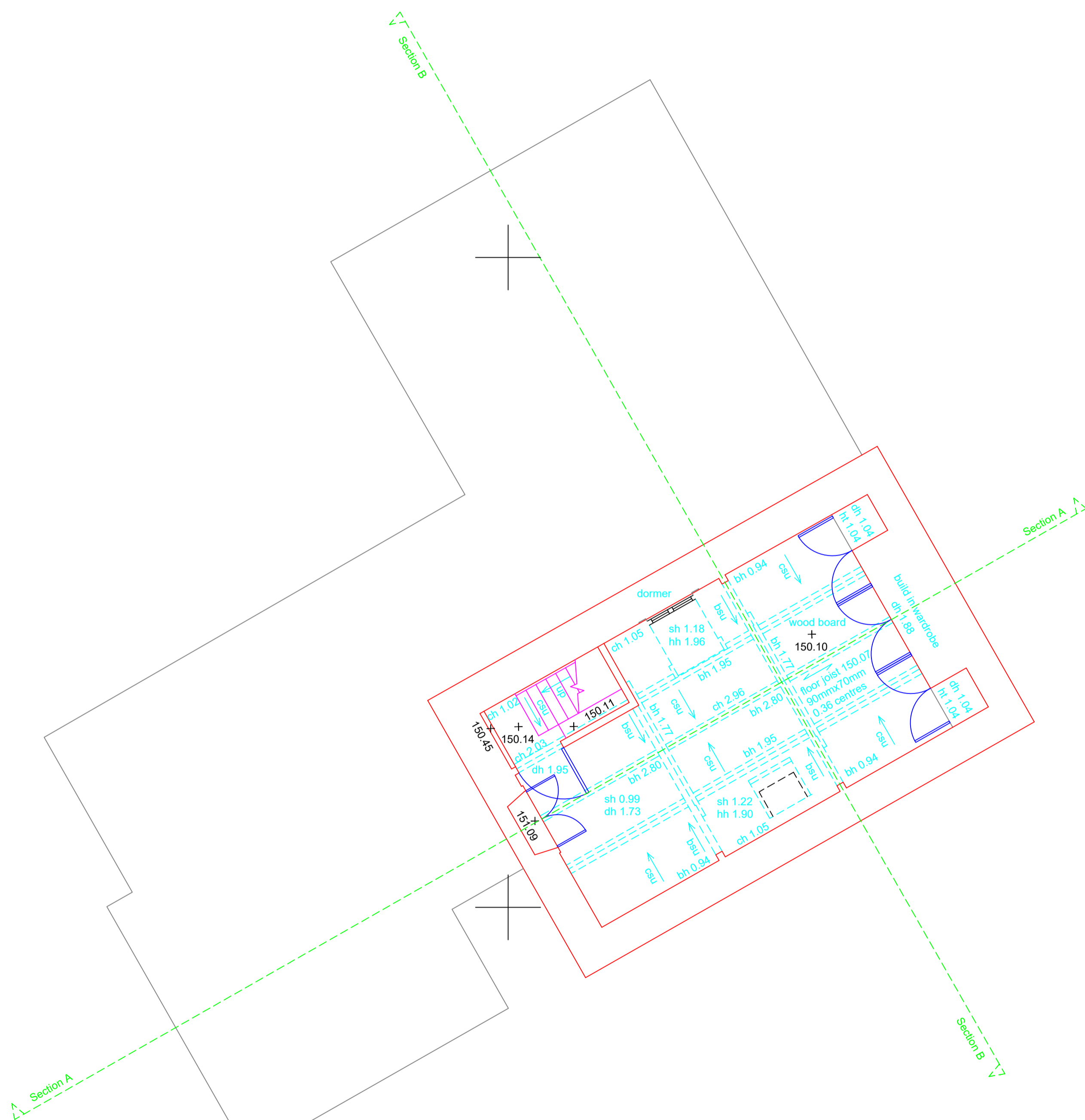

STANDARD REFERENCES

ABBREVIATIONS	
ah	apex height
bh	beam height
ch	ceiling height
cl	cover level
csu	ceiling slopes up
dh	door height
fch	false ceiling ht.
fl	floor level
hh	head height
ic	inspection cover
il	invert level
mh	manhole
rad	radiator
rwp	rainwater pipe
sh	sill height
sph	spring height
svp	soil vent pipe
utr	unable to raise
vhh	vent head height
vp	vent pipe
vsh	vent sill height

- Notes
1. This survey has been computed and drawn about the Ordnance Survey National Grid.
 2. All levels are in metres and relate to the Ordnance Survey active GPS stations.
 3. This survey was measured for a scale of 1:50, any subsequent enlargements should be verified on site.

Revisions



Clifton Surveys Ltd
 Topographical and Measured Building Surveyors
 1 Wellington Park
 Clifton
 Bristol
 BS8 2UR
 TEL: (0117) 9735898
 e-mail: info@cliftonsurveys.com
 web: www.cliftonsurveys.com

The copyright in the plans remain vested in Clifton Surveys Ltd who will grant an irrevocable licence for use by the client upon receipt of full payment. No liability for accuracy shall extend beyond the specified scale of graphical mapping. All services and critical dimensions should be field verified.

Surveyed **M Cornick** Date **January 2021**
 Drawn **R Proeva** Checked **February 2021**

Drawing Title
**Second Floor
 Foxbury Hill Farmhouse
 Middle Duntisbourne, Cirencester
 GL7 7AR**

Client
**SOTA DESIGN LTD
 Middle Littleton
 Evesham
 WR11 8AE**

Drawing No. **989/4647/4** Scale A1 @ **1:50**