

Section A - A

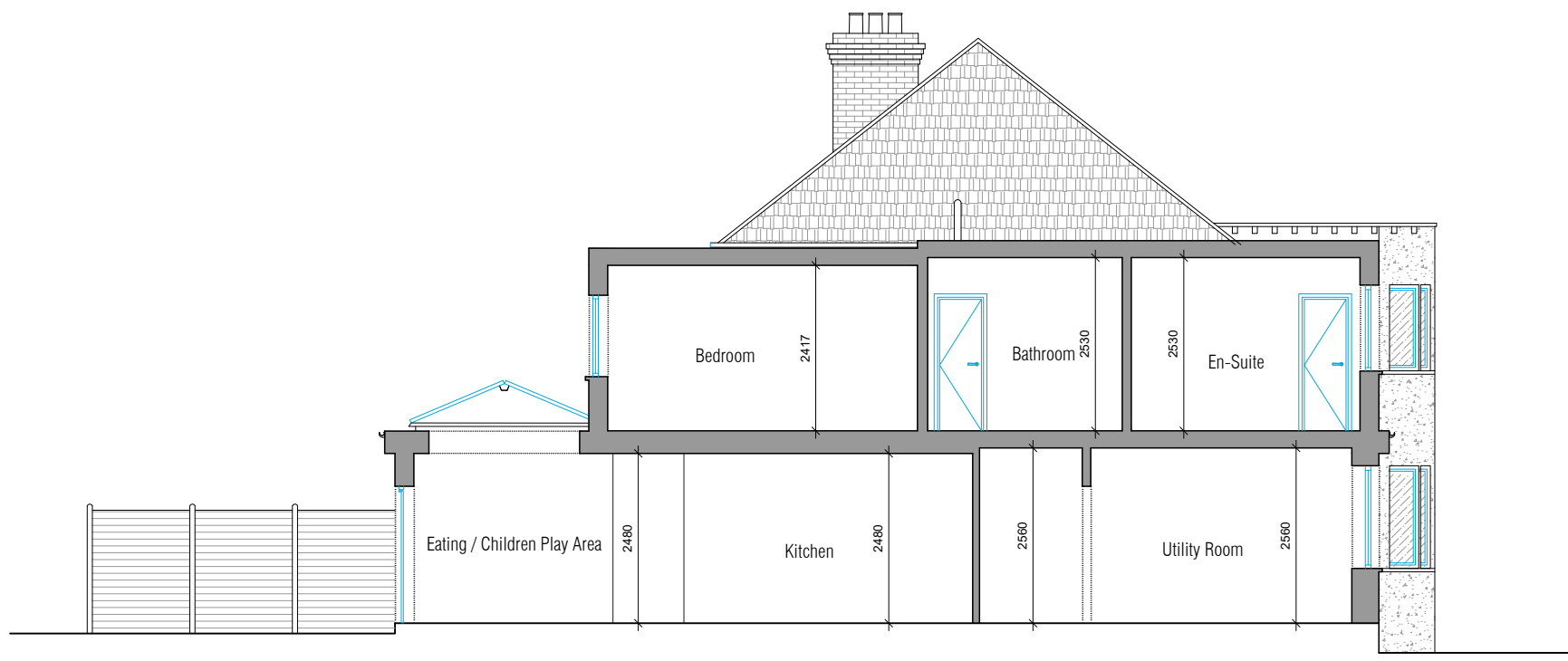

Section B - B

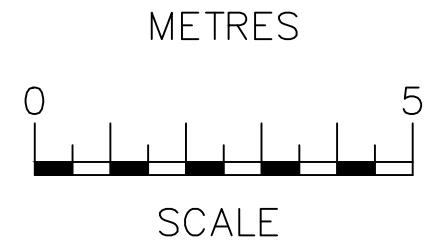

  
**OCC, Building A**  
 105 Eade Road  
 London, N4 1TJ  
 Tel: (020) 8150 1820  
 email: info@ajplans.co.uk  
 web: www.ajplans.co.uk

Project:  
**35 Green Walk**  
 London NW4 2AL

Title:  
 Proposed Sections

**NOTES**  
 The contractors are to check all the dimensions, levels, drain runs and general condition of the site before works commence.  
 All works are to be carried out in accordance with current Building Regulations, British Standards, Code of Practice and Local Authority Requirements.

Date: Nov. 2021      Scale: 1:100 @ A3

Dwg. No. GW.35.PRO.03      Rev: