

Issue Status			
Planning Application			
This drawing is copyright. Only figured dimensions to be worked to.			
Revision	Drawn	Check	Date

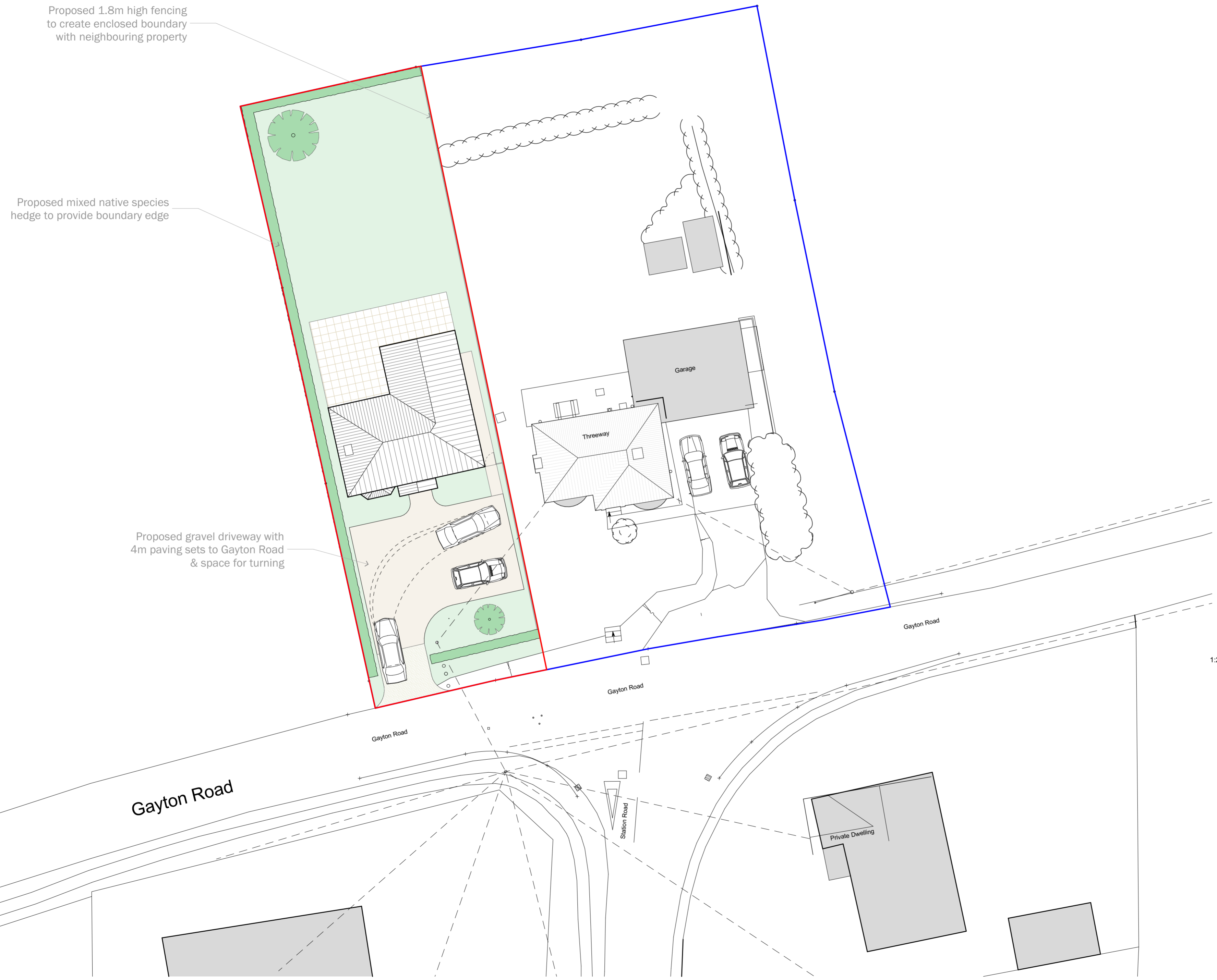

Proposed 1.8m high fencing to create enclosed boundary with neighbouring property

Proposed mixed native species hedge to provide boundary edge

Proposed gravel driveway with 4m paving sets to Gayton Road & space for turning

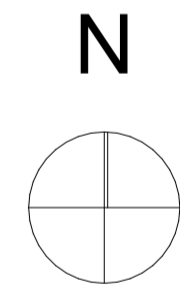

1:200
0 2 4 6 8 10 12 14 16m

client		
Ms G Burman		
project		
Land adjacent Threeways, Gayton Road, East Winch, King's Lynn		
drawing		
Proposed Site Plan		
date	scale	@ A2
Nov 21	1:200	
drawn	check	
JDA	IAN	

BROWN & CO
ARCHITECTURE + PLANNING
www.brown-co.com

Norwich 01603 629871 Brigg 01652 654833
 St Neots 01480 213611 Banbury 01295 273555

Brown & Co Registered Office: The Atrium, St. George's Street, Norwich, Norfolk, NR3 1AB.
 Registration no: OC302092. Registered in England & Wales.