

Existing door open increased in width to form kitchen dining space. No alterations to any other opening.

REAR ELEVATION DOWNTAKINGS

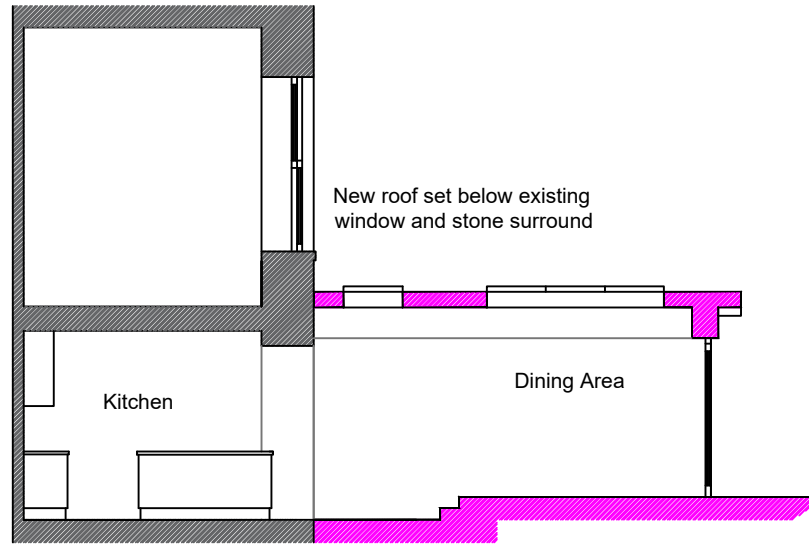

Existing floor level extends into extension then steps up into dining area.

SECTION

PLANNING APPLICATION

Revision Initials Date

KARA DESIGN

Kinmuir, 167 Mugdock Road, Milngavie, G62 8NB
karen.reid.architect@gmail.com

JOB TITLE

Alterations to 5 Lansdowne Crescent
for Carole Mooney & Guido De Groot

DRAWING TITLE

Proposed Downtakings
and Section

SCALE DATE DRAWING/CHECKED

1/100@A4 NOV21 KR

JOB NO. DRAWING NO. REVISION

699 GA05