

Revisions

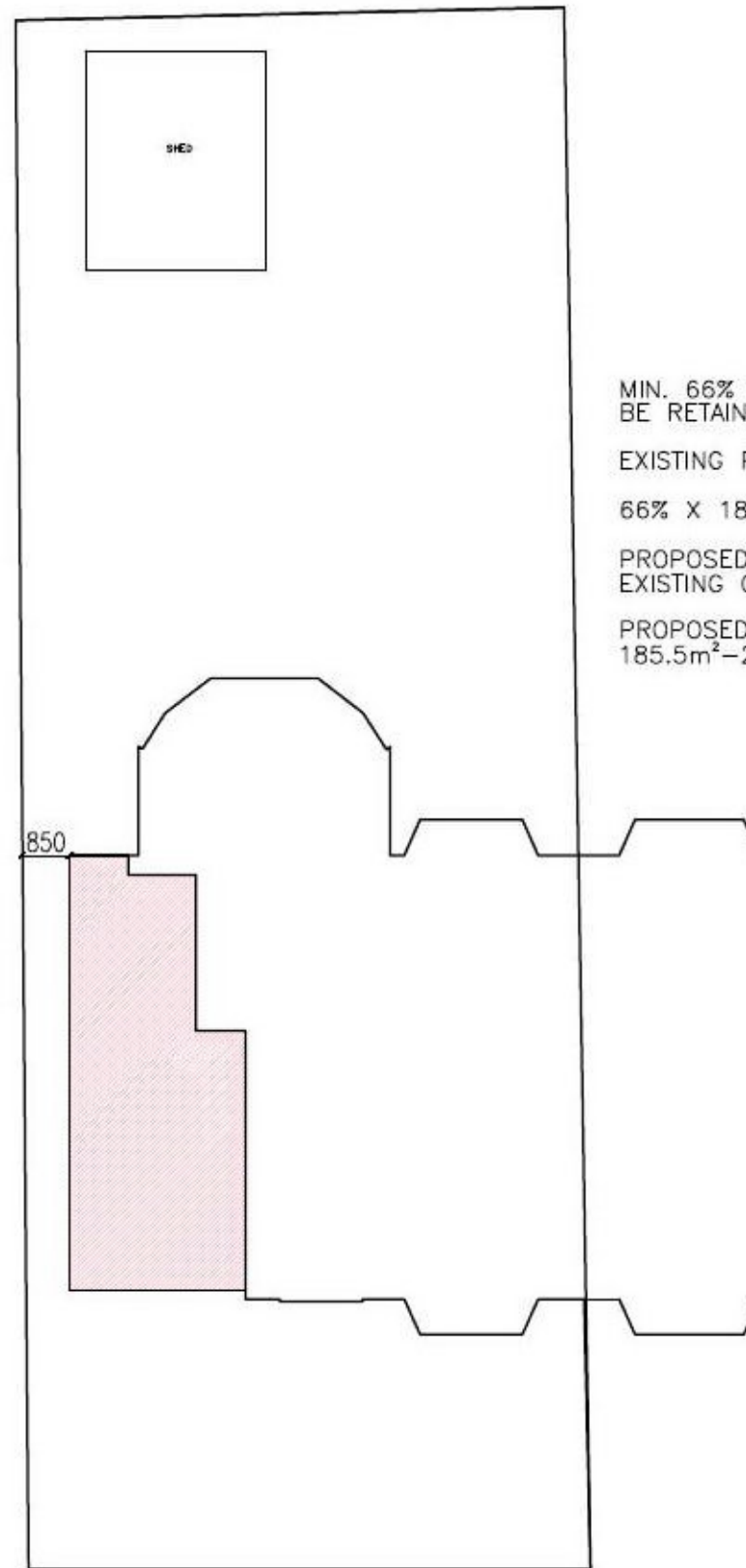
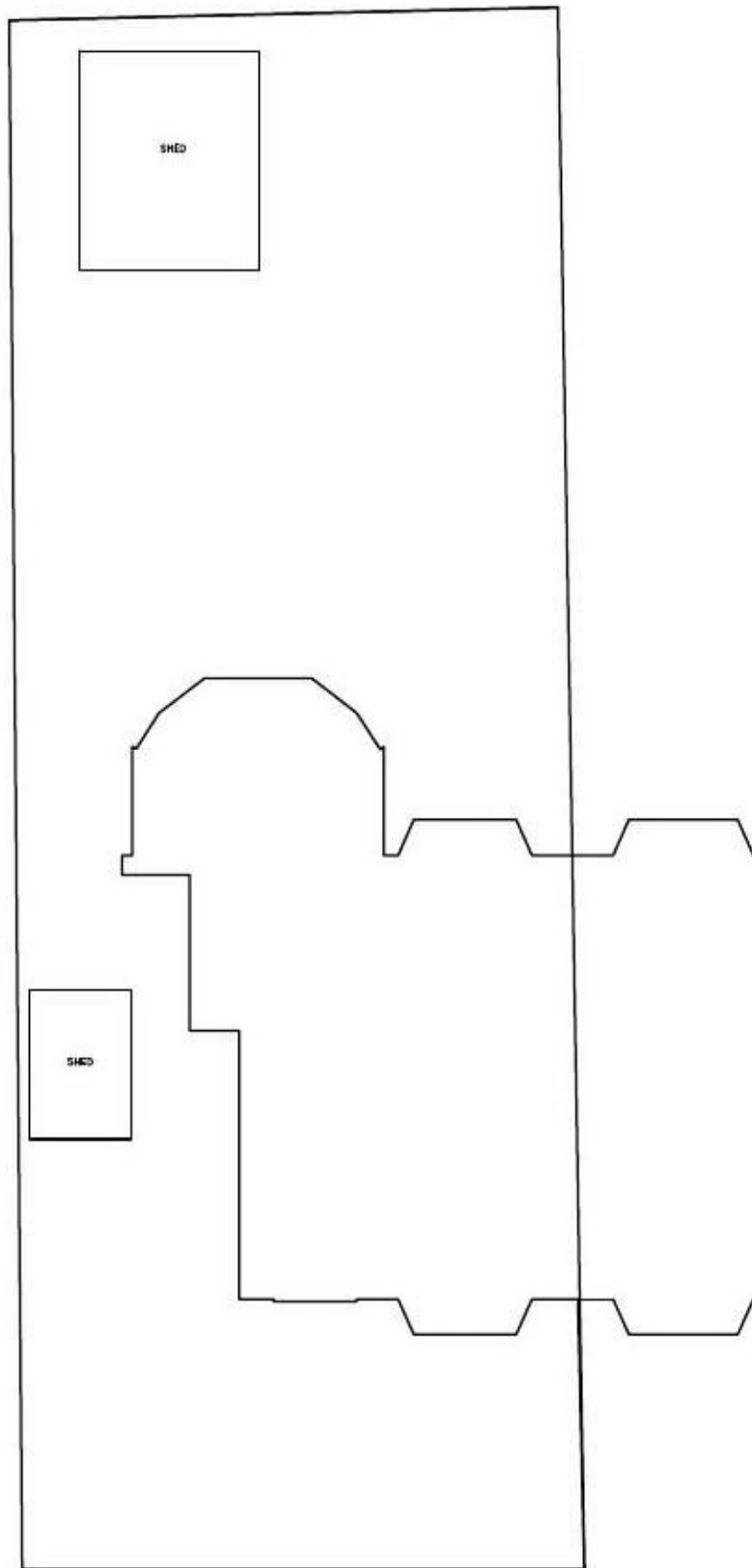

MIN. 66% OF ORIGINAL PRIVATE GARDEN SPACE TO BE RETAINED.

EXISTING PRIVATE GARDEN AREA = 185.5m<sup>2</sup>

66% X 185.5m<sup>2</sup> = 122.5m<sup>2</sup>

PROPOSED FOOTPRINT OF EXTENSION = 21.5m<sup>2</sup>

EXISTING CONSERVATORY = 13.5

PROPOSED PRIVATE GARDEN AREA =  
185.5m<sup>2</sup> - 21.5m<sup>2</sup> - 13.5m<sup>2</sup> = 150.5m<sup>2</sup>

LOCATION PLAN  
SCALE 1:200 @ A4

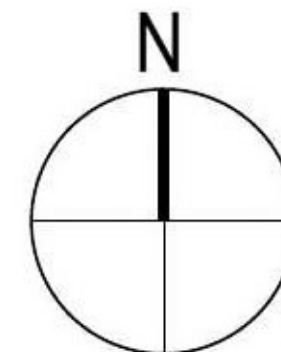
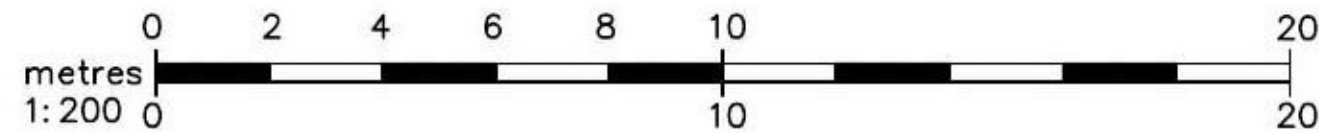

pocket size architecture



Drawing Category **PLANNING**

Project  
117 Balcarres Avenue

Drawing  
Location Plan

Scale 1:200 Size A4 Date Nov 2021

Job No. 2021-15 Drawing No. 102 By KC Rev