

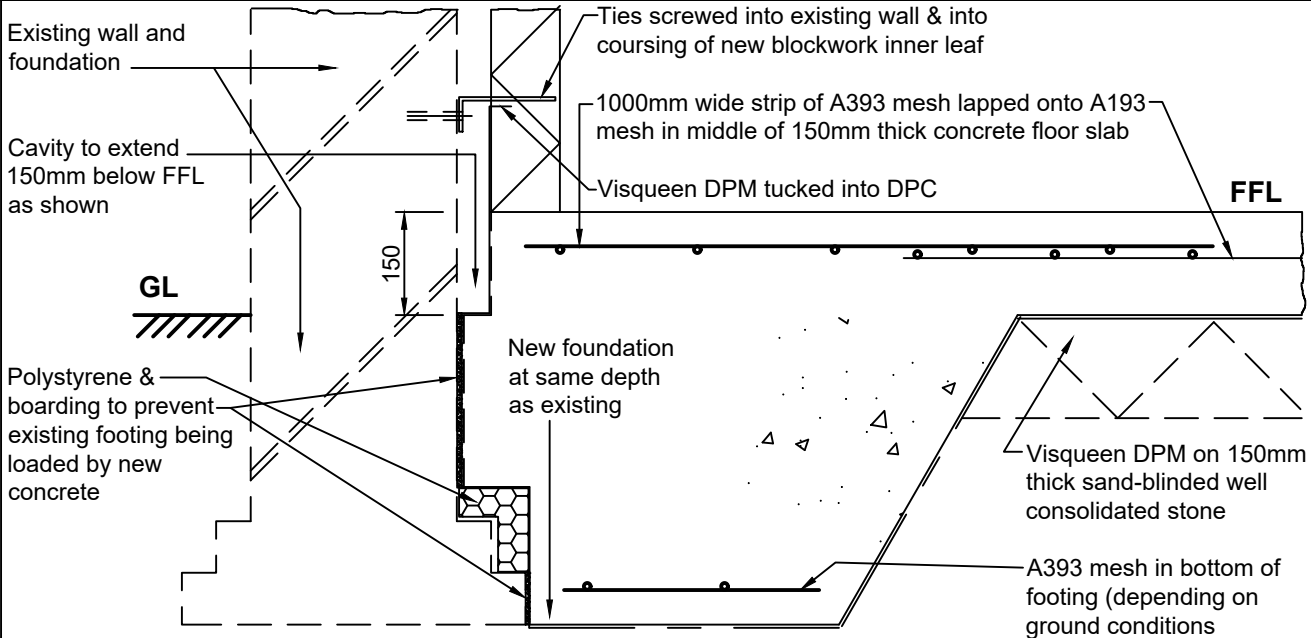

Prepared by <b>P A Hodson</b>	Date <b>May 2021</b>	
Checked by <b>PAH</b>	Project No. <b>210500</b>	Page No. <b>SK1</b>

Project

### INTERNAL WALL FOUNDATION DETAIL



### PROPOSED FOUNDATION FOR NEW INTERNAL LEAF

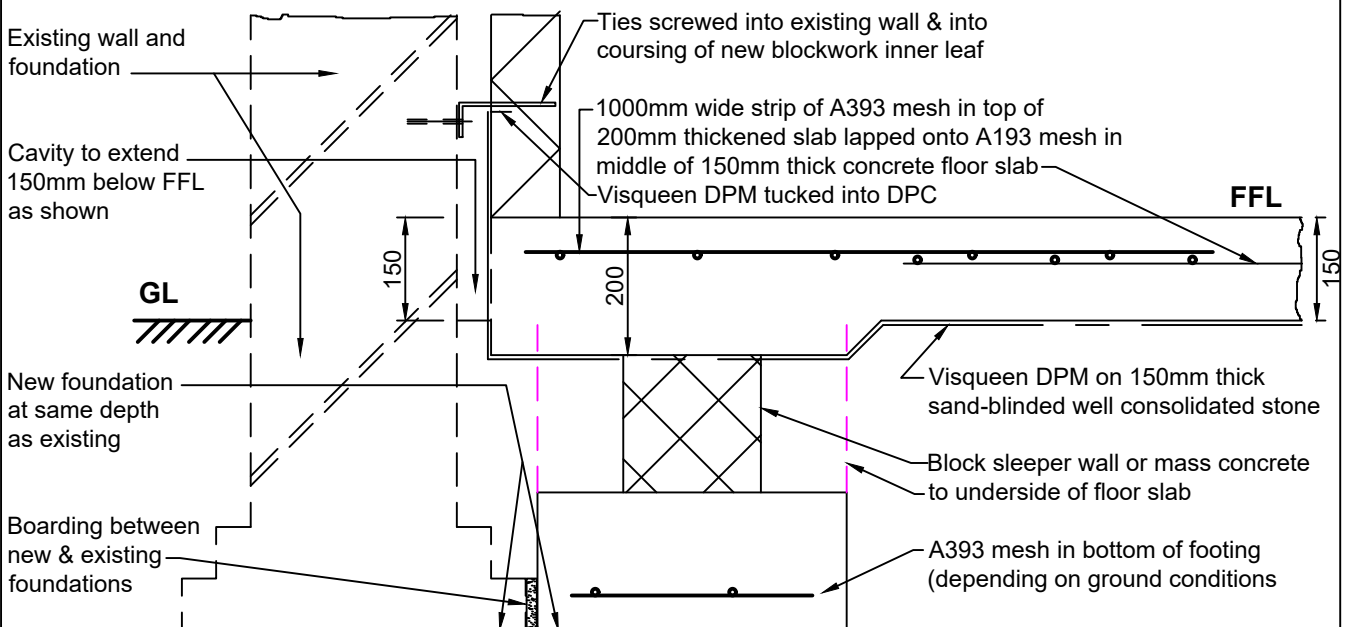

### ALTERNATIVE FOUNDATION FOR NEW INTERNAL LEAF

#### NOTES

- Concrete to be minimum grade C35.
- Mesh reinforcement to be in accordance with BS4483 and to have minimum laps of 450mm and minimum 50mm concrete cover to the top, sides, ends and bottom.
- All new foundations to be on ground with a minimum safe bearing capacity of 100kN/m<sup>2</sup> (1.0 ton/ft<sup>2</sup>) but this to be agreed with the Building Control Officer (LABCO) on site **before** any concrete is ordered.
- The structural information on this drawing supersedes that on the Architect's but refer to latter for DPM details etc and any details found on site which differ from those shown on this drawing to be notified to PAH and the Architect as soon as possible.
- All works to comply with the current British Standard, Code of Practice and Building Regulations and are also to be to the complete satisfaction of the Local Authority Building Control Officer.