

Likelihood of flooding in this area

This location is in an area with a low probability of flooding

FLOOD ZONE 1

Land and property in flood zone 1 have a low probability of flooding

[More information about flood zones](#)

- 1** You don't need to do a [flood risk assessment](#) if your development is in flood zone 1 and:
 - smaller than one hectare
 - is not affected by sources of flooding other than rivers and the sea, for example surface water drains
- 2** If your development is in flood zone 1 and:
 - larger than one hectare
 - is affected by sources of flooding other than rivers and the sea, for example surface water drains
 you can [learn more about flood risk assessments for planning applications](#)
- 3** You can also [read more about flood risk assessments for planning applications](#)

Environment Agency Flood Risk Map

Cornwall Council Interactive Map



Aerial View NTS



Front View of Existing Garage



View of Site Access



Rear View of Existing Garage



View of Existing Garden

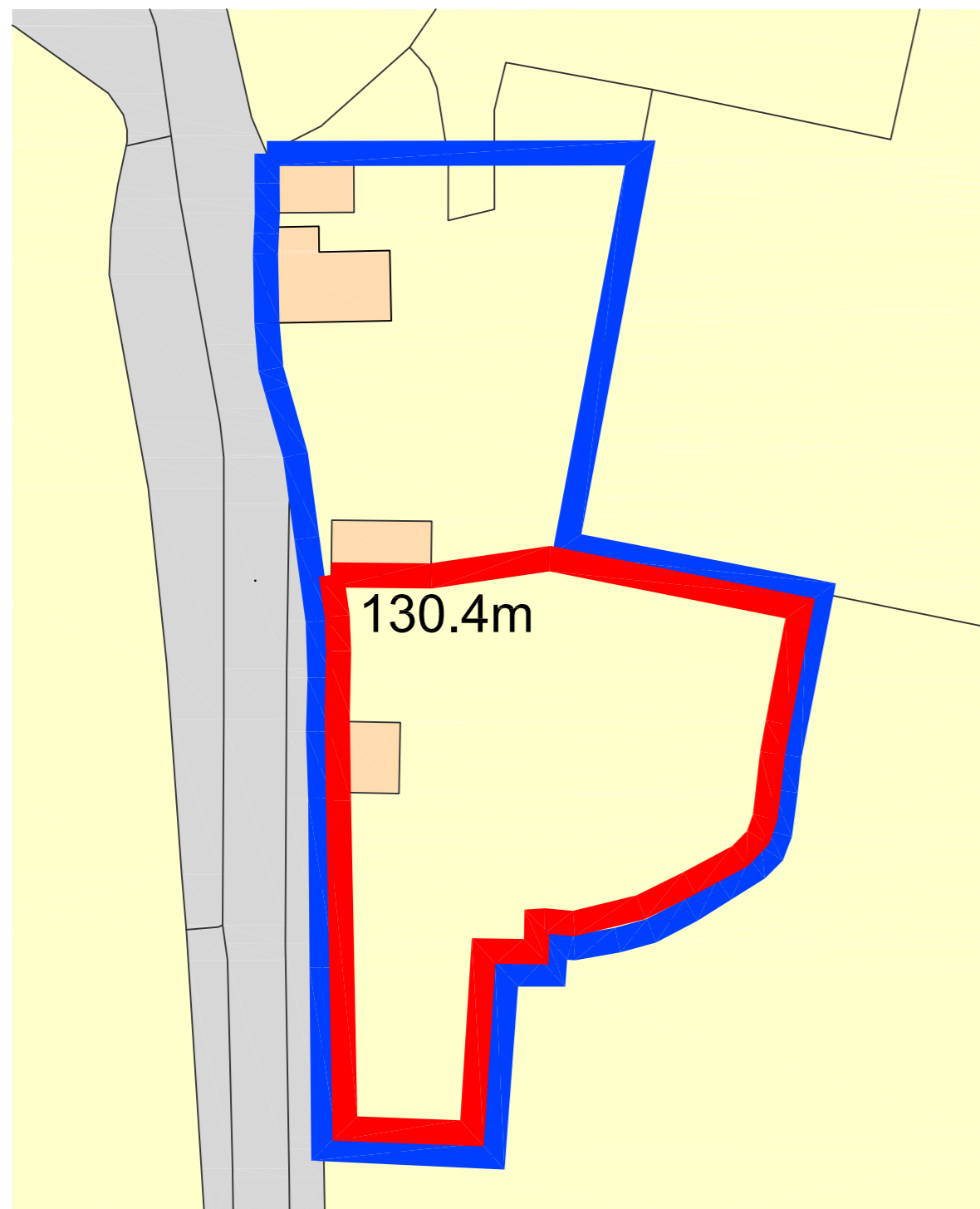

Block Plan 1:500

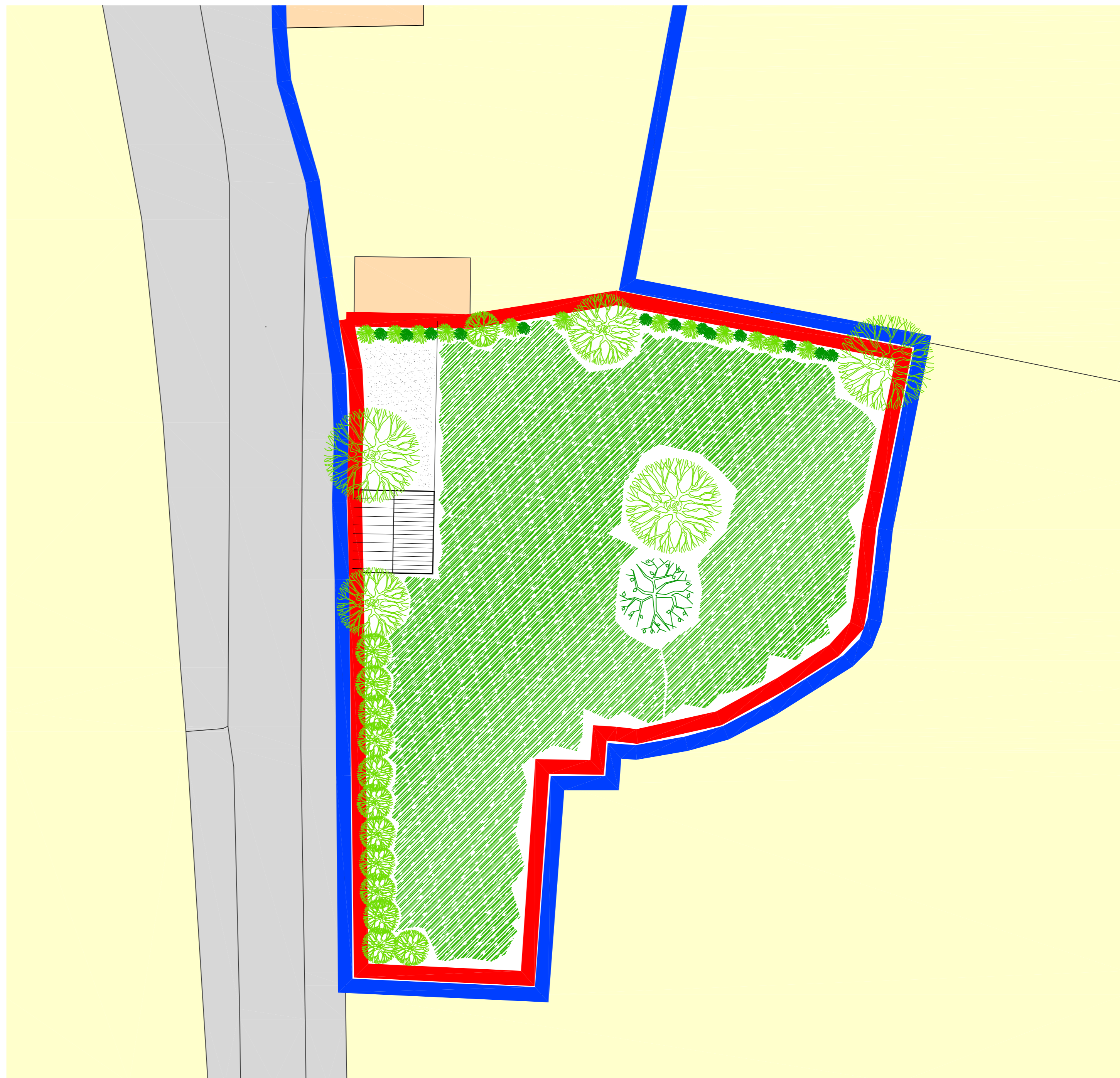

Existing Site Plan 1:200

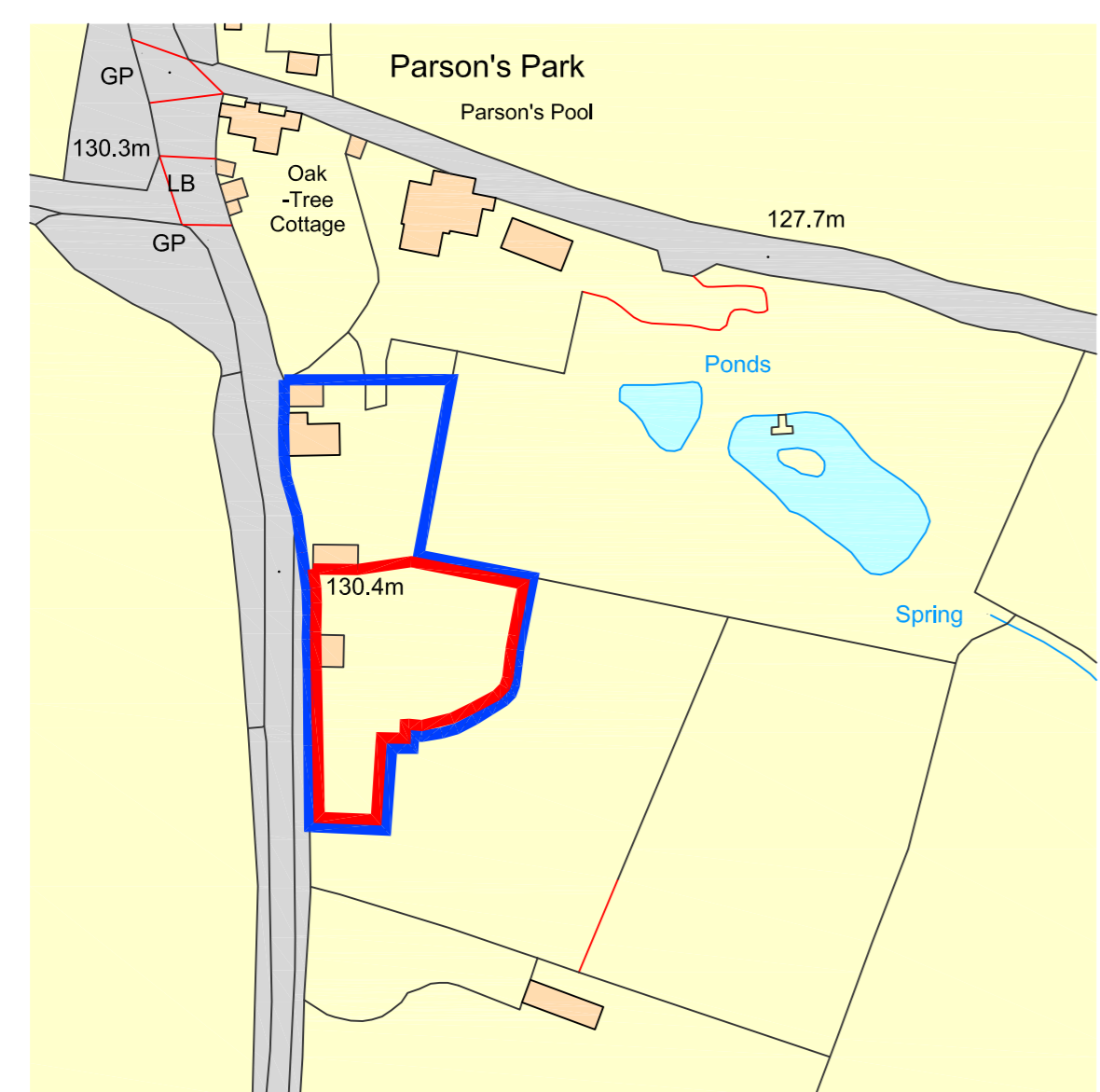

Location Plan 1:1250

Ordnance Survey, (c) Crown Copyright 2021. All rights reserved. Licence number 100022432

existing drawing

proposed dwelling, anskybar, quethock
 space design architecture ltd nov 2021 scale as annotated drawing size a1
 saltash, cornwall t. 01752 312129 e. mail@spacedesignarchitecture.co.uk w. www.spacedesignarchitecture.co.uk

